

# 2-Slot Charger

## Quick Reference Guide



**ZEBRA**

MN-004928-01EN Rev A



ZEBRA and the stylized Zebra head are trademarks of Zebra Technologies Corporation, registered in many jurisdictions worldwide. All other trademarks are the property of their respective owners. ©2024 Zebra Technologies Corporation and/or its affiliates. All rights reserved.

Information in this document is subject to change without notice. The software described in this document is furnished under a license agreement or nondisclosure agreement. The software may be used or copied only in accordance with the terms of those agreements.

For further information regarding legal and proprietary statements, please go to:

SOFTWARE: [zebra.com/linkoslegal](https://zebra.com/linkoslegal).

COPYRIGHTS: [zebra.com/copyright](https://zebra.com/copyright).

WARRANTY: [zebra.com/warranty](https://zebra.com/warranty).

END USER LICENSE AGREEMENT: [zebra.com/eula](https://zebra.com/eula).

## Terms of Use

### Proprietary Statement

This manual contains proprietary information of Zebra Technologies Corporation and its subsidiaries ("Zebra Technologies"). It is intended solely for the information and use of parties operating and maintaining the equipment described herein. Such proprietary information may not be used, reproduced, or disclosed to any other parties for any other purpose without the express, written permission of Zebra Technologies.

### Product Improvements

Continuous improvement of products is a policy of Zebra Technologies. All specifications and designs are subject to change without notice.

### Liability Disclaimer

Zebra Technologies takes steps to ensure that its published Engineering specifications and manuals are correct; however, errors do occur. Zebra Technologies reserves the right to correct any such errors and disclaims liability resulting therefrom.

### Limitation of Liability

In no event shall Zebra Technologies or anyone else involved in the creation, production, or delivery of the accompanying product (including hardware and software) be liable for any damages whatsoever (including, without limitation, consequential damages including loss of business profits, business interruption, or loss of business information) arising out of the use of, the results of use of, or inability to use such product, even if Zebra Technologies has been advised of the possibility of such damages. Some jurisdictions do not allow the exclusion or limitation of incidental or consequential damages, so the above limitation or exclusion may not apply to you.

## 2-Slot Charger Introduction

The CRD-RS2X-2SCGH-01 charges the RS2100 scanner. Place the charger on a tabletop or mount it on a vertical surface.

### Features

This section lists the features of the charger.

**Figure 1** Charger Features

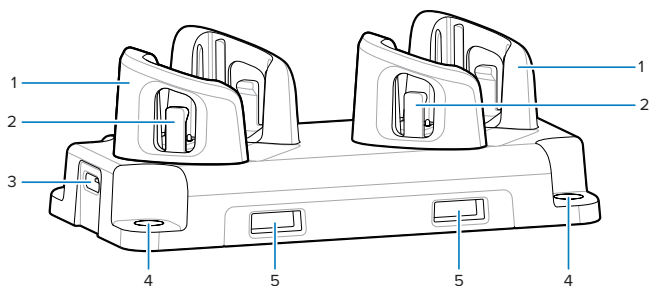

|   |                               |
|---|-------------------------------|
| 1 | Charging slot                 |
| 2 | Slot tabs                     |
| 3 | USB-C port                    |
| 4 | Mounting holes for screws     |
| 5 | Mounting holes for cable ties |

### Connecting the Charger

Connect the charger to a power source.

Connect the charger to a power supply with a USB port rated for at least 1 A using a USB-C to USB-A cable.

1. Connect the USB-A end of the cable to the power supply.
2. Connect the power supply to an outlet.
3. Connect the USB-C end of the cable to the port in the charger.

Zebra recommends using the AC Adapter (p/n PWR-WUA5V12W0XX), as illustrated here.

**Figure 2** Connecting the Charger

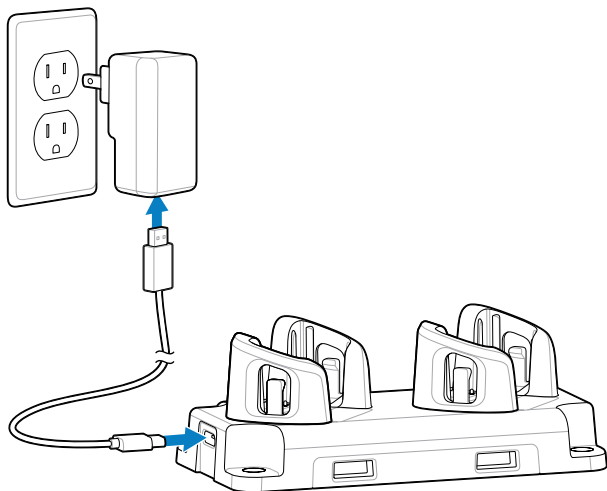

### Mounting

Place the charger on a tabletop or mount it on a vertical surface.

### Mounting the Charger with Screws

Mount the charger using screws to hold it in place.

Use four M5 screws at least 10 mm long.

1. Place the charger on the desired location.
2. Mark the surface through the four mounting holes to determine the location of the screw holes.
3. Pre-drill the holes to accommodate M5 screws.

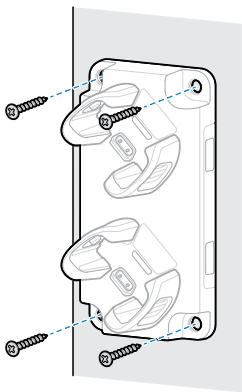

4. Attach the charger securely to the surface.

### Mounting the Charger with Cable Ties

Mount the charger using cable ties to hold it in place on a narrow surface, such as a pole.

Use two cable ties a maximum of 8 mm wide and 3 mm thick.



**NOTE:** Mount the charger no more than 2 m (6 ft 5 in.) above the floor.

1. Thread the cable ties through the cable tie slots on the charger.
2. Wrap the cable ties around the vertical object (for example, a pole).

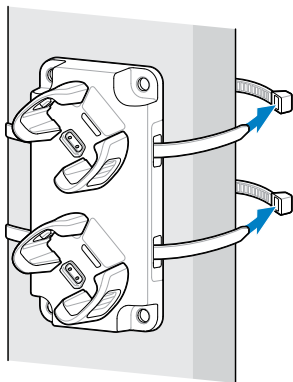

3. Tighten the cable ties, and trim off any excess tie length.

### Charging a Scanner

To charge the scanner, insert it into a charging slot.

1. Take the scanner out of the Slim Mount.

2. Position the scanner so that the charging contacts on the scanner align with the charging slot.

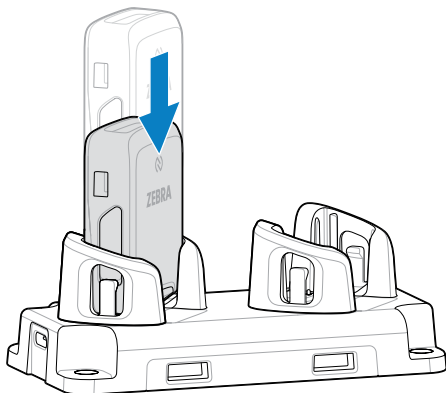

3. Insert the scanner into the charging slot.
4. Press firmly until the release tabs click into place.

The scanner beeps and the LED indicator illuminates to show the scanner's charging level.

### Scanner Charging Indicator

The scanner's LED indicates its charging status.

| Scanner LED Indicator | Indication                                     |
|-----------------------|--|
| Amber (solid)         | Charging<br>(current state of charge: 0 – 96%) |
| Green (solid)         | Charged<br>(current state of charge: 97%)      |
| Red (blinking)        | Over temperature or bad battery                |

### Regulatory Information

This device is approved under Zebra Technologies Corporation.

This guide applies to the following model number: CRD-RS2X-2SCHG-01

All Zebra devices are designed to be compliant with the rules and regulations in the locations they are sold and will be labeled as required.

Local language translation / (BG) Превод на местен език / (CZ) Překlad do místního jazyka / (DE) Übersetzung in die Landessprache / (EL) Μετάφραση τοπικής γλώσσας / (ES) Traducción de idiomas locales / (ET) Kohaliku keele tõlge / (FI) Paikallinen käännös / (FR) Traduction en langue locale / (HR) Prijevod na lokalni jezik / (HU) Helyi nyelvé fordítás / (IT) Traduzione in lingua locale / (JA) 現地語翻訳 / (KR) 현지 언어 번역 / (LT) Vietinės kalbos vertimas / (LV) Tulkojums vietējā valodā / (NL) Vertaling in lokale taal / (PL) Tłumaczenie na język lokalny / (PT) Tradução do idioma local / (RO) Traducere în limba locală / (RU) Перевод на местный язык / (SK) Preklad do miestneho jazyka / (SL) Prevajanje v lokalni jezik / (SR) Превод на локални језик / (SV) Översättning av lokalt språk / (TR) Yerel dil çevirisi / (ZH-CN) 当地语言翻译 / (ZH-TW) 當地語言翻譯 [zebra.com/support](http://zebra.com/support)

Any changes or modifications to Zebra equipment not expressly approved by Zebra could void the user's authority to operate the equipment.

Declared maximum operating temperature: 40°C

For use only with Zebra approved and UL Listed mobile devices, Zebra approved, and UL Listed/Recognized battery packs.

### Regulatory Markings

Regulatory markings subject to certification are applied to the device. Refer to the Declaration of Conformity (DoC) for details of other country markings. The Doc is available at: [zebra.com/doc](http://zebra.com/doc).

### Power Supply



**WARNING: ELECTRICAL SHOCK** Use only a Zebra approved, Certified ITE SELV power supply with appropriate electrical ratings. Use of alternative power supply will invalidate any approvals given to this unit and may be dangerous.

# **Marking and European Economic Area (EEA)**

### **Statement of Compliance**

Zebra hereby declares that this device is in compliance with Directives 2014/30/EU, 2014/35/EU, and 2011/65/EU.

The full text of the EU Declaration of Conformities is available at: [zebra.com/doc](http://zebra.com/doc).

EU Importer : Zebra Technologies B.V

Address: Mercurius 12, 8448 GX Heerenveen, Netherlands

### **Environmental Compliance**

For compliance declarations, recycling information, and materials used for products and packaging, please visit [zebra.com/environment](http://zebra.com/environment).

### **Waste Electrical and Electronic Equipment (WEEE)**

For EU and UK Customers: For products at the end of their life, please refer to recycling/disposal advice at [zebra.com/weee](http://zebra.com/weee).

## **United States and Canada Regulatory**

### **Radio Frequency Interference Notices**

This device complies with Part 15 of the FCC Rules. Operation is subject to the following two conditions: (1) this device may not cause harmful interference, and (2) this device must accept any interference received including interference that may cause undesired operation.



**NOTE:** This equipment has been tested and found to comply with the limits for a Class B digital device, pursuant to Part 15 of the FCC rules. These limits are designed to provide reasonable protection against harmful interference in a residential installation. This equipment generates, uses and can radiate radio frequency energy and, if not installed and used in accordance with the instructions, may cause harmful interference to radio communications. However, there is no guarantee that interference will not occur in a particular installation. If this equipment does cause harmful interference to radio or television reception, which

can be determined by turning the equipment off and on, the user is encouraged to try to correct the interference by one or more of the following measures:

- Reorient or relocate the receiving antenna.
- Increase the separation between the equipment and receiver.
- Connect the equipment into an outlet on a circuit different from that to which the receiver is connected.
- Consult the dealer or an experienced radio/TV technician for help.

### **Radio Frequency Interference Requirements – Canada**

Innovation, Science and Economic Development Canada ICES-003  
Compliance Label: CAN ICES-003 (B)/NMB-003(B)

### **Türkiye TÜRK WEEE Uyumluluk Beyanı**

Bu cihaz Türkçe karakterlerin tamamını ihtiva eden ETSI TS 123.038 V8.0.0 (veya sonraki sürümün kodu) ve ETSI TS 123.040 V8.1.0 (veya sonraki sürümün kodu) teknik özelliklerine uygundur.

EEE Yönetmeliğine Uygundur.



#### **Statement of Compliance**

Zebra hereby declares that this device is in compliance with Electromagnetic Compatibility Regulations 2016, the Electrical Equipment (Safety) Regulations 2016 and the Restriction of the Use of Certain Hazardous Substances in Electrical and Electronic Equipment Regulations 2012.

The full text of the UK Declaration of Conformities is available at:  
[zebra.com/doc](http://zebra.com/doc).

UK Importer: Zebra Technologies Europe Limited

Address: Dukes Meadow, Millboard Rd, Bourne End, Buckinghamshire, SL8 5XF

### Warranty

For the complete Zebra hardware product warranty statement, go to: [zebra.com/warranty](http://zebra.com/warranty).

### Service Information

Before you use the unit, it must be configured to operate in your facility's network and run your applications.

If you have a problem running your unit or using your equipment, contact your facility's Technical or System Support. If there is a problem with the equipment, they will contact Zebra support at [zebra.com/support](http://zebra.com/support).

For the latest version of the guide go to: [zebra.com/support](http://zebra.com/support).

### Software Support

Zebra wants to ensure that customers have the latest entitled software at the time of device purchase in order to keep the device operating at peak performance levels. To confirm that your Zebra device has the latest entitled software available at the time of purchase, go to [zebra.com/support](http://zebra.com/support).

Check for the latest software from **Support > Products**, or search for the device and select **Support > Software Downloads**.

If your device does not have the latest entitled software as of your device purchase date, e-mail Zebra at [entitlementservices@zebra.com](mailto:entitlementservices@zebra.com) and ensure you include the following essential device information:

- Model number
- Serial number
- Proof of purchase
- Title of the software download you are requesting.

If it is determined by Zebra that your device is entitled to the latest version of software, as of the date you purchased your device, you will receive an

e-mail containing a link directing you to a Zebra Web site to download the appropriate software.

### Product Support Information

- For information on using this product, see the User Guide at [zebra.com/rs2100](http://zebra.com/rs2100).
- To find quick answers to known product behaviors, access our knowledge articles at [supportcommunity.zebra.com/s/knowledge-base](http://supportcommunity.zebra.com/s/knowledge-base).
- Ask your questions in our Support community at [supportcommunity.zebra.com](http://supportcommunity.zebra.com).
- Download product manuals, drivers, software, and view how-to videos at [zebra.com/support](http://zebra.com/support).
- To request a repair for your product, go to [zebra.com/repair](http://zebra.com/repair).

### Patent Information

To view Zebra patents, go to [ip.zebra.com](http://ip.zebra.com).

