



Welcome to
the breezy life.

The Windmill AC
Lite Series: 5K BTU
User Manual & Install Guide



We take care of your air.

We started Windmill to help you feel more comfortable at home. We're a family-run small business based in New York, and your support means the world!

Any questions or issues? We'll get you squared away.

windmillair.com/support
support@windmillair.com

Thanks for trusting Windmill,
Mike & Team

Loving Windmill?

We make other high-design, high-performance home air products.

Go to **windmillair.com** to shop and learn more.

Follow us **[@windmillair](https://www.instagram.com/windmillair)** on Instagram for exclusive discounts and announcements!

Table of contents



1	Safety first	4
2	Window requirements	10
3	What's in the box?	11
4	Installation & assembly instructions	12
5	Using your air conditioner	20
6	Care and cleaning	23

Safety first

IT'S REALLY IMPORTANT YOU READ THESE WARNINGS AND THIS ENTIRE GUIDE BEFORE YOU GET STARTED. AND PLEASE FOLLOW EACH STEP EXACTLY AS IT'S OUTLINED. SAVE THIS GUIDE FOR FUTURE REFERENCE.



This is a safety alert symbol. This symbol alerts you to potential hazards that can harm you or others or even cause death. All safety messages will directly follow the safety alert symbol and/or the words “DANGER” or “WARNING”.



DANGER

Failure to immediately follow these instructions may cause serious injury or even death.



WARNING

All safety messages alert you of potential hazards, how to reduce the chance of injury, and what can happen if instructions are not followed correctly.



WARNING

To reduce the risk of fire, electrical shock or injury when using your air conditioner, follow the basic precautions below:

- Plug into a grounded 3 prong outlet.
- Do not remove the ground prong.
- Do not use a plug adapter.
- Do not use an extension cord.
- Unplug the air conditioner before servicing.
- Use two or more people to move and install the air conditioner.

About R32 refrigerant

This air conditioner uses R32 refrigerant. Compared to traditional refrigerants, R32 has a minimal impact on the ozone layer and a significantly lower greenhouse effect, making it a responsible option for cooling your space.

R32 is both odorless and combustible, which means it requires careful handling. Under certain conditions, it can pose a fire or explosion risk; however, when installed in an appropriately sized room and used according to the guidelines provided, it is completely safe.



- Please read the entire manual before installation, operation, and maintenance.
- Do not accelerate the defrosting process.
- Only clean the appliance as specified in this manual.
- The appliance should not be stored in a room with operating heat or fire sources (for example: open flames, an operating ignition gas appliance, or an operating electric heater).
- This appliance must be maintained by a professional, at their own risk and liability. Do not perform maintenance or try to fix this appliance yourself. Contact the manufacturer for maintenance or troubleshooting.
- The handling, installation, storage, servicing, and disposal of this appliance must comply with the provisions of gas-related national laws and regulations, in addition to national wiring regulation. A leak test must be performed after completing installation.
- It is necessary to clear away the refrigerant in the system when maintaining or scrapping an air conditioner. Be aware that refrigerants may not contain an odor. This is to be done by a professional only.
- Unit operation limits: Outdoor side 61~110°F, 80% relative humidity; Indoor side 61~90°F, 80% relative humidity.
- Site safety during installation, removal, and maintenance: open flames prohibited, ventilation necessary, no static electricity, protective clothing and gloves worn, no mobile phone usage.

This appliance is not intended for use by individuals (including children) with reduced physical, sensory, or mental capabilities, unless they are under supervision or have received instructions from a person responsible for their safety. Children should be supervised to ensure they do not play with the appliance.

Wiring requirements



WARNING

Failure to follow these instructions can result in death, fire, or electrical shock.

- Only plug into a grounded 3 prong outlet. Do not remove the ground prong.
- Do not use an adapter.
- Do not use an extension cord.

The electrical ratings for your AC are listed on the product. Please reference the chart below. If you have any questions or need clarification, contact Windmill Support at support@windmillair.com.

Wiring Requirements

- 115 volt (103min–127max)
- 0-8 amps
- 10-amp time-delay fuse or circuit breaker
- Use on single outlet circuit only

Power Supply Cord



Important information on grounding your air conditioner:

To minimize the possibility of electrical shock, the cord must be plugged into a 3 prong outlet and grounded in accordance with all local codes and ordinances. If a 3 prong outlet is not available or there is doubt on the installation environment, it is your responsibility to contact a qualified electrician and to assure that the electrical installation is adequate and in conformance with the National Electrical Code, ANSI/NFPA 70-latest edition, and all local codes and ordinances.

LCDI power cord and plug:

This air conditioner is equipped with an LCDI (Leakage Current Detection and Interruption) power cord and plug, as required by US National Electric Code 440.65. This cord consists of a length of shielded flexible cord with no termination on the load side and a LCDI attachment plug on the line side. The LCDI power cord and plug will remove the supply source via electrical disconnect (circuit trip) if the nominal current leakage between the cord shield and either load conductor exceeds a predetermined value. The cord will remain deenergized until the device has been manually reset. This is intended to reduce the risk of a fire in the power cord or combustible materials nearby. The cord shields are not grounded and they must be considered a shock hazard if exposed. The cord shield must not be connected to ground or to any exposed metal. The test and reset buttons on the LCDI plug are used to check if the plug is functioning properly.

To test the plug:

- 1 Plug the power cord into a grounded wall outlet.
- 2 Press the TEST button. The circuit should trip, cutting all power to the air conditioner (on some units, a green light may turn off).
- 3 Press the RESET button to restore power (on some units, a green light may turn on).

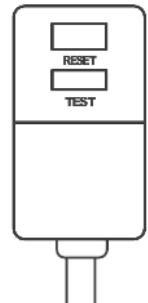

Follow the instructions of the plug. If a test fails, do not use the air conditioner or attempt to reset the LCDI plug. **Contact [windmillair.com/support](https://www.windmillair.com/support) for help.**

General installation warnings and cautions:

- 1 Follow all warnings and safety instructions.
- 2 To avoid risk of personal injury, property damage, and product damage, pay close attention to the following during installation:
 - The AC could fall if it is not properly installed, which could result in death or serious injury. Pay close attention to all steps to ensure you properly position and secure the AC in the window.
 - The AC is heavy. Two or more people are needed to move and install the unit. We don't want you hurting yourself, so please use proper carrying and lifting techniques (as they say, lift with your legs, not your back!).
 - Do not touch the metal fins or the front and rear coils - they're sharp. Wear protective gloves whenever lifting or carrying the unit and handle the AC with care.
 - Carefully inspect the window where you are installing your AC unit. Make sure it is in good condition and can support the weight of the unit over a long period of time.
 - To make sure the AC doesn't fall out of the window during installation, use a helper to securely hold the back of the unit up while positioning it properly in the window.
- 3 Use only the screws that are specified in this guide.
- 4 To avoid injury, wear closed toe shoes and do not wear loose clothing that could get tangled in the unit during installation.
- 5 The installation site should be well ventilated and free from any fire, welding, smoke, or any heat source that can produce an open fire. Make sure there is no electrical static and wear anti-static clothes and gloves. Make sure nothing is blocking the front of the AC (outlet and inlet areas).
- 6 Avoid placing the AC near power strips, electrical outlets, or other high-powered appliances to prevent circuit overload, overheating, and electrical hazards. Make sure there are no valuables directly under the area the AC will be installed.

Federal Communications Commission (FCC) interference statement

This equipment has been tested and found to comply with the limits for a Class B digital device, pursuant to part 15 of the FCC Rules. These limits are designed to provide reasonable protection against harmful interference in a residential environment. This equipment generates, uses, and can radiate radio frequency energy and, if not installed and used in accordance with the instructions, may cause harmful interference to radio communications. However, there is no guarantee that interference will not occur in a particular installation. If this equipment does cause harmful interference to radio or television reception, which can be determined by tuning the device off and on, the user is encouraged to try to correct the interference by one or more of the following measures:

- Reorient or relocate the receiving antenna.
- Increase the separation between the device and receiver.
- Connect the equipment into an outlet other than the one used for the receiver.
- Consult the dealer or an experienced radio/TV technician for assistance.

This device complies with Part 15 of the FCC Rules. Operation is subject to the following two conditions:
(1) This device may not cause harmful interference, and
(2) This device must accept any interference received, including interference that may cause undesired operation.

FCC caution:

Any changes or modifications not expressly approved by the party responsible for compliance could void the user's authority to operate the equipment.

Host device labeling:

This device includes the following module.
Contains FCC ID: 2AC7Z-ESP32WROOM32E

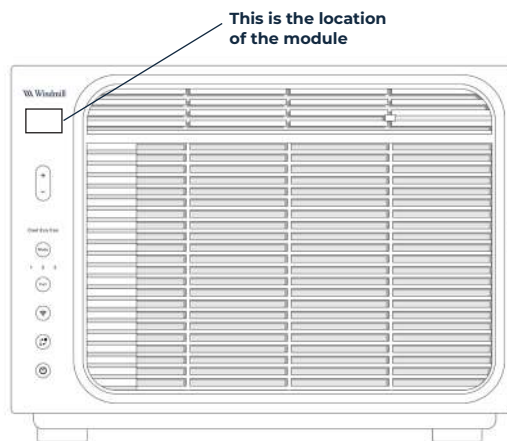

RF exposure statement:

This equipment complies with FCC radiation exposure limits set forth for an uncontrolled environment. This equipment should be installed and operated with minimum 20 cm between the radiator and your body. This transmitter must not be co-located or operated in conjunction with any other antenna or transmitter unless authorized to do so by the FCC.

Window requirements

The 5K BTU Windmill AC (Lite Series) is designed for windows that slide up and down (double-hung and single-hung windows) with a width of **23-34 inches** and a vertical opening of at least **14.5 inches**.

Make sure your window is in good shape and can handle the weight of the AC for a long period of time. You'll also want to make sure there is at least 2 feet of clearance on all sides of your AC (including the front and back). This helps ensure walls and other objects don't block airflow.

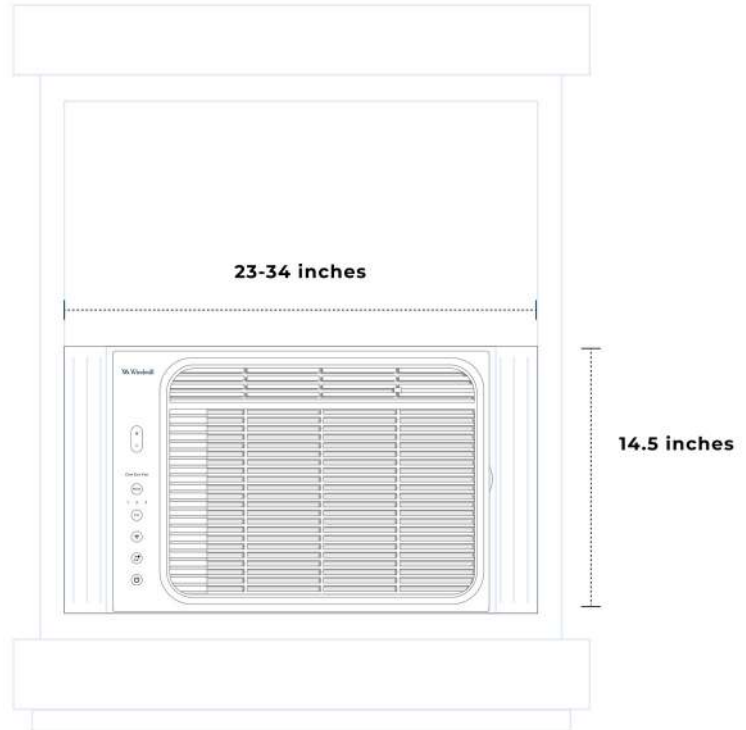

What's in the box?

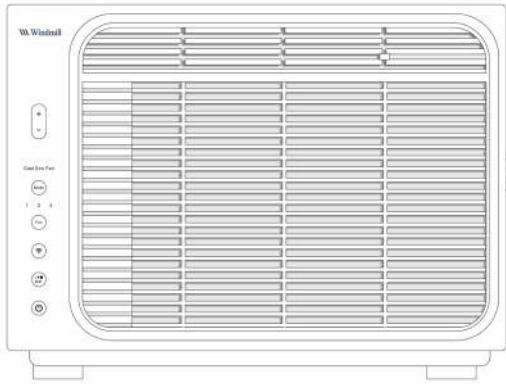

Window Air Conditioner *1



Remote Control *1

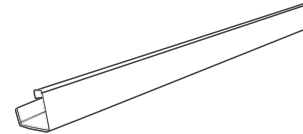

**Top Rail
(With sponge) *1**

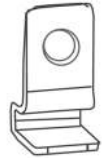

Lock Frame *2

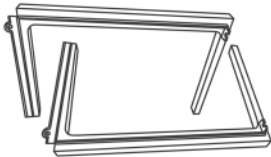

Filler Panels *2
(with "Left" and "Right" labeled)



**Sash Lock
(Two holes) *1**



**Window Sash Seal
(Sponge) *1**

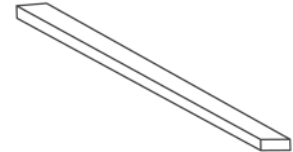

**Foam Top Window
Gasket *1**
(Thin sponge, in case needed)



3/8" Screws *4



1/2" Screws *3



3/4" Screws *4

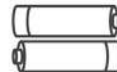

**Remote Control
Battery *2**

Installation & assembly instructions

Some assembly is required for your new air conditioner. Please read this entire manual and the following instructions carefully before you get started.

Some initial notes:

- All supporting parts must be secured to firm wood, masonry, or metal.
- The electrical outlet must be within reach of the power cord.
- The air conditioner should be tilted about 3° for better drainage of condensate and rainwater.
- Save the product packaging and installation instructions for future reference.
- Store the air conditioner in the product box when not in use for an extended period of time.

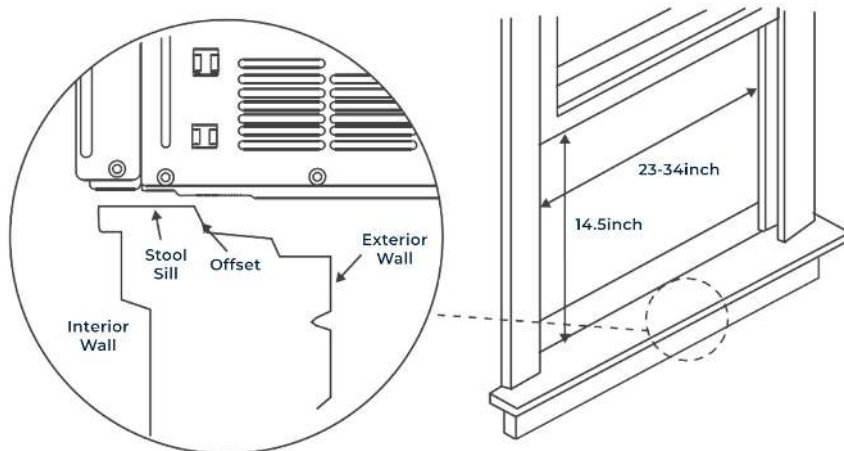

Top rail assembly

The top rail must be assembled prior to installing the air conditioner in the window.

Tools needed: Phillips head screwdriver

Attaching the top rail to the air conditioner

- Remove the air conditioner from the box and place on a hard and flat surface.
- Remove top rail from the top of the packaging material as shown in **Fig.A**.
- Align the holes in the top rail with those in the top of the unit as shown in **Fig.B**.
- Secure the top rail to the unit with the 3/8" screws as shown in **Fig.C**.



CAUTION

When handling the unit, be careful to avoid cuts from the sharp metal edges and aluminum fins on the front and rear coils.

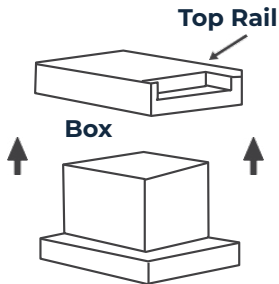
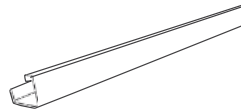

Fig.A



Top Rail
(With sponge) *1



3/8" Screws *4

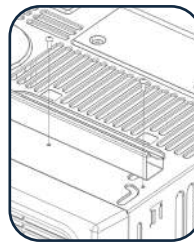

Fig.B



Fig.C



NOTE: For safety reasons, all 4 screws must be used to attach the top rail.

Accordion panel installation

Now that you have installed the top rail, you can install the accordion panels on each side.

- Place the air conditioner on a hard flat surface.
- Locate the accordion panels in the box.
- Gently pull the free end of the accordion panel **(See Fig.2).**
- Slide the free end of the accordion panel down into the side grooves on the air conditioner **(See Fig.3).**
- Do this for each side.
- Once the accordion panels are slid into place, push the top and bottom rails of the accordion panels into the top and bottom rails of the air conditioner **(See Fig.4).**

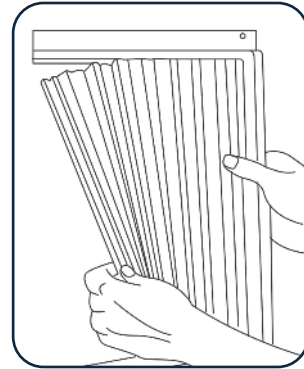

Fig.2

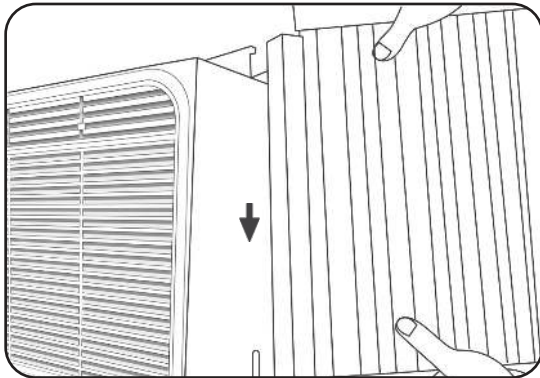

Fig.3

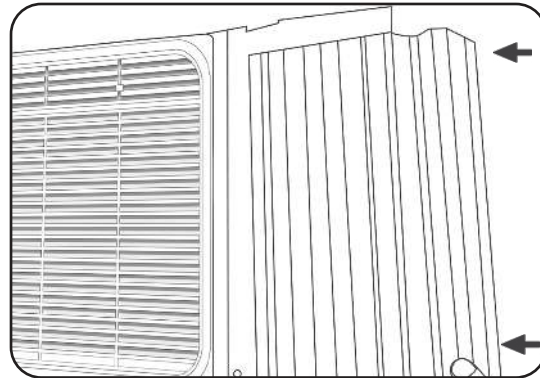

Fig.4

Storm window requirements

A storm window frame will not allow the air conditioner to tilt properly which in turn will keep it from draining properly.

To adjust for this, attach a board or piece of wood to the sill. The board or wood piece should have a depth of at least 1-1/2". Make sure the board or piece of wood is approximately 1/2" higher than the storm window frame. This will allow the air conditioner to tilt enough for proper drainage **(See Fig.5)**.

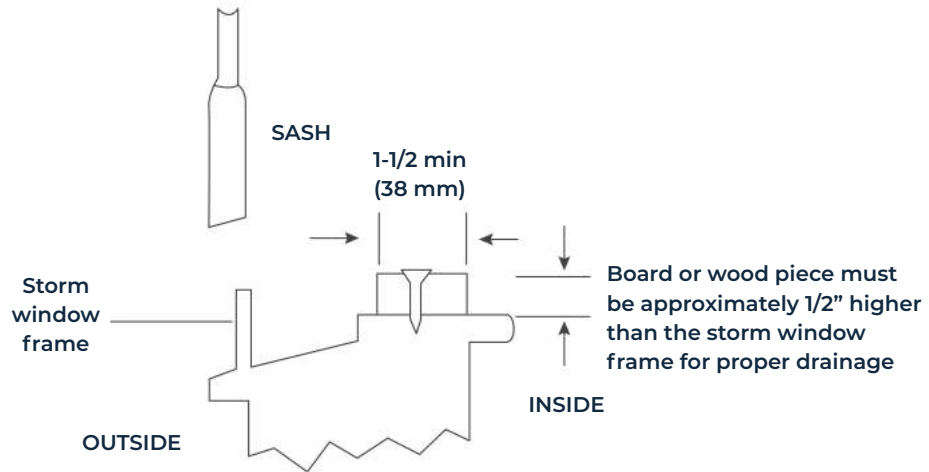

Fig.5

Placing the unit inside the window

Place the air conditioner on the sill with the bottom mounting rail against its back edge. Center the air conditioner and close the window securely behind the top mounting rail. The air conditioner should be slightly tilted to the outside area. Use a level, about a 1/3 bubble will be the correct case slant to the outside (**See Fig.6 & Fig.7**).

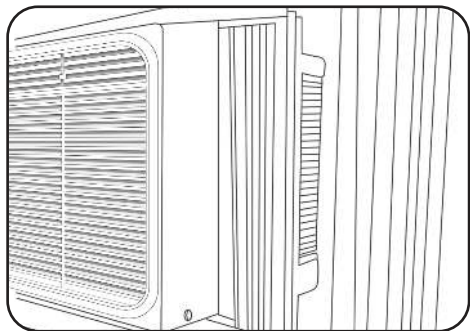

Fig.6

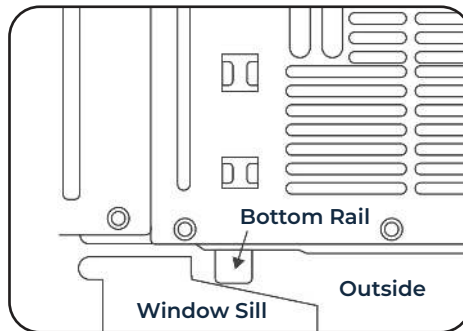

Fig.7

- Once the AC is placed properly, extend both the left and right accordion panels to the width of the window (**See Fig.8**).

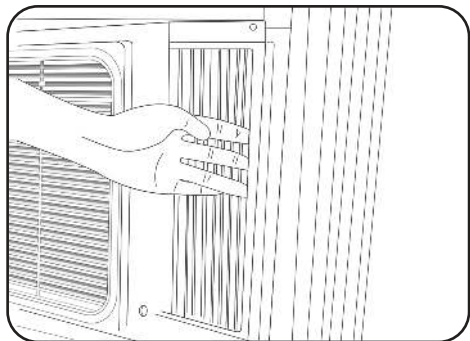

Fig.8

Frame lock, sash lock, and foam seal installation

Mounting hardware tools needed:

Phillips head screwdriver

Drill (if pilot holes needed)

- Place the frame lock between the extended accordion panels and the window sill as shown in **Fig.9**. Screw a 3/8" locking screw through the frame lock and into the window sill (**Fig.10**).

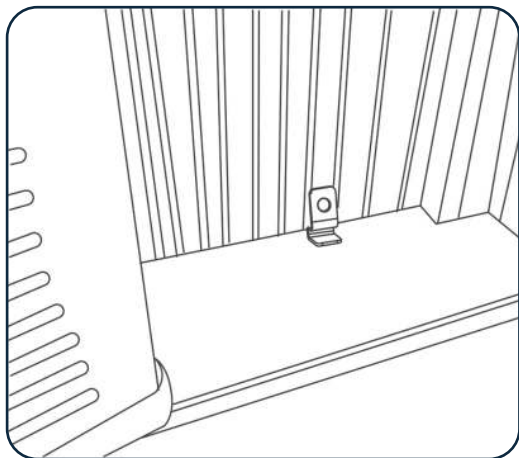

Fig.9

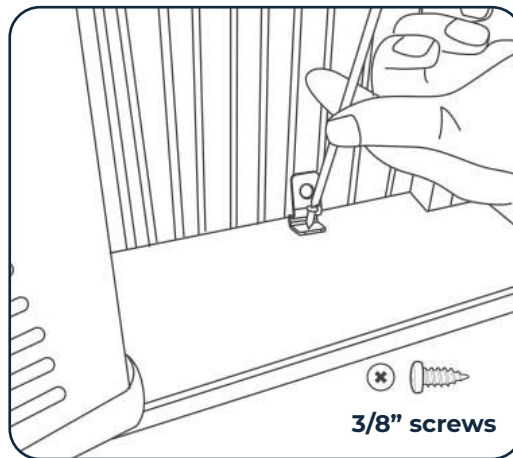

Fig.10

- Drive 1/2" screws into the top of the accordion panel frame and the top rail to securely attach the window air conditioner to the lower sash (**See Fig.11 & Fig.12 on next page**).

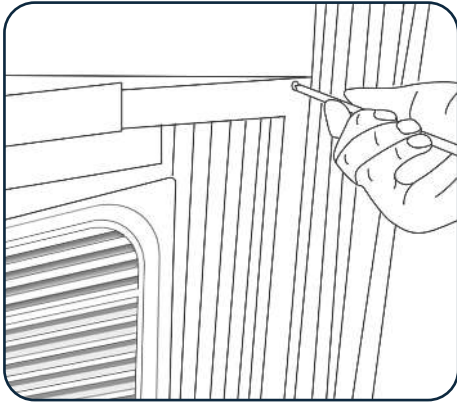

Fig.11

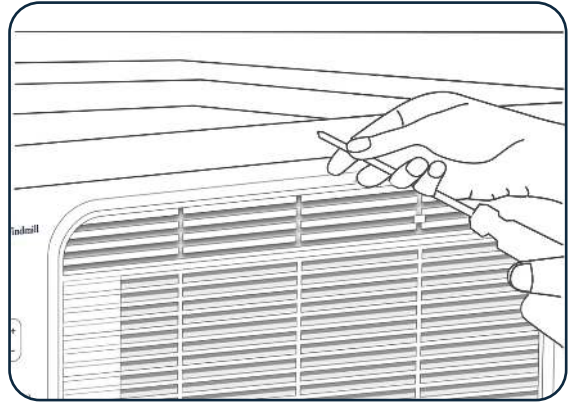

Fig.12

- To secure the lower sash into place, use the sash lock and 3/4" screws as shown below **(See Fig.13).**
- For added insulation, cut the supplied insulation foam to the width of the window. Insert the foam between the window sashes to prevent air and objects from getting into the room **(See Fig.14).**

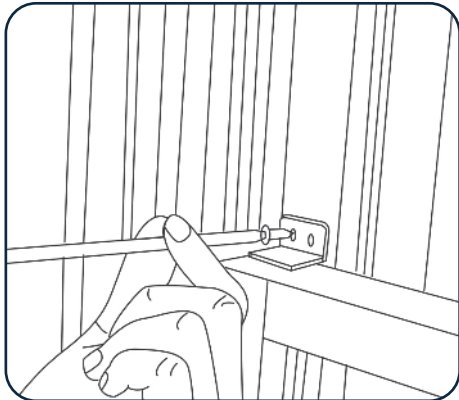

Fig.13

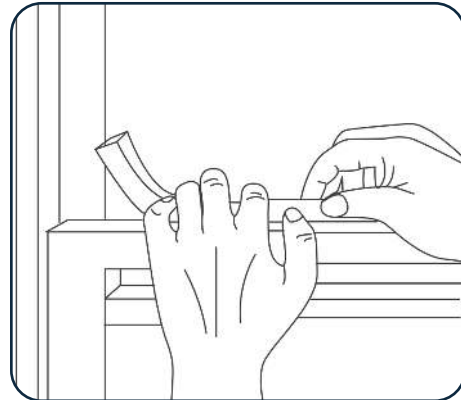



Fig.14





Removing the AC from the window

- Do not attempt this without a helper.
- Turn the AC off and unplug the power cord.
- Remove the sash seal from between windows, and unscrew sash lock. Remove the screws installed through the frame and frame lock.
- Close (slide inward) the side panels with accordions into frame.
- Keeping a firm grip on the air conditioner, raise the sash and carefully tilt and “rock” the AC backward to drain any condensate water. Be careful not to spill any remaining water while lifting unit from window.
- Carefully, with a helper, bring the air conditioner into the room.
- Store parts with the air conditioner in the box. Store in a clean, dry environment.



Using your air conditioner

<p>72° Display</p>	<p>Displays room temp.</p> <p><i>The display fades after 1 minute (except when first powered on - then the display will remain on for 3 minutes). To wake up the display, press any button, then proceed with your selections. If you want to turn the power indicator light off, to run your AC in the dark, hold down the Mode button for 3 seconds.</i></p>
<p> Temperature up/down</p>	<p>Use the up and down arrows to set the room temperature. The min set temp is 61 degrees Fahrenheit and the max temp is 88 degrees Fahrenheit.</p> <p><i>When you change the set temp, the display will flash with your set temp value, then return to the room temp.</i></p>
<p> Cool Eco Fan Mode</p>	<p>Cool: When powered on, the AC will enter cool mode (the most popular mode). This is the most effective mode for cooling your space and controlling humidity. In this mode, the compressor will kick on when needed and the fan will run continuously.</p> <p>Eco: This mode helps conserve energy (and your electric bill!). In this mode, the unit will turn off when your desired temperature is reached. The fan will turn on periodically to pull in room air and check the temperature. If the temperature is above your desired level, the AC will kick on and cool again.</p> <p>Fan: In this mode, the fan runs continuously and the compressor stays off. You cannot set a room temperature in this mode (since it is not a cooling mode, like Cool and Eco).</p>

 <p>Fan</p>	<p>Change the fan speed to your desired level - low, medium, or high.</p>
 <p>WiFi</p>	<p>Download the Windmill Air app by scanning the QR code below:</p>  <p>The WiFi indicator light will blink slowly if not connected to the Windmill Air app. It will blink quickly when in pairing mode. To enter (or exit) pairing mode, hold down the WiFi button for 3 seconds. Follow the instructions in the app to pair your AC with the app. When connected successfully, the WiFi indicator light will be steady on the display (remember, the display fades after 60 seconds).</p>
 <p>Filter change</p>	<p>This light will be off until it is time to clean your filter. When the light comes on, clean your filter, re-install it, and then hold the Filter button for 3 seconds to reset it.</p>
 <p>Power</p>	<p>Turn the AC on and off.</p> <p><i>When the AC is on, the power indicator light will be on. If you want the AC to run in the dark, hold the Mode button for 3 seconds. Hold it again for 3 seconds to turn it back on.</i></p>

Tips and Tricks!

- The display fades after 1 minute (so the AC runs unintrusively in the background). Press any button to wake the display. When initially powered on, the display stays on for 3 minutes.
- Beeping is OFF by default. To turn beeping ON, hold down the Fan button for 3 seconds. Hold it again for 3 seconds to turn beeping off again.
- The AC can run completely in the dark (perfect for sleep!). Hold down the Mode button for 3 seconds to turn off the power indicator light. The rest of the lights on the display will fade after 1 minute.
- Use the included remote (AAA batteries), on-unit buttons, or Windmill Air app to control the AC.

Other Notes

- The AC will remember its last setting after a power interruption.
- There is a 3 minute delay protection for the compressor (it will help your AC work well and last longer!).
- Your AC comes with a remote control. The remote can control power, mode, temperature (up/down), and fan speed. It uses AAA batteries. Do not mix old and new batteries.

Care and cleaning

Air filter cleaning

It's important to clean the filter monthly for cleaner, healthier air and to make sure your AC works properly. If the filter is clogged, your AC will break and not cool the room.

To clean your filter

- 1 Unplug your AC.
- 2 Remove your filter by sliding it out from the front right of the AC (see diagram).
- 3 Wash your filter in the sink with warm water and mild dish soap.
- 4 Shake it gently to remove excess water and let it sit until it's completely dry.
- 5 Place it back into the AC.

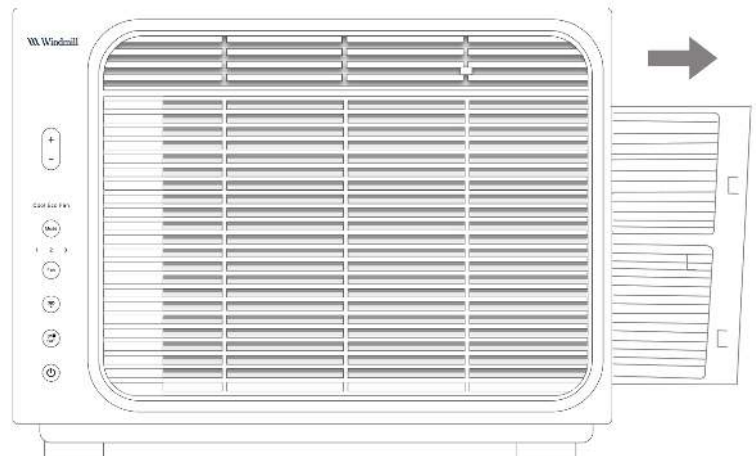

Cabinet cleaning

- 1 Unplug your AC.
- 2 The outer cabinet and front panel can be cleaned with an oil-free cloth (dampened in warm water and mild liquid soap, if desired). Never use harsh cleaners, wax, or polish. Do not use a wet cloth around the buttons (excess water and moisture can get into the controls and break the AC).
- 3 Use a dry cloth to completely dry the AC before plugging it back in.

Winter storage

To store the air conditioner when it is not in use for an extended period of time, remove it carefully from the window according to the installation instructions and cover it with plastic or place it in the original box. Store in a clean, dry location.





Thank you!

Thanks for reading and trusting Windmill to keep you cool!

If you have any questions, do not hesitate to reach out.
We're here and happy to help!

support@windmillair.com
windmillair.com

Loving Windmill?

We make other high-design, high-performance home air products.

Go to **windmillair.com** to shop and learn more.

Follow us **@windmillair** on Instagram for exclusive discounts and announcements!

