

External Factor Checklist

1. Please **reset** the bidet.
 - a. Unplug the unit.
 - b. Fully open the water shutoff valve.
 - c. Plug the unit back in.
 - d. Press the nozzle cleaning button to check if the nozzle extends, then press it again to ensure it retracts.
 - e. **Put your hand on the seat sensor shown in the photo** and press the posterior or feminine button on the **remote** to see if the unit is functional.



1. Please clean the **Main Strainer Filter**.
2. Please remove the **water pressure regulator**.

External Factor Check List

1. Power Reset, Open Water Valve, and Remote Setting

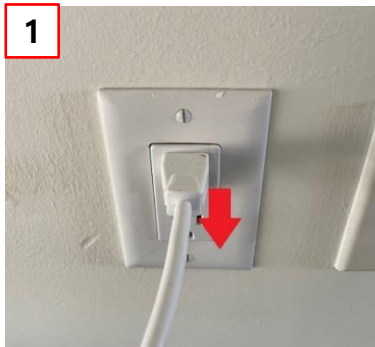

① Unplug the power cord.



② Turn the water valve fully open in the direction of the arrow.

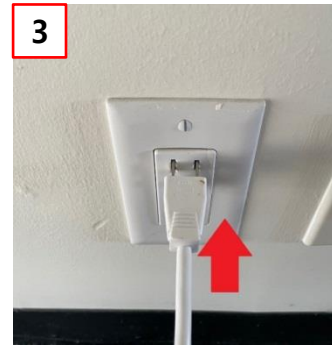

③ Plug the power cord back in.



④ Check the water pressure setting on the remote and set it to level 5.

※ Operate the product to confirm water pressure.

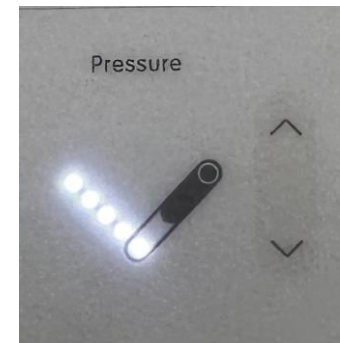
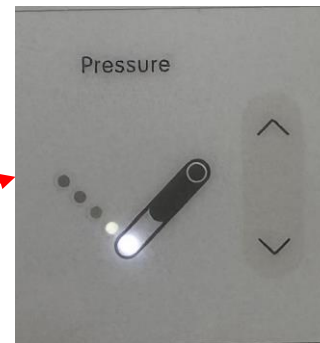

2. Cleaning the Main Strainer



① Turn the water valve fully closed in the direction of the arrow.



② Use a tool to turn and remove the marked part of the strainer.



③ Check the filter for any debris.



④ Rinse the removed mesh under running water.

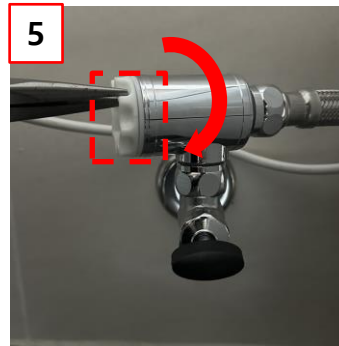

⑤ Reattach the strainer by turning it in the direction of the arrow using a tool.



⑥ Turn the water valve fully open in the direction of the arrow.

3-1. Removing the Bidet & Water pressure regulator



① Unplug the power cord.



② Turn the water valve to the closed position.

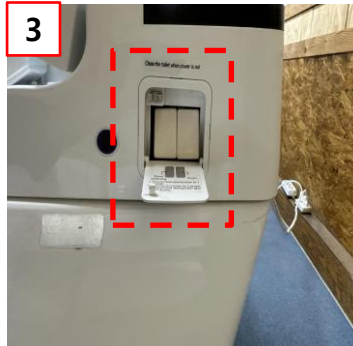

③ Press the manual flushing button on the side to release pressure.



④ Pull the lever plate forward and lift to remove the bidet.



⑤ Disconnect the water supply hose

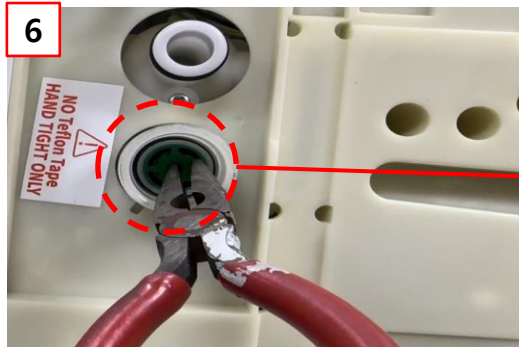

⑥ Use a tool to hold the groove of the water pressure regulator.

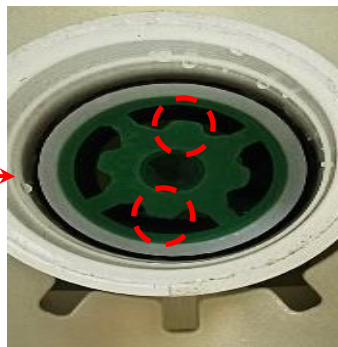

⑦ Pull out the water pressure regulator to remove it.

3-2. Installing the Bidet



① Connect the water supply hose.



② Align the unit with the base and catch plate, then secure it.



③ Turn the water valve open in the direction of the arrow.

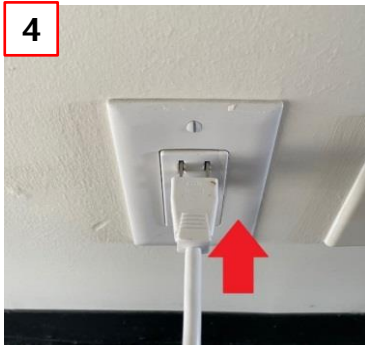

④ Plug in the power cord.