

SMOKELESS GRILL

2000053 - Instruction Manual

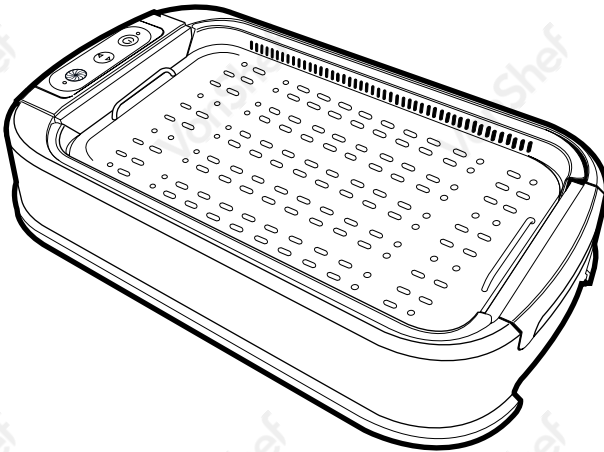

CONTENTS

Safety Instructions	1
Safety Instructions	2
Specification	3
Before First Use, Control Panel	4
Assembly	5
Operation	6
Cleaning & Maintenance	7
Warranty	8

SAFETY INSTRUCTIONS



PLEASE READ THESE INSTRUCTIONS CAREFULLY AND KEEP FOR FUTURE REFERENCE.

INTENDED USE.

Only operate the VonShef® Smokeless Grill for its intended purpose and within the parameters specified in this manual.

This Smokeless Grill is intended for indoor, domestic use only. Do not use outdoors or for commercial purposes.

This appliance is not intended for use by persons with reduced physical, sensory or mental capabilities, or lack of experience and knowledge, unless supervised or given appropriate instruction concerning the product's use by a person responsible for their safety.

This appliance is not intended for use by children.

GENERAL PRECAUTIONS.

When using an electrical appliance, basic precautions should always be followed, including the following:

Do not allow to be used as a toy. Children should be supervised to ensure they do not play with the appliance.

If the Smokeless Grill is not functioning properly, has been dropped, damaged, left outdoors, or immersed in liquid, do not use, contact DOMU Brands Customer Services.

Do not use the Smokeless Grill if any parts appear to be faulty, missing or damaged.

Ensure all parts are securely attached before use.

CABLES AND PLUGS.

Check to ensure your electricity supply matches that shown on the rating plate. This product should only be used as rated. Preferably, the socket outlet should be protected by a Residual Current Device (RCD).

Do not use with a damaged cable or plug. If the supply cable is damaged, it must be replaced by a qualified engineer or authorised service agent in order to avoid a hazard.

The use of an extension cable is not recommended.

Do not handle the plug or appliance with wet hands.

Keep the cable away from heated surfaces.

Do not let the cable hang over the edge of the table or countertop where it could be pulled on inadvertently by children or pets.

Do not pull the cable around sharp edges or corners.

Do not leave unattended when plugged in. Unplug from outlet when not in use.

Turn off all controls before unplugging.

Do not unplug by pulling on the cable. To unplug, grasp the plug, not the cable.

Always unplug before performing user maintenance, connecting or disconnecting attachments, or changing accessories.

Ensure the cable is stored safely to prevent hazards.

SAFETY INSTRUCTIONS



PLEASE READ THESE INSTRUCTIONS CAREFULLY AND KEEP FOR FUTURE REFERENCE.

RISK OF PERSONAL INJURY.

Always locate your appliance away from the edge of the worktop, on a firm, flat, heat-resistant surface with sufficient space around all sides.

The Smokeless Grill is not intended to be operated by means of an external timer or separate remote-control system.

Always ensure the Power Cord is connected to the appliance before connecting it to the mains socket.

Only use the Power Cord supplied.

Ensure the Drip Tray is always in position before each use. Never use the appliance without the drip tray.

It is highly recommended you add water to the drip tray before every use. Fill just enough to cover the base to minimise fat splatters.

Do not operate the Smokeless Grill without food on the GRILL PLATE as this will shorten the lifespan of the appliance.

Keep hair, loose clothing, fingers and all parts of the body away from openings and moving parts.

Do not insert any objects into openings or cover the appliance.

When using for the first time, your Smokeless Grill may give off a 'new' smell or vapour. This will dissipate after a few uses. Always operate in well ventilated areas.

Do not touch the surfaces of the Smokeless Grill during use as it will become extremely hot. Use oven mitts to remove the GRILL PLATE.

Avoid using sharp utensils to add or remove ingredients from the GRILL PLATE, as this will damage the surface. Always use cooking tongs.

Do not lift or move the appliance when in use.

Do not leave the appliance unattended when in use.

Do not operate continuously for periods longer than those indicated in this manual.

Never leave cooking tongs or spatulas placed on the GRILL PLATE during use.

Do not allow the Drip Tray to overfill with hot oils.

Take care not to drop or knock the Smokeless Grill.

Always allow the Smokeless Grill to cool completely before cleaning.

Do not submerge any of the appliance in water or any other liquids to clean.

Do not place components in a refrigerator or freezer.

Do not lubricate any parts or carry out any maintenance or repair work other than that shown in this manual, or as advised by the DOMU Brands Customer Care Helpline.

Use only as described in this manual and with DOMU Brands recommended accessories only.



WARNING! HOT SURFACES

PRODUCT SPECIFICATION

VOLTAGE

V

220-240

RATED
POWER

W

1500

RATED
FREQUENCY

Hz

50/60

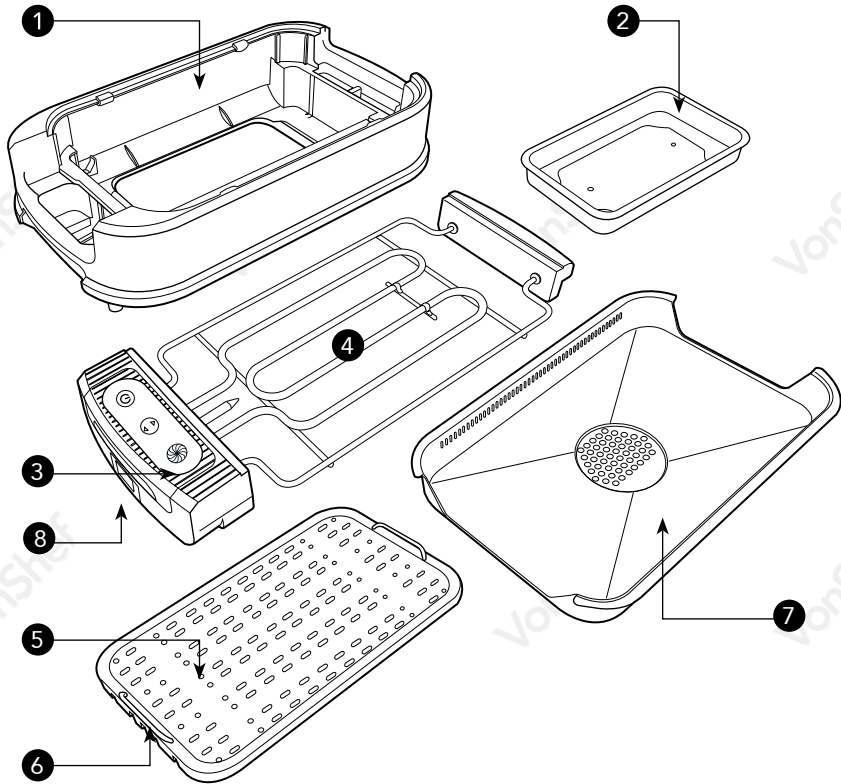

1. MAIN UNIT (with fan motor).

2. WATER/OIL COLLECTION TRAY.

3. CONTROL PANEL.

4. HEATING ELEMENTS.

5. GRILL PLATE.

6. GRILL PLATE HANDLES.

7. HEAT INSULATION PLATE.

8. POWER INLET

9. POWER CORD (not pictured).

BEFORE FIRST USE

Before using this appliance for the first time, please ensure you complete the following steps:

- Carefully unpack the Smokeless Grill and remove all packaging materials, including any stickers or labels.
- Clean the accessories in warm soapy water and allow to dry completely.
- Wipe all removable component with a slightly damp cloth and mild detergent. Dry thoroughly before use.



WARNING! Never immerse the **HEATING ELEMENTS** in water or any other liquid or place in a dishwasher to clean. Wash by hand only.

- Position the Grill on a heatproof mat before use to avoid possible damage to surfaces.

CONTROL PANEL

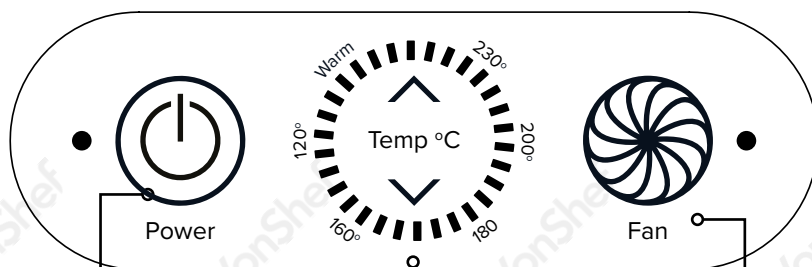

POWER BUTTON

Press **ONCE** to switch on the appliance. Once operation has finished, press again to turn the appliance off.

TEMPERATURE ADJUST

Press the adjustment arrows to increase or decrease the temperature. The surrounding indicator lights will illuminate with each press.

FAN ACTIVATION

The Grill can be used with or without the fan feature. Simply press to activate.

NOTE: When the fan feature is **NOT** activated, smoke may appear.

ASSEMBLY

- Ensure the **MAIN UNIT** is placed on a flat, stable, heat-resistant surface with sufficient space around all sides.
- Place the **WATER/ OIL COLLECTION TRAY** inside the **MAIN UNIT** frame and fill with just enough water to cover the bottom. This will help reduce any fat or grease sticking to the **TRAY**.

IMPORTANT: The Grill should not be used without the **WATER/ OIL COLLECTION TRAY** securely in place.

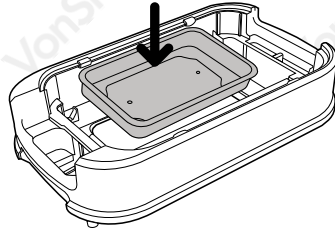

- Attach the **HEAT INSULATION PLATE**, ensuring the arrows indicated are facing the larger opening of the **MAIN UNIT**.

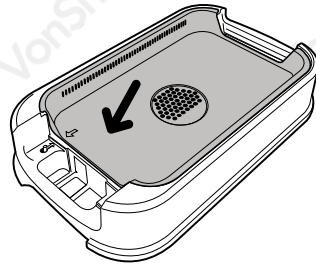

- Next, fix the **HEATING ELEMENTS** to the **MAIN UNIT**. The **CONTROL PANEL** should sit securely into the larger opening of the **MAIN UNIT** ensuring full contact is made with the trigger switches underneath.

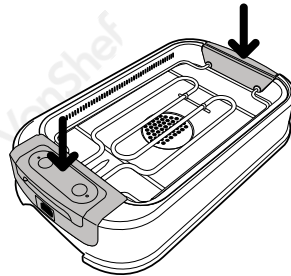

- Finally, attach the **GRILL PLATE** by simply lowering onto the **HEATING ELEMENTS** using the small handles.

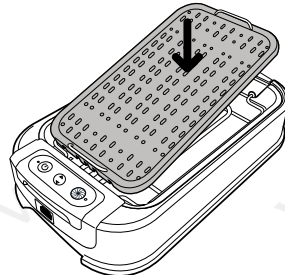

OPERATION

- Before switching on the Smokeless Grill, the **GRILL PLATE** should be conditioned with vegetable oil. To do this, pour a teaspoon of oil onto a piece of kitchen towel and wipe around the surface of the **GRILL PLATE**. Alternatively, pour a small amount of oil directly onto the **GRILL PLATE** and spread around using a soft pastry brush. Wipe away any excess oil.
- Insert the **POWER CORD** into the **POWER INLET** and connect to a suitable mains outlet.
- Press the **POWER BUTTON** on the **CONTROL PANEL**.

NOTE: When using the Smokeless Grill for the first time, you may notice a 'new' smell or vapour. This will dissipate after a few uses. Always operate in well ventilated areas.

- Allow the **GRILL PLATE** to heat sufficiently before adding any food to it.

IMPORTANT: Ensure you have pre-prepared your food beforehand. Do not attempt to slice any ingredients whilst positioned on the **GRILL PLATE** as this will damage and scratch the surface.

- Use wooden or silicone cooking tongs to add your prepared foods to the **GRILL PLATE**.
- Depending on the food you are cooking, you may wish to adjust the temperature. This can be done at any time during operation by pressing the **ADJUSTMENT ARROWS** on the **CONTROL PANEL**.



WARNING! The use of an oven mitt is highly recommended as some ingredients added to the **GRILL PLATE** may spit fat and surfaces become extremely hot during operation.

NOTE: Avoid overloading the **GRILL PLATE** with ingredients to prevent under cooking.

- To ensure food cooks evenly, use kitchen tongs (not supplied) to turn the food over from time to time.
- Once your food has been cooked to your liking, turn the appliance off using the **POWER BUTTON** and disconnect from the mains.
- Allow the Grill to completely cool before removing the **POWER CORD** from the **POWER INLET**.
- Remove the food from the **GRILL PLATE** using kitchen tongs and allow the appliance to completely cool. Once cooled, wipe any excess grease from the **GRILL PLATE** using paper towel ready for cleaning.

CLEANING & MAINTENANCE

CAUTION: Before carrying out cleaning or maintenance, disconnect the appliance from the mains.

IMPORTANT: Ensure the **POWER CORD** has been removed from the appliance before cleaning.

- Once the Smokeless Grill has completely cooled, remove the **GRILL PLATE** from the **MAIN UNIT** by lifting the **PLATE HANDLES**.
- Remove the **WATER/OIL DRIP TRAY** from the base. Empty any contents and leave to soak in warm water and mild detergent. Gently wipe using a sponge or soft cloth. Dry using a soft cloth or paper towel.
- Using a non abrasive sponge, clean the **GRILL PLATE** and **HEAT INSULATION PLATE** with warm water and mild detergent. Use circular motions to remove any stubborn ingredients. Ensure both of the **PLATES** are completely dry before storing.

CAUTION: Do not use any abrasive cleaning materials to clean the **GRILL PLATE** as this can scratch the non-stick surface.



WARNING! Do not immerse the **GRILL PLATE** or **THERMOSTAT** in water or any other liquid to clean.

IMPORTANT: Do not remove or use the Smokeless Grill without the motor cover in place.

- Store the appliance in a cool, dry area out of reach of children.

CUSTOMER SERVICES

If you are having difficulty using your product and require support, please contact: hello@domu.co.uk

DISPOSAL INFORMATION

Please recycle where facilities exist. Check with your local authority for recycling advice.

WARRANTY

To register your product and find out if you qualify for a free extended warranty, go to:

www.VonShef.com/warranty

Please retain a proof of purchase receipt or statement as proof of the purchase date.

The warranty only applies if the product is used solely in the manner indicated in this manual and all instructions have been followed accurately. Any abuse of the product or the manner in which it is used will invalidate the warranty.

Returned goods will not be accepted unless re-packaged in its original packaging and accompanied by a relevant and completed returns form. This does not affect your statutory rights.

No rights are given under this warranty to a person acquiring this appliance second-hand or for commercial or communal use.

COPYRIGHT

All material in this instruction manual are copyrighted by DOMU Brands Ltd.

Any unauthorised use may violate worldwide copyright, trademark, and other laws.

Thank you for purchasing the Smokeless Grill.

VonShef® is a registered trademark of DOMU Brands Ltd
Made in China for DOMU Brands Ltd M24 2RW.
