

Inflatable Camping Tent 17.2m²

JFG044BG

INSTRUCTION MANUAL

Created with inspirations from forest log cabin, and supported by an integral inflatable column structure, a camping tent can be put up completely by inflating only once. Equipped with projection screen, the tent features better permeability through its big area door and window and provides a sense of attic atmosphere by the transparent skylight at its top, so this tent is quite suitable for luxury camping and courtyard leisure.

17.2 m²

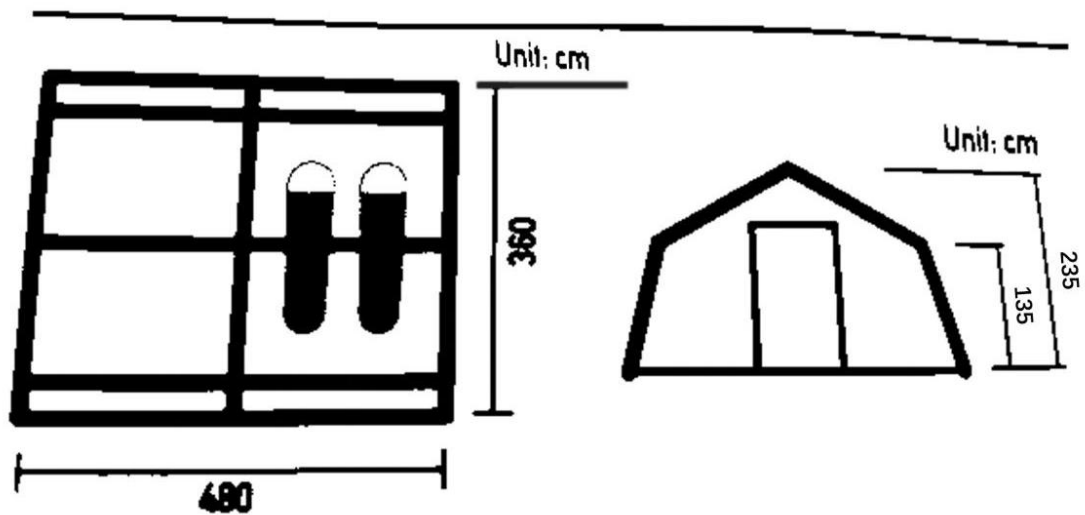

Accessory Details



Stakes * 16



Windproof rope * 6
already tied on

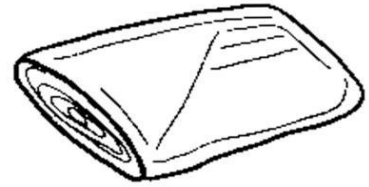

Projection Screen * 1

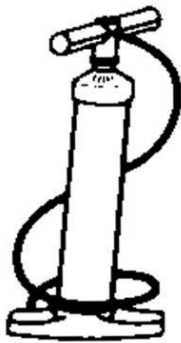

Air Pump * 1

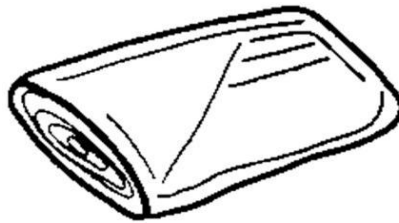

Removable floor cloth * 1

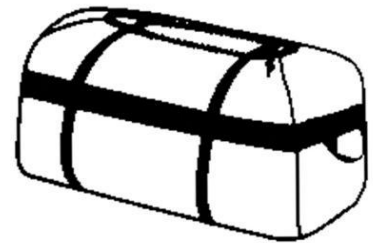

Storage Bag * 1

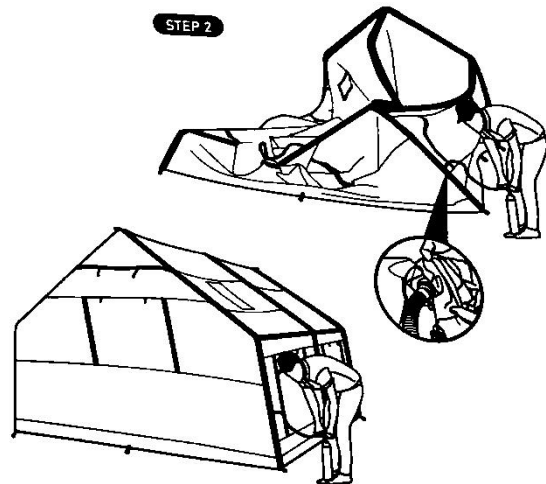
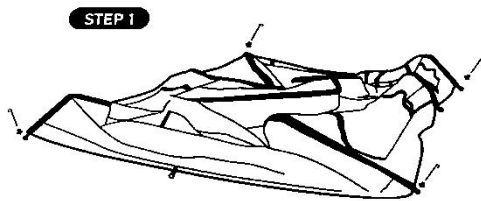

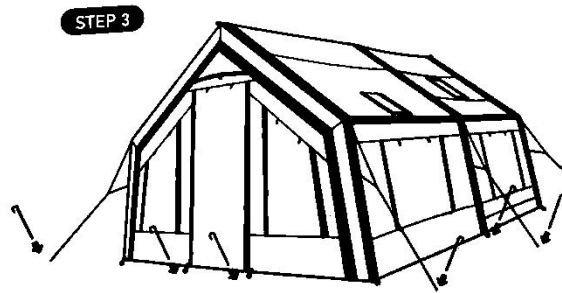

Installation instruction

1. Tile the tent, drive the ground nails at the four corners of the bottom of the tent, and install the pump.
2. Find the black inflation valve, remove the valve lid and connect to the pump to inflate until the barometer needle moves to green area.
3. Insert the other ground nails, pull the wind rope and fix it properly.
4. Support the curtain with 2 hallway poles and wind ropes. Please put down the curtain in rainy days.

Precautions

1. Tents provide a temporary shelter in the open air, which are not suitable for holding for a long time.
2. Tents can only withstand moderate weather changes, while extreme weather (such as heavy rain, strong wind, and snowstorms) could completely destroy tents, so please pay attention to the weather to arrange camping activities reasonably.
3. The life of tents is limited. Reasonable use and maintenance can prolong its service life,
4. For a reasonable and enjoyable camping activity, please note the following matters.
 - Please choose a flat camp to set up the tent, keep it on the lee side, away from water and trees, not on the top of the mountain or under the cliff, not in the valley or on the beach, etc.
 - Please set up the tent (both ground nail and wind rope are equipped) according to the instructions to make its appearance full and flat.
 - Avoid sharp objects touching the tent.
 - Keep away from fire.
 - Pay attention to the ventilation inside the tent.
 - After use, dry it in time and store it in a dry state.

ATTENTION

1. Please check the manual carefully and make sure you have received all the parts.
2. If there is any missing, please let us know the letter of the parts you need.
3. If there is any damage, please send clear photos to us, we will check and offer you best solution soon.