

SOLIGHT

USER MANUAL PRO 1L202

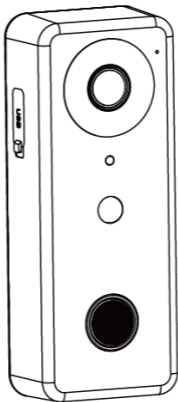

MAIN FUNCTIONS



Wireless
control



Ultrawide
angle of view



Wireless
control



Quality
night mode



1080P
Full HD video



Two-way
full duplex
Communication



TF card
Max. 128 GB

PACKAGING CONTENT

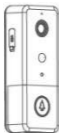

Smart WiFi doorbe

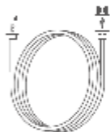

1x USB cable



1x User
Instructions



Packing of scr
and dowels



1x Imbus
key



Reversible
adhesive tape



1x Installation
holder

DESCRIPTION OF EQUIPMENT

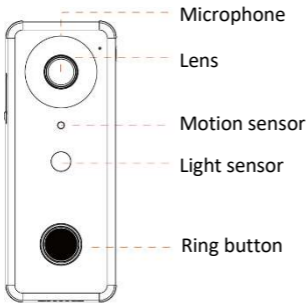

Speaker	Sound channel
Lens	Image recording
Infrared LEDs	Additional light in low light conditions
PIR sensor	PIR sensor settings
Indicator light	Presents the working states of the device
Ring button	Sends a notification to the app when the button is pressed
Microphone	Audio conversion

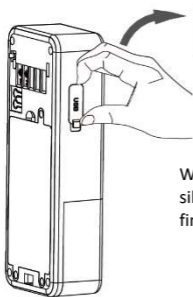

Waterproof
cover



USB - C
5V/2A

When you open the waterproof silicone cover on the side, you'll find a USB-C charging slot.

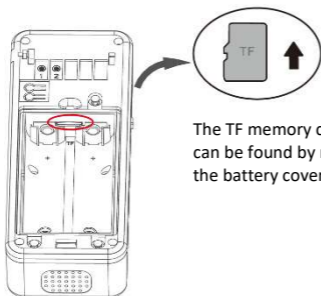

The TF memory card slot can be found by removing the battery cover.



Svorky 1, 2:
Power supply 12-24V AC or DC.

Before using the device for the first time, turn on the device, press and hold the reset button for approximately 5 seconds until "System reset" is heard and then release the button.

GENERAL INFORMATION

- The device supports mobile phones/tablets with iOS 9.0 and above, or Android 4.4 and above.
- The device is not compatible with Mac and Windows computers.
- The device is only compatible with 2.4GHz Wi-Fi.

INDICATOR LIGHT SIGNALLING

LED status	The meaning of status
Blue lights up, red flashes slowly	Configuration status
Blue lights up, red flashes fast	Connecting to Wi-Fi
Blue and red light	Weak battery
Shining blue	Connection is fine, live transmission
Neither blue nor red lights	Sleep mode or off-line

MOBILE APPLICATIONS

Search for the "TUYA SMART or SMART LIFE" app in the AppStore (for Apple) or in GooglePlay (for Android) and download it.

After downloading the mobile app, open it and log in. If you don't have an account, click "Register" and follow the instructions in the app. Once you have completed the registration, log in.

DEVICE PAIRING

1. To pair your device, click on "Add device" or "+" in the top right corner

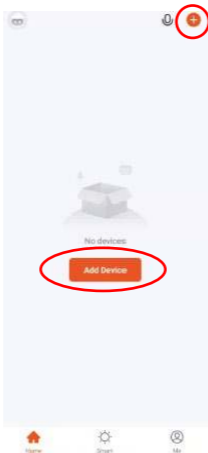

2. Select "Camera and lock" and then "Smart Doorbell" (Fig. 1)

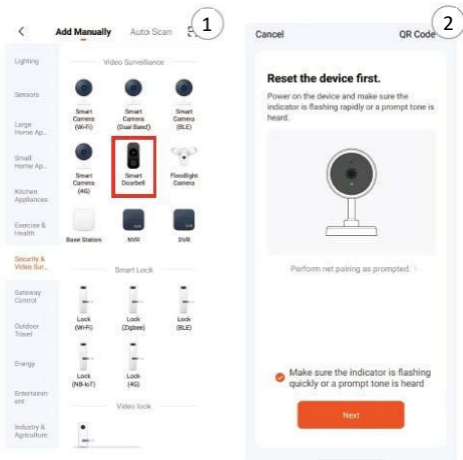

3. Confirm that the indicator light is flashing on the device by ticking it and click "Next" (Fig. 2)
4. Enter the name of your 2.4GHz Wi-Fi network and enter its password (Figure 3).

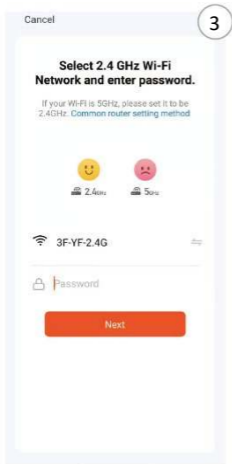

5. Use the camera to read the QR code from your phone and confirm in the mobile app if you hear a beep.
6. Wait for the device to pair.

For more detailed information about the application and product, please visit www.youtube.com under the title "**Solight 1L202 - Application Instructions**".

LOCATION OF THE BELL

1. Use double-sided tape to place on a smooth surface. Glue the cover first, then insert the bell into it.

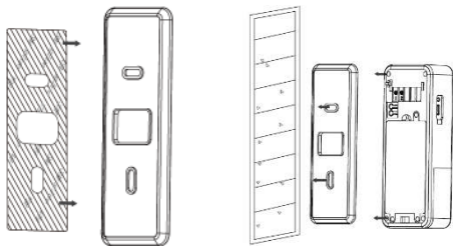

2. To attach the device to a rough surface, first screw the bracket to the wall and then attach the bell to it.

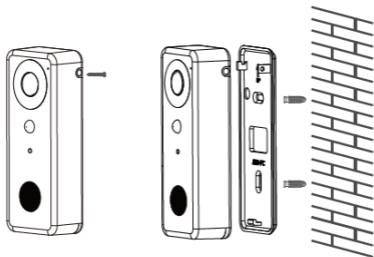

CHARGING THE DOORBELL

Always take the device inside the building when charging, never charge outside. Attach a USB-C cable to the side of the doorbell, then plug it into a 5V/2A USB adapter, which plugs into an AC 100~240V outlet. Charge for at least 4 hours.

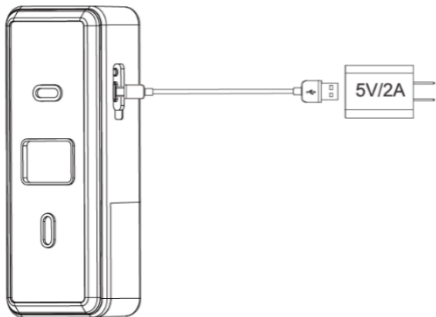

GONG PAIRING

Equipment description

1. USB plug
2. Play melody button - plays the currently selected melody
3. Melody selection button - plays other melodies
4. Volume - set the ringer volume
5. LED indicator

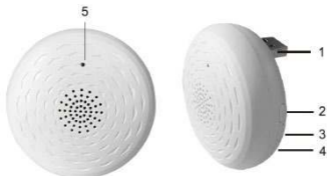

The bell and gong operate at 433MHz. Pair the gong with the bell after you have paired the bell with the mobile app.

Gong pairing procedure:

1. Connect the gong to the USB adapter and plug it into the wall socket.
2. Press and hold the **play** button (2) and **volume change** button (4) for 3 seconds until the indicator turns red. Then press the ring button on the doorbell within 15 seconds to connect the gong to the doorbell, after which the indicator goes out and the doorbell rings.
3. You can move the gong within 30m (in the open) of the bell.

Ringtone selection

Choose from 20 melodies. Press the melody selection button (3) to select a suitable melody.

Clearing memory for pairing

Press and hold the play button (2) and the melody selection button (3) for 3 seconds, then plug the gong into the socket. The LED indicator will start flashing red, once the flashing stops, the memory is cleared.

POWER SUPPLY

Permanent powering of the doorbell is possible using direct current or alternating current in the range of 12-24V, which is connected to the terminals on the back of the video doorbell. A source with a power of 12W and higher is suitable for powering the doorbell.



The product has been issued with a CE Declaration of Conformity in accordance with the applicable regulations. On request from the importer at www.solight.cz