

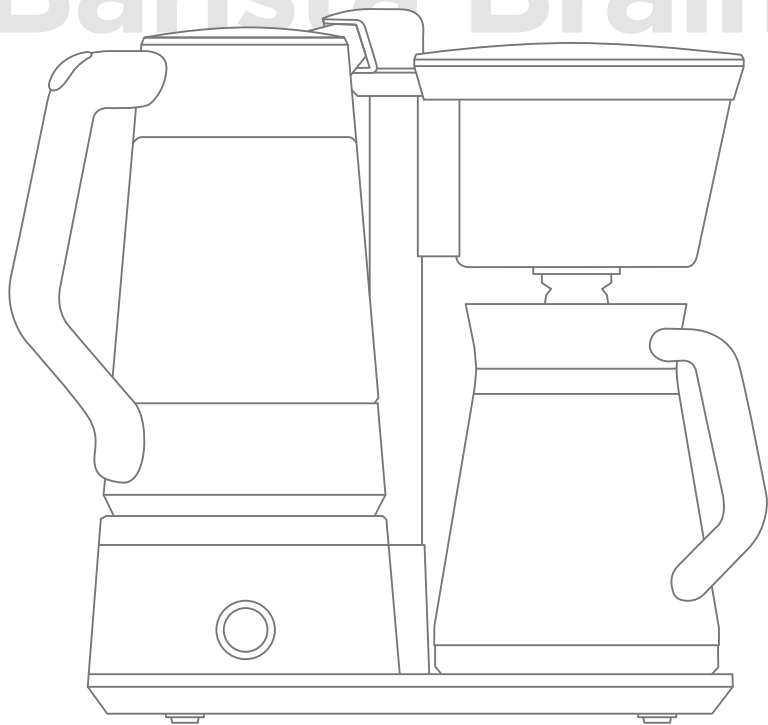

Barista Brain



12-CUP COFFEE BREWING SYSTEM
INSTRUCTIONS FOR USE



CONGRATULATIONS
on your new OXO On appliance!

Don't forget to register your product
at OXO.com/registration.aspx
for updates and other relevant information.

Although greatly appreciated, product registration is not required to activate any warranty.

The art of perfect coffee, down to an exact science

A delicious cup of coffee is art and science combined: the art of extracting rich flavors and aromas from coffee grounds, and the science of time and temperature colliding in just the right way, at just the right moment.

The OXO Barista Brain Coffee Brewing System heats water in the removable kettle to the optimal temperature to help your favorite roast reach its full potential, and precisely maintains the temperature throughout the entire brewing process. Water is measured by an integrated scale and pumped to the brew basket in perfectly timed cycles, starting with a short cycle that allows coffee to bloom for full flavor extraction. The intelligent microprocessor monitors time, temperature and volume from start to finish, ensuring the precision of hand-crafted coffee with the ease of ordering at your favorite local coffee shop.

You choose the number of cups and we'll do the rest, providing a pot of perfection every time.

A Note About Safety	3	Troubleshooting.....	14
Before We Begin.....	5	Cleaning, Care and Storage.....	16
Quick Start Guide	6	Descaling	17
Meet Your Brewing System.....	7	Our Guarantee	18
The Particulars of Brewing	9	Registration Info	18

A Note About Safety



IMPORTANT SAFEGUARDS

Read all instructions.

When using electrical appliances, basic safety precautions should always be followed to reduce the risk of fire, electric shock, and/or injury to persons, including the following:

- **Read All Instructions.** Use this product only as described in this manual.
- Keep the packaging material (cardboard, plastic, etc.) out of the reach of children (danger of asphyxiation or injury).
- Do not touch hot surfaces. Use handles or knobs. Care must be taken, as burns can occur from touching hot parts or from spilled, hot liquid.
- To protect against fire, electric shock and injury to persons **do not immerse cord, plugs or Coffee Brewing System in water or other liquid.**
- Close supervision is necessary when any appliance is used by or near children.
- **Unplug Coffee Brewing System from outlet when not in use and before cleaning. Allow to cool before putting on or taking off parts and before cleaning the appliance.**
- Do not open lid until Coffee Brewing System has cooled completely.
- Coffee Brewing System must be operated on a flat surface away from the edge of counter to prevent accidental tipping.
- Do not operate any appliance with a damaged cord or plug, or after the appliance malfunctions or is dropped or damaged in any manner. Contact OXO Consumer Service at 1-800-545-4411. Do not return to store.
- The use of accessory attachments not recommended by OXO may result in fire, electric shock or injury to persons.
- Do not let cord hand over edge of table or counter or touch hot surfaces, including stove.
- Do not place on or near a hot gas or electric burner, or in a heated oven.
- Always attach plug to appliance first, then plug cord into the wall outlet. To disconnect, turn any control to “off”, then remove plug from wall outlet.
- The coffee carafe is designed for use with this appliance. It must never be used on a range top or in a microwave oven.
- Do not use appliance without lid properly placed on carafe.
- Do not remove carafe or brew basket while brewing.
- Do not allow the kettle to boil dry.
- Be certain the kettle lid is securely in place during operation and when pouring hot water. Do not use force when placing lid on kettle.
- Do not allow glass kettle to come in contact with hard or sharp material. The glass kettle is fragile and can break if dropped or struck with hard/sharp material.
- To disconnect the Coffee Brewing System, turn controls to OFF, then remove plug from wall outlet.
- Scalding may occur if the cover is lifted during the brewing cycle.
- **WARNING!** To reduce the risk of fire or electric shock, **do not remove the bottom cover.** Doing so will void warranty. No user serviceable parts are inside. Repair should be done by authorized service personnel only.
- **This appliance is intended for household use only.** Do not use appliance for other than intended use. Do not use outdoors.

WARNING! Shock Hazard: This appliance is equipped with a power cord having a grounding wire with a grounding plug. The appliance must be grounded using a 3-hole properly grounded outlet. In the event of an electrical short circuit, grounding reduces the risk of electric shock. If the power outlet is a standard 2-prong wall outlet, it is your personal responsibility and obligation to have it replaced with a properly grounded 3-prong outlet. **Do not, under any circumstances, cut or remove third (ground) prong from power cord or use adaptor.** Consult a qualified electrician if the grounding instructions are not completely understood, or if doubt exists as to whether the appliance is properly grounded. Do not use an adapter with this appliance.

SHORT CORD STATEMENT

The length of the cord used on this appliance was selected to reduce the hazards of becoming tangled in, or tripping over a longer cord. If a longer cord is necessary, an approved extension cord may be used. The electrical rating of the extension cord must be equal to or greater than the rating of this appliance.

Care must be taken to arrange the extension cord so that it will not drape over the countertop or tabletop where it can be pulled on by children or tripped over.

To avoid an electrical circuit overload, do not use any high wattage appliance on the same circuit with this appliance.

⚠ WARNING! ⚠

SHOCK HAZARD

ONLY FOR USE WITH 110V AC OUTLET.
DO NOT USE ADAPTER.

FAILURE TO FOLLOW THESE INSTRUCTIONS CAN RESULT IN DEATH, FIRE OR ELECTRICAL SHOCK.

⚠ This symbol alerts you to important operating and service instructions.

⚠ WARNING! ⚠

**RISK OF FIRE OR ELECTRIC SHOCK
DO NOT OPEN**

WARNING, TO REDUCE THE RISK OF FIRE OR ELECTRIC SHOCK,
DO NOT REMOVE COVER (OR BACK)
NO USER-SERVICEABLE PARTS INSIDE
REPAIR SHOULD BE DONE BY AUTHORIZED SERVICE PERSONNEL ONLY

⚠ This symbol alerts you to the risk of fire or electric shock in the accompanying message.

SAVE THESE INSTRUCTIONS.

Before We Begin

1. Remove and recycle or discard all stickers, descriptive labels, cable ties and packing materials, including static stickers and hangtags with ties.
2. Remove paper filters from the brew basket.
3. Wipe all parts with a damp cloth. Wash kettle, carafe, brew basket, silicone internal mixing tube and scoop with soap and water.

⚠ CAUTION: Do not put stainless steel carafe or glass kettle in dishwasher. Do not use abrasive pads, harsh chemicals or spray cleaner chemicals to clean. These may damage the surface of the appliance.

4. Install silicone internal mixing tube in lid of stainless steel carafe. Screw on lid and place empty carafe below brew basket.
5. Plug cord into 110V outlet.
6. Twist dial and press OXO button to set clock.
7. Twist dial to select between Fahrenheit and Celsius.
8. Set boiling point to 212°F / 100°C
NOTE: Boiling point differs at high altitudes.*
9. Fill removable glass kettle to “10 CUP” fill line and run one “Brew Coffee” cycle without ground coffee following the steps to the right.

*If you live at a higher altitude please refer to the instructions on pg. 12 for information about how to properly set your boiling point.

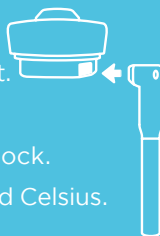

Quick Start Guide

BREW COFFEE

1. Fill removable glass kettle with water and close lid. Place kettle on base.
2. Rotate kettle until spout engages with connector.

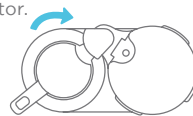

3. Place paper filter in brew basket, add ground coffee, then close lid.
4. Press the OXO button to enter cup setting menu. Twist dial to choose between 4-12 cups and press OXO button to start brewing.



HEAT WATER

1. Fill removable glass kettle with water between “MIN” and “MAX” and close lid. Place kettle on base.
2. Do not engage spout with connector.

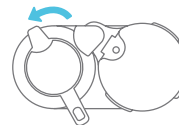

3. Press the OXO button to enter water temperature menu. Twist dial to choose desired water temperature and press OXO button to start heating.



4. Once heating cycle finishes, water will be kept warm for 30 minutes or until canceled.

BREW COFFEE AND HEAT WATER AT THE SAME TIME

1. Fill removable glass kettle with water to “MAX” fill line and close lid. Place kettle on base.
2. Rotate kettle until spout engages with connector.
3. Place paper filter in brew basket, add ground coffee then close lid.
4. Press the OXO button to enter cup setting menu. Choose between 4-10 cups with dial and press OXO button to start brewing coffee. The hot water remaining in the kettle after coffee is brewed can be used for tea or other hot beverages.

To learn more about how to use your Coffee Brewing System, check out “The Particulars of Brewing” on pg. 9.

See pg. 16 and 17 to learn how to descale your OXO Coffee Brewing System, as well as get other use and care information. (Descaling is a simple process required for all coffee makers to maintain long-term heating efficiency.)

CONNECTOR

REMOVABLE WATER KETTLE

Easy-to-fill kettle heats water to brew coffee or to make tea and other hot beverages

BOROSILICATE GLASS CONSTRUCTION

Kettle is made of durable, BPA-free borosilicate glass for thermal shock protection and a pure, clean taste

PRECISION PUMP

Water is transported to brew basket in measured cycles, including a pre-soak cycle so grounds can bloom

INNOVATIVE INTERNAL SCALE

Water volume is intelligently monitored for optimum coffee extraction and consistently perfect cups

PRECISE TEMPERATURE CONTROL

Water is heated and held at the perfect temperature for coffee (197.6-204.8°F) or your preferred temperature for tea (174-212°F)

INTUITIVE LED INTERFACE, DIAL AND OXO BUTTON

The backlit screen and one-dial interface features coffee/tea cup selection, 24-hour programmable brew-start, freshness timer, and more

Meet Your Coffee Brewing System

REMOVABLE RAINMAKER™ SHOWERHEAD

Water is evenly dispersed over coffee grounds for uniform saturation and full flavor extraction

LARGE BREW BASKET

Basket provides large surface area for even ground coffee saturation from 4 to 12 cups

SOFT, NON-SLIP HANDLES

Kettle and carafe provide comfortable, non-slip grips for controlled, easy pouring

REMOVABLE SILICONE INTERNAL MIXING TUBE

Coffee is blended thoroughly as it is brewed into the carafe so the last sip is as delicious as the first

VACUUM-INSULATED CARAFE WITH BREW-THROUGH LID

Double-walled stainless steel carafe keeps your brew hot and fresh

INTELLIGENT MICROPROCESSOR

Barista Brain monitors all operations to achieve perfect results

1 CUP COFFEE SCOOP AND 10 FILTERS INCLUDED

The Particulars of Brewing

TO BREW COFFEE:

1. Ensure internal mixing tube (see pg. 5) and Rainmaker™ showerhead are properly installed. Place Coffee Brewing System in a well-ventilated area. Do not operate the Coffee Brewing System under a cabinet.

NOTE: Although we recommend the use of the internal mixing tube, the Coffee maker will work without it.

2. Remove glass kettle from the base.
3. Open kettle lid by pressing the button on handle.
4. Fill with the desired amount of clean, cold water. Always fill between the “MIN” and “MAX” markings.

NOTE:

- Under-filling could result in kettle switching off before reaching a boil and/or overheating of the element. Overfilling may result in boiling water splashing out of pour spout. This may cause scalding and serious injury.
- With this OXO Coffee Brewing System it is not necessary to measure the exact amount of water you need. As long as you have at least enough water for your desired cups of coffee, the Coffee Brewing System will take care of the rest.

5. Close the kettle lid and position kettle securely onto power base. Turn kettle so that the spout nests within the connector.

NOTE: When setting the kettle on the base, display will show total volume of water in the container for a few seconds.

6. Open the brew basket lid and insert one 12-cup commercial paper filter. We have provided 10 paper filters for your convenience. Ensure the removable brew basket is securely in place.

NOTE:

- When aligned properly and pressed down, the brew basket will snap into place.
- OXO recommends using OXO On 12-Cup Paper Coffee Filters (#8710800).

7. Fill the filter with desired amount of medium ground coffee.

NOTE: OXO recommends using approximately 8 grams of ground coffee per cup (5 fl oz). If using the OXO coffee scoop provided,

a level scoop is about 8 grams, so you should use one level OXO scoop per cup of coffee. Coffee dosage recommendations are based on the Specialty Coffee Association of America (SCAA) gold cup ratio, designed for optimal extraction and strength.

Cups of Coffee	4	6	8	10	12
Recommended OXO Scoops of Coffee per Cup	4	6	8	10	12
Recommended Grams of Coffee per Cup	33	49	65	81	98

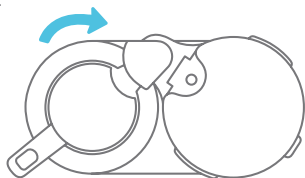

(Based on 8.13 g/cup, grams rounded to nearest whole number)



8. Close the brew basket lid.
9. Press the OXO button once to display the cup setting menu.
10. Twist the dial to select number of cups desired. The number on the right of the display indicates how many cups of coffee will be brewed. The number on the left of the display will show how many cups of hot water will remain after brewing.



NOTE: The scale under the water kettle will weigh how much water you've put in the kettle and provide the maximum number of cups of coffee or boiling water you can make in the display.

11. Press the OXO button to start the heating and brewing cycle. The white LED ring around the dial will illuminate. The  icon indicates water is heating. The  icon will appear to indicate coffee is brewing. To cancel the brewing cycle at any time, press the OXO button once.

NOTE:

- The current temperature of the water will be displayed throughout the heating cycle. Once perfect brewing temperature is reached, the brewing cycle will run. A timer will count down the time remaining on the brew cycle; times may vary.
- The internal water pump is programmed with a coffee bloom cycle and pauses within the brewing cycle to simulate the pour-over technique and optimize extraction.
- **Pause and pour:** Can't wait for the brew cycle to end? A sensor under the stainless steel carafe triggers the brew cycle to pause for 60 seconds if the carafe is removed. You may see residual drips of coffee, but it beats a puddle of coffee and grounds on your counter! The  icon blinks when carafe is removed during brewing. Brewing will continue if carafe is replaced within 60 seconds. If the carafe is not replaced within 60 seconds, the brew cycle is automatically canceled.
- Do not add water to Kettle during active brew cycle.

! CAUTION: Do not open brew basket lid, disengage kettle spout from connector or remove glass kettle during brew cycle.

12. Once the brew cycle finishes, the  icon appears. The freshness timer will count up to 60 minutes to show how long it has been since the coffee finished brewing. For the best taste, OXO recommends drinking coffee within one hour of brewing. To cancel freshness timer, press OXO button once.



13. Remove the carafe and pour a delicious cup of coffee. Carafe's pour-through lid means you do not need to unscrew or remove the carafe lid to pour coffee.

NOTE:

- A small and harmless amount of residual steam may collect in the kettle after brewing. Leaving the kettle lid open after brewing will help reduce the collection of steam.
- Dispose of coffee grounds and paper filter once cooled. After disposing coffee grounds, wash and rinse brew basket and set aside to dry.

TO HEAT UP WATER:

1. Remove glass kettle from the base.
2. Open kettle lid by pressing the button on handle.
3. Fill with the desired amount of clean, cold water. Always fill between the “MIN” and “MAX” markings.

NOTE:

- Under-filling could result in kettle switching off before reaching a boil and/or overheating of the element. Overfilling may result in boiling water splashing out of pour spout. This may cause scalding and serious injury.
- For best results, OXO recommends using water processed through a water filtration system like those offered by PUR.

4. Close the kettle lid and position kettle securely onto power base.

NOTE: When only boiling water, the kettle spout does not need to be engaged with the connector. If spout is engaged, allocate all the water to the water side.

5. Press the OXO button once; the temperature prompt will appear.
6. Choose desired water temperature by twisting the dial. (For tea temperature recommendations, see pg. 13.)

7. Press the OXO button to start the heating cycle. To cancel at any time, press OXO button once.

NOTE: The current temperature of the water will be displayed throughout the heating cycle. Once chosen water temperature is reached, the kettle will keep water at that temperature for 30 minutes, unless canceled. To cancel the keep warm function at any time, press the OXO button once. After 30 minutes, the machine will automatically shut off.

8. Lift the kettle from the base and pour water from the spout slowly.

NOTE: Use caution when pouring hot water from your kettle. Do not pour water too quickly.



TO BREW COFFEE AND BOIL WATER:

The OXO Coffee Brewing System is designed to boil water in the removable glass kettle before brewing coffee. Since its intelligent scale measures the exact amount of water per cup of coffee, you can add extra water to the kettle to have boiling water left after your coffee brews for tea, hot chocolate, oatmeal and more.

1. Remove glass kettle from the power base.
2. Fill kettle with clean, cold water past what is required to make the number of cups of coffee you desire. For example, if you are making 6 cups of coffee, fill kettle between the “8-cup” and “MAX” measurement markings. This ensures there will be boiling water left in the kettle after brewing. Always fill between the “MIN” and “MAX” markings.
3. Close the kettle lid and position kettle securely onto power base. Turn kettle so that the spout engages with the connector.
4. Follow steps 6 through 12 in “To Brew Coffee” on pg. 9.

NOTE:

- To ensure boiling water will be left after brewing, fill kettle to “MAX” measurement marking and brew between 4 and 10 cups of coffee. If you brew 12 cups of coffee, no water will remain in the kettle.
- To cancel at any time during the brew cycle, heating up water or keeping warm, just press the OXO button.

TO CHANGE THE SET TIME & BOILING POINT:

SETTING TIME

1. Hold down the OXO button until you see “12H” blinking on the display (you will pass the wake-up timer screen).
2. Twist dial to switch between 12- and 24-hour format.
3. Press OXO button to select and save.
4. Set current time by twisting the dial. Twist dial to the right to increase and left to decrease time.
5. Press OXO button to select and save.

SETTING BOILING POINT

IF YOU LIVE AT A HIGH ALTITUDE, YOU MAY NEED TO SET A BOILING TEMPERATURE OTHER THAN 212°F.

If you skip this step, it will take about 10 minutes for the brew cycle to start.

NOTE: You will have to go through setting time to get to boiling point.

1. Twist dial to choose Fahrenheit (F) or Celsius (C). Press OXO button to save selection.
2. Twist dial to change boiling point temperature. Twisting to the right increases temperature and twisting left decreases.

NOTE: Boiling point differs at high altitudes. See the chart below to select the correct boiling point temperature for your altitude.

3. Press OXO button to select and save.

SIMPLIFIED ALTITUDE GUIDE

Altitude Above Sea Level	Boiling Point
0-500 Ft. / 0-150 M	212° F / 100° C
500-1,000 Ft. / 150-300 M	210° F / 99° C
1,000-2,000 Ft. / 300-600 M	208° F / 98° C
2,000-3,000 Ft. / 600-900 M	206° F / 97° C
3,000-4,000 Ft. / 900-1,200 M	204° F / 96° C
4,000-5,000 Ft. / 1,200-1,500 M	202° F / 95° C
5,000-6,000 Ft. / 1,500-1,800 M	200° F / 94° C
6,000-7,000 Ft. / 1,800-2,100 M	198° F / 93° C
7,000-8,000 Ft. / 2,100-2,400 M	196° F / 92° C

TO SET THE WAKE-UP TIMER:

When the wake-up timer is activated, the Coffee Brewing System will automatically turn on and brew coffee or heat water at the chosen time.

1. Fill removable glass kettle with desired amount of water and return to power base. Add paper filter and ground coffee to brew basket before setting wake-up timer.

NOTE: Ensure kettle spout is engaged with the connector.

2. To access the wake-up timer, hold down the OXO button until you see flashing time and the  icon.



3. Change the desired wake-up time by twisting the dial. Set time by pressing the OXO button.

4. Twist dial to select the number of cups you wish to brew or heat.

NOTE: If you are only boiling water, twist dial to the left until all cups are allocated to hot water.

5. Set wake up timer by pressing the OXO button. If the  icon flashes, ensure glass kettle is filled with desired amount of water (do not fill past "MAX" level), then repeat selection process. If the  icon flashes, ensure stainless steel carafe is properly in place then repeat selection process.



The wake-up timer is now activated. Display will show current time along with the  icon to remind you the wake-up timer is set. To check the set wake-up time, give the OXO button a quick press. If you wish to cancel the wake-up timer, hold down the OXO button until the  icon disappears.

NOTE: You cannot brew coffee or boil water while the wake-up timer is set. If you want to brew coffee or boil water before the wake-up time you previously selected, hold down the OXO button to cancel wake-up timer, then start a regular cycle. After brewing or boiling, set the wake-up timer again.

NOTES ON TEA AND TEMPERATURE:

Correct water temperature is essential for extracting the best flavors out of tea. Different types of tea require different water temperatures. The following is a guide to help choose the right water temperature for various types of tea:

TYPE	TEMPERATURE	STEEP TIME
Green Tea	175°F / 80°C	2-3 mins
White Tea	185°F / 85°C	2-3 mins
Oolong Tea	190°F / 88°C	3-4 mins
Black & Herbal Teas	212°F / 100°C (Full Boil)	3-5 mins





Note: This table is a recommended guideline. Temperatures may vary depending on preference, or on type and age of tea used. OXO encourages you to experiment with different temperatures and times to suit personal taste.

Good Tips

- Great tasting coffee starts with fresh water. Where local water is of poor quality, you may wish to use bottled or filtered water. Distilled water is not recommended.
- If you buy large portions of beans, separate them into one- or two-week portions and store them in tinted, airtight containers. Refrigeration is not recommended since condensation tends to form on beans whenever the container is opened.
- The best cup of coffee comes from coffee beans that are properly ground just before brewing. Be sure to select a medium grind, which is ideal for automatic drip coffee makers. We recommend using the OXO On Conical Burr Coffee Grinder with Integrated Scale (#8710200).

Troubleshooting

You have questions, we have answers. For more information, call OXO Customer Service at 1-800-545-4411.

Question/Problem	Explanation/Solution
None of the lights are illuminating	 Check to ensure that your Coffee Brewing System is plugged into an outlet.
OXO button light is on, but the coffee maker is not working	 <ol style="list-style-type: none">1. Ensure stainless steel carafe is properly in place on base.2. Ensure water is in the removable glass kettle.3. May require descaling. See instructions on pg. 16.4. Follow steps on pg. 12 to make sure your boiling point is set properly. Please note that different altitudes have different boiling points.
Brew basket is overflowing	 Clogging and backing up of water and/or coffee in the filter basket can occur under any or a combination of any of the following conditions: the use of coffee ground too finely, using two or more paper filters, a blockage to the drain hole of the brew basket, the stainless steel carafe improperly installed or missing.
Does the brewer automatically "shut off" after a set period?	 The heating element shuts off once brewing is complete. The machine turns completely off after the freshness timer times out (60 minutes after brewing).

Question/Problem	Explanation/Solution
How do I brew less than 4 cups?	➔ In order to consistently make high quality coffee, the OXO On Coffee Brewing System does not allow brewing less than 4 cups.
Coffee tastes weak or bitter	➔ We recommend using 55 grams of coffee per liter of water or about 8 grams of coffee per OXO cup. You can also adjust the fineness of the grinds. Keep in mind that too course grinds will generate weak coffee and too fine grinds will generate bitter coffee.
Brew cycle is taking more than 8 minutes to complete	➔ This could be due to a mineral deposit obstruction in the water tubes. See descaling instructions on pg. 16.
Water is dripping out very slowly	➔ 1. Ensure the stainless steel carafe lid is engaging with the valve at the bottom of the brew basket. 2. Check for any obstruction in the brew basket drain
There is still water left in the Kettle after brewing	➔ The scale reads the amount of water then rounds down for the optimal coffee/water ratio.
I live at an altitude where the boiling point is not 212° F/100° C	➔ See instructions and Altitude Chart on pg. 12 to set your desired boiling point.
Removable glass kettle is cloudy	➔ The Coffee Brewing System needs to be descaled. See descaling instructions on pg. 17.
The ⚠ icon is on but the Coffee Maker is still brewing	➔ The Coffee Brewing System needs to be descaled. See descaling instructions on pg. 17.
How do I order replacement parts?	➔ Go online: www.oxo.com or contact Customer Service at 1-800-545-4411

Cleaning, Care and Storage

TO CLEAN YOUR COFFEE BREWING SYSTEM:

Any service or maintenance other than cleaning or descaling should be performed by an authorized service representative. Call OXO customer service at 1-800-545-4411.

Always unplug your Coffee Brewing System prior to cleaning. Clean Coffee Brewing System regularly with a damp cloth and wipe dry. After each use, hand wash carafe, kettle and brew basket with mild detergent. Rinse thoroughly. The stainless steel carafe and removable glass kettle are not dishwasher safe. Coffee oil stains in the stainless steel carafe may be removed by placing a small amount of dishwasher detergent and water in carafe and allowing it to soak overnight.

The brew basket, Rainmaker™ showerhead, coffee scoop and internal mixing tube are top-rack dishwasher safe.

 **CAUTION:** To prevent damage to the appliance, do not use alkaline cleaning agents, abrasive pads, harsh chemicals or spray cleaner chemicals when cleaning. Use a soft cloth and mild detergent if desired.

 **WARNING:** Never immerse the Coffee Brewing System, power cord or plug in water. Do not allow liquid to come in contact with power cord or plug.

 **WARNING!** 

ELECTRICAL SHOCK HAZARD:

NEVER IMMERSE THIS APPLIANCE, POWER CORD OR POWER PLUG IN WATER OR ANY OTHER LIQUID. DOING SO CAN RESULT IN DEATH OR ELECTRICAL SHOCK.

 **WARNING!** 

SHOCK HAZARD

ONLY FOR USE WITH 110V AC OUTLET.

DO NOT USE ADAPTER.

FAILURE TO FOLLOW THESE INSTRUCTIONS CAN RESULT IN DEATH, FIRE OR ELECTRICAL SHOCK.

Descaling

Scale is a naturally occurring buildup of mineral deposits. The ideal descaling cycle depends on water hardness. The Coffee Brewing System will automatically let you know it's time to descale by displaying the  icon.

Regular descaling can also increase the service life of the Coffee Brewing System, allowing it to heat water faster with less energy.

YOUR COFFEE BREWING SYSTEM WILL NOT WORK PROPERLY IF IT IS NOT DESCALED REGULARLY. The warranty is voided if descaling is not carried out in accordance with these instructions.

TO DESCALE:

To descale while  icon is lit:

1. Fill the glass kettle with descaling solution and water to the **"10 CUP" fill line** and return to power base. Ensure kettle spout is engaged with connector and stainless steel carafe is in place.
NOTE: Descaling solution is available where household cleaning products are sold; follow solution's recommended use.
2. Open the brew basket lid and insert one 12-cup commercial paper filter. Ensure the removable brew basket is securely in place.
3. Close the brew basket lid.
4. Press the OXO button once to display the cup setting menu.
5. Twist the dial to allocate all water to coffee.
6. Press the OXO button to begin descaling cycle.
7. Repeat until  icon turns off then run a clean water cycle.



After descaling, fill glass kettle with water to "10 CUP" fill line, run a "Brew Coffee" cycle without ground coffee and discard water before next use.

NOTE: The  icon will appear when the Coffee Brewing System needs to be descaled, but you can descale at any time using the above steps.

Our Guarantee

TWO-YEAR WARRANTY:

We guarantee everything we make! Starting from the date of purchase, your OXO On 12-Cup Coffee Brewing System is guaranteed by OXO for two years in the case of any manufacturing defects in materials or workmanship. This OXO warranty is only offered on OXO On appliances sold and used in the US and Canada.

The OXO warranty covers all costs related to restoring the proven defective product through the repair or replacement of any defective part and necessary labor so that it conforms to its original specifications. A replacement product may be provided instead of repairing a defective product. OXO's exclusive obligation under this warranty is limited to such repair or replacement.

A receipt indicating the purchase date is required for any claims, so please keep it in a safe place. We recommend that you register your product on our website, www.oxo.com/registration.aspx. Although greatly appreciated, the product registration is not required to activate any warranty and product registration does not eliminate the need for the original proof of purchase.

The warranty does not cover damages resulting from misuse or abuse of the product and/or uses inconsistent with this Use and Care manual, attempts at repair, theft, use with unauthorized attachments or failure to follow the instructions provided with the product.

The warranty becomes void if attempts at repair are made by non-authorized third parties and/or if spare parts, other than those provided by OXO, are used.

You may also arrange for service after the warranty expires at an added cost.

For questions, returns, repairs or warranty claims within the US, please visit www.oxo.com or contact OXO Customer Service at **(800) 545-4411**. We will be glad to assist you.

For customer service, claims or questions on sales in Canada, OXO Customer Service will gladly put you in touch with the appropriate individuals.

This warranty gives you specific legal rights, and you may have other legal rights which vary from state to state, country to country or province to province. The customer may assert any such rights at their sole discretion.

CONTACT INFO:

If you have any trouble with the product during the warranty period, do not attempt to return it to a retail store. Instead, please visit us online at www.oxo.com or contact us at:

OXO U.S. Customer Service

Hours: Monday – Friday, 8:00am – 5:00pm (ET)

Phone: (800) 545-4411 **Fax:** (717) 709-5350

Mail: OXO International, Inc. at 1331 S Seventh St. Ste 4,
Chambersburg, PA 17201-9912

Email: info@oxo.com

Outside the U.S.

Please contact your local distributor or email info@oxo.com

REGISTRATION INFO:

For product registration, please visit us online at www.oxo.com/registration.aspx or call toll free at **1-800-545-4411**.

Please be advised that as part of our privacy policy we never sell or give away your private information.

