



Ride On UTV

060-ROT-58

Owner's Manual

*Product appearance and colors may vary from the photo.

⚠ WARNING

This product should only be assembled by an adult.

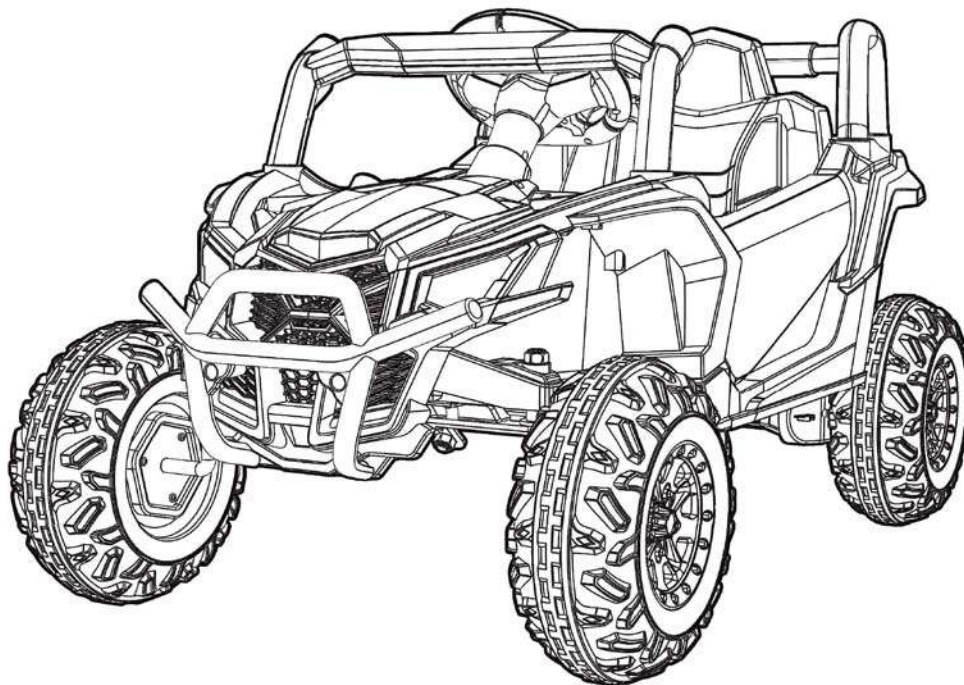

Welcome to Kidzone's world of ride-ons where fun and adventure await! Little ones have a blast riding our toys at home, in the park, or on the sidewalk.

At Kidzone, our goal is to make playtime more fun for kiddos, while ensuring comfort and safety. Our ride-ons help create joyful moments for the entire family that'll turn into forever memories!

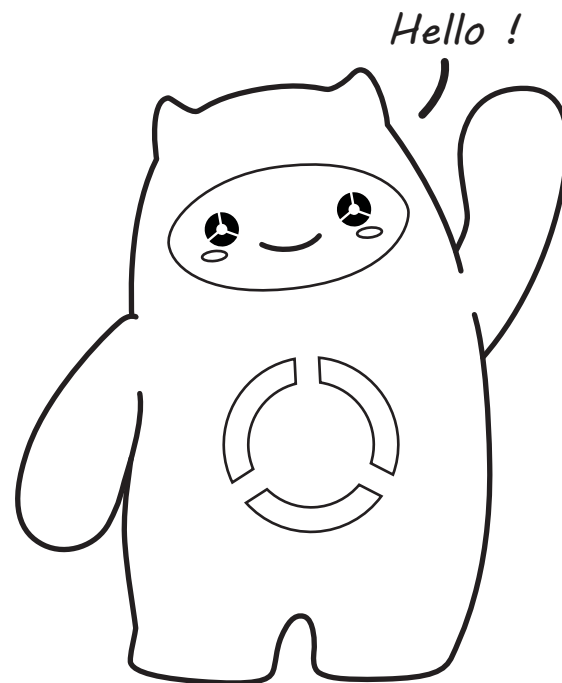

⚠ ATTENTION

This owner's manual contains important safety, performance, and maintenance information.

Read the manual before allowing your child to ride on the product.

Keep this manual for future reference.

Table of Contents

04	Safety Instruction
06	Product Specification
07	Parts and Accessories
09	Assembly Instruction
16	User's Instruction
19	User's Instruction Charging
20	Care and Maintenance
21	Troubleshooting
23	Warrenty Information

Safety Instruction



When using electrical product, basic safety precaution should always be followed including the following:

Failure to follow the safety instructions may result in property damage, serious injury or death.

ATTENTION

DISCLAIMER

- Manufacturer and seller expressly disclaim any and all liability for personal injury, property damage or losses, whether direct, indirect, or incidental, resulting from the incorrect attachment, improper use, inadequate maintenance, unapproved modification, or neglect of this product.

BASIC SAFETY

- This product is only designed to be used by children age 3+ years old.
- Do not exceed the maximum weight capacity of 66 lb / 30 kg.
- Do not allow more than one (1) rider.
- Adult and/or supervisors must instruct the user all common safety rules and safe practice.
- This product should be operate on a flat and smooth surface. Do not allow children to operate the ride-on toy near public road, raceway, near motor vehicle, on or near steep inclines or steps, in any slippery conditions including rain, snow, and ice, or at any potential dangerous places.
- Do not use this product as a traffic tool.
- Never leave children unattended with the ride-on toy. Close supervision is necessary when your children is using the product.
- If necessary, adult and/or supervisors should be responsible for setting up gate and barriers to ensure a safe environment for child rider.
- Be aware and alert children that hands, legs, hair, clothings, and loose items can potentially get caught in moving parts. Avoid placing body parts on moving parts and do not wear loose clothing while using the ride-on toy.
- Avoid using this product in tight environment to prevent damage to the product or injury to the user.
- This product does not equip with brakes. Do not use this product in areas that requires active braking to prevent possible rolls, crashes, or bodily injury.
- Do not use this product in the dark. Only operate this product during daytime or in a well lit area.
- Avoid continuously hitting into obstacle to prevent overheating or damaging the motor. Drive away or remove obstacle as soon as possible.
- For your child's safety, make sure the seatbelt is securely fasten and the rider is wearing personal protective equipment, such as helmet, when operating this product.

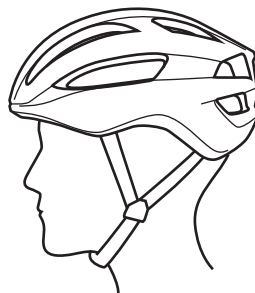

Correct Fitting

Make sure the helmet covers your forehead.



Incorrect Fitting

Forehead is exposed and vulnerable to injury.

CAUTION

Failure to follow these instruction may result in permanent damage to the product or parts.

CELL BATTERY AND RECHARGEABLE BATTERY HANDLING

- Do not mix old and new batteries.
- Do not mix alkaline, carbon-zinc, or rechargeable batteries.
- Permanent damage to the battery may occur if it is completely drained. Do not let the battery to drain completely.
- On average, you will need to charge the battery for 8 - 12 hours. Do not charge the battery for more than 20 hours. Failure to charge the battery as directed could cause permanent damage to the battery and void the warranty.
- Only an adult who has read and understands the safety instruction should handle, charge, and recharge the battery.
- Disconnect the battery if not used for a long period of time.

WARNING

Failure to follow these instruction may result in bodily harm, serious injury, or death.

CHOCKING HAZARD, ASSEMBLY WARNING

- This product contains small parts before assembly. Keep children away when assembling the ride-on toy. The assembly should only performed by an adult.
- Remove and dispose all protective materials, plastic bag, and packaging before assembly.
- This product should not be used by children under the age of 3 years old.

ELECTRIC SHOCK, FIRE HAZARD, FLAMMABLE AND EXPLOSIVE WARNING

- To protect against electrical shock, do not immerse cord, charger, transformer, battery or the product in water or other liquid.
- Do not drive the vehicle into any puddle or contact with any liquid to prevent electrical shock.
- Do not change, modify, or add any electrical wiring on the product. Alternations could potentially cause short circuit, a fire, or irreversible damage to the electrical system.
- Only use charger and battery provided or recommended by the manufacturer. Using the wrong type of battery or charger could cause a fire and potentially property damage and serious injury.
- Check the battery, charger, and connectors for any sign of excessive wear or damage each time you charge the battery. Do not use the charger or the battery if damages are present. Change and replace damage part before use.
- Do not lift or carry the battery by the wires or charger. You might damage the wires and case electric shock or fire.
- Do not charge more than 20 hours. You might over heat the battery and cause damage or a fire.
- Do not charge the battery outdoor.

CORROSIVE CHEMICAL, PRODUCT MATERIAL WARNING

- Contact or exposure to battery leakage may cause serious injury. If contact or exposure occurs to the skin or in the eyes, or if the chemical is swallowed, call medical emergency immediately.
- Battery posts, terminals, and related accessories contain lead and lead compounds which are toxic and corrosive. Never open the battery.
- This product can expose you to chemicals, including lead, which is known to the State of California to cause birth defects and or other reproductive harm, and Di (2-ethylhexyl) phthalate (DEHP), which is known to the State of California to cause cancer and birth defects or other reproductive harm. For more information, go to www.p65warnings.ca.gov.

Product Specification



Model no.	060-ROT-58
Battery	12v 7ah x1
Charger Output	DC 12v 1000mA
Battery Charge Time	8 - 12 hours
Speed	1 - 3.3mph (1.7 - 5.3km/h)
Suitable Age	3+ years old
Maximum User Weight	66 lb / 30 kg



Parts and Accessories

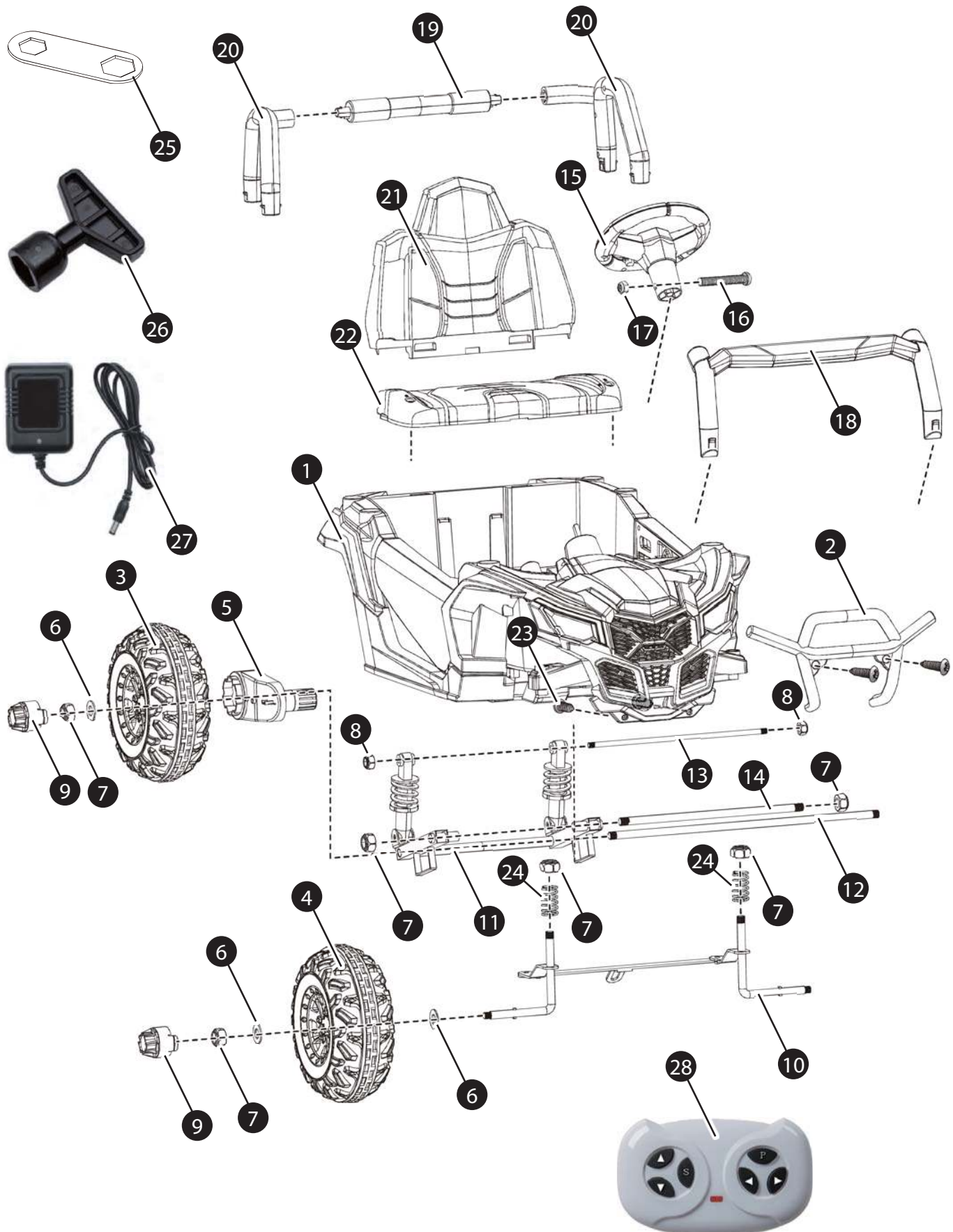

Parts and Accessories



Label	Part Name	Qty	Label	Part Name	Qty
1	Vehicle Body	1	15	Steering Wheel	1
2	Bull Bar	1	16	M5x32 Machine Screw	1
3	Drive Wheel	2	17	M5 Nut	1
4	Front Wheel	2	18	Front Roll Bar	1
5	Motor	2	19	Rear Roll Bar Linkage	1
6	M12 Washer	6	20	Rear Roll Bar Support	1 Pair
7	M10 Nut	8	21	Seat Backrest	1
8	M8 Nut	2	22	Seat	1
9	Hubcap	4	23	#4x12 Screw	4
10	Front Axle	1	24	Front Shock Sprint	2
11	Rear Shock Rack	1	25	Spanner	2
12	M12 Rear Axle	1	26	M10 Wrench	2
13	M8 Shock Shaft	1	27	Charger	1
14	M12 Middle Shaft	1	28	Remote Control	1



Assembly Instruction

⚠ WARNING

**This product should only be assembled by an adult.
Children can be harmed by small parts, sharp edges and points or by electrical items. Care should be taken when unpacking and assembling the product.**

Tools required (not included)

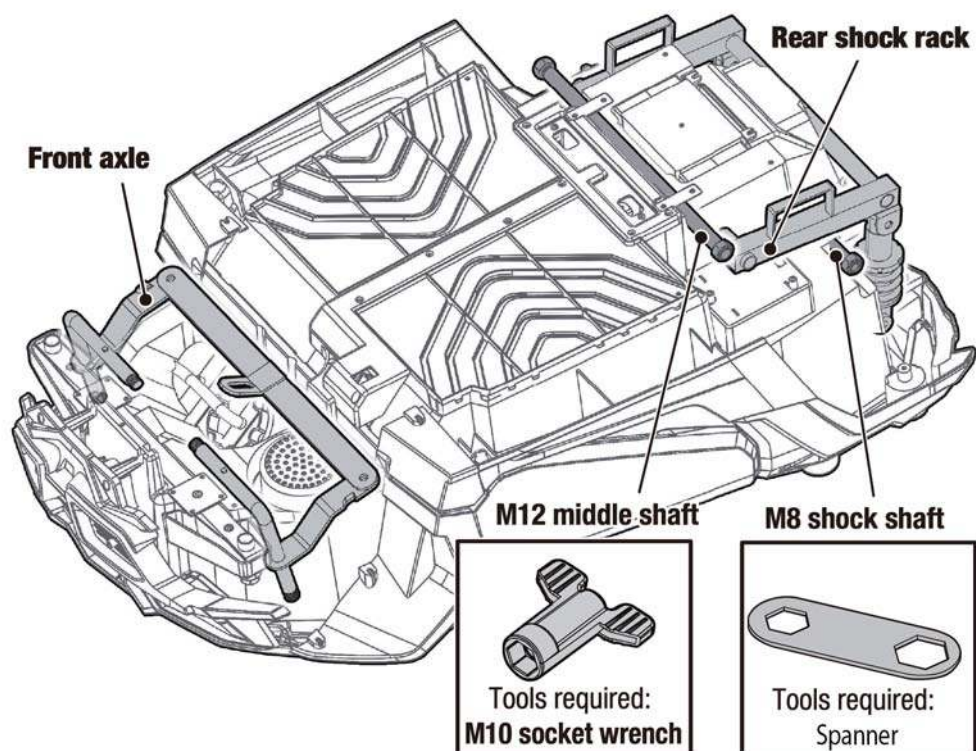
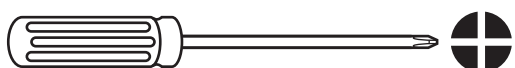

- Turn the vehicle body upside down.
- Unpack front axle, rear shock rack, M12 middle shaft and M8 shock shaft from the vehicle body. Keep the nuts for following assembling steps.

Assembly Instruction



2

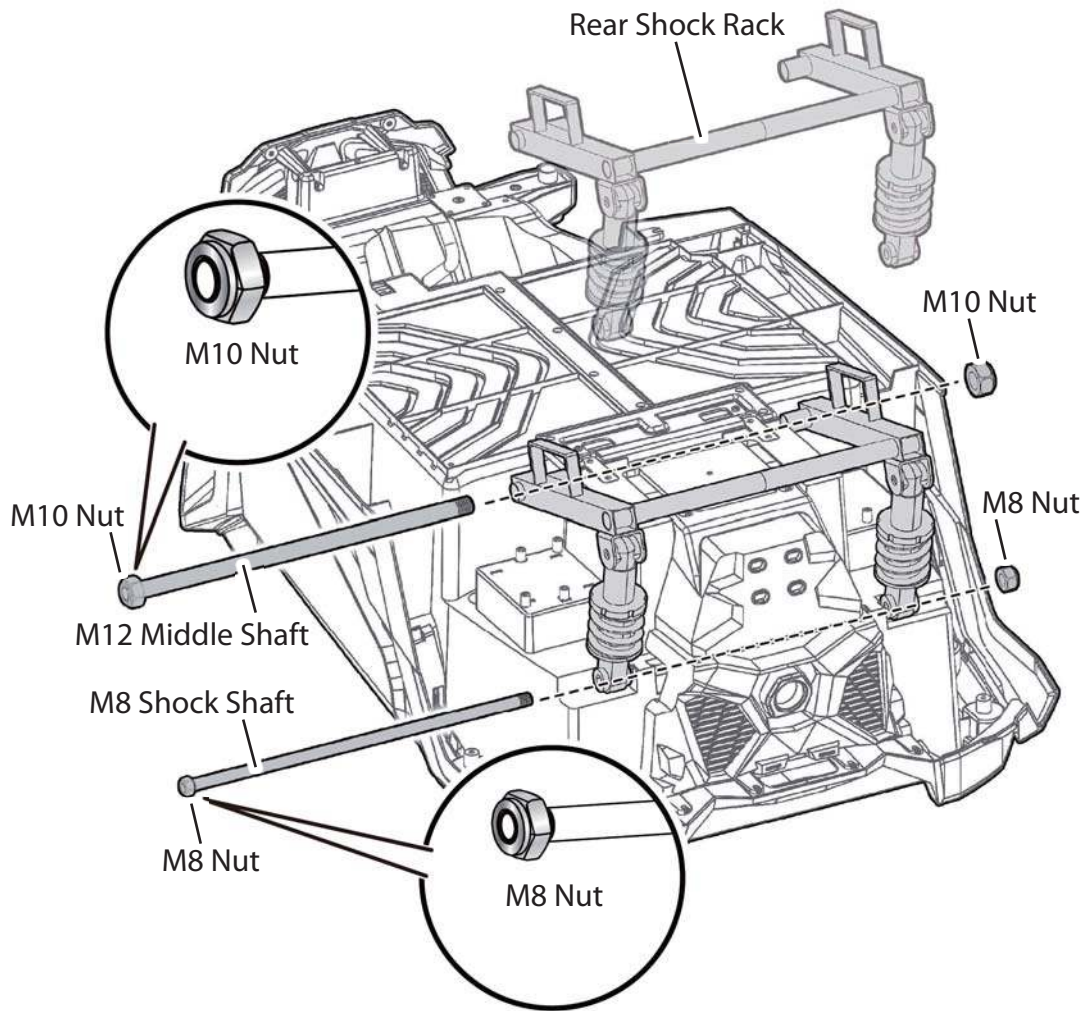

- Fit the rear shock rack to the body.
- Tighten a M10 nut to one end of the M12 middle shaft, then insert the m12 middle shaft through the rear shock rack and tighten a m10 nut to the other end of the shaft.
- Tighten a M8 nut to one end of the M8 shock shaft, then insert the m8 shock shaft through the rear shock rack and tighten a m8 nut to the other end of the shaft.



Assembly Instruction

3

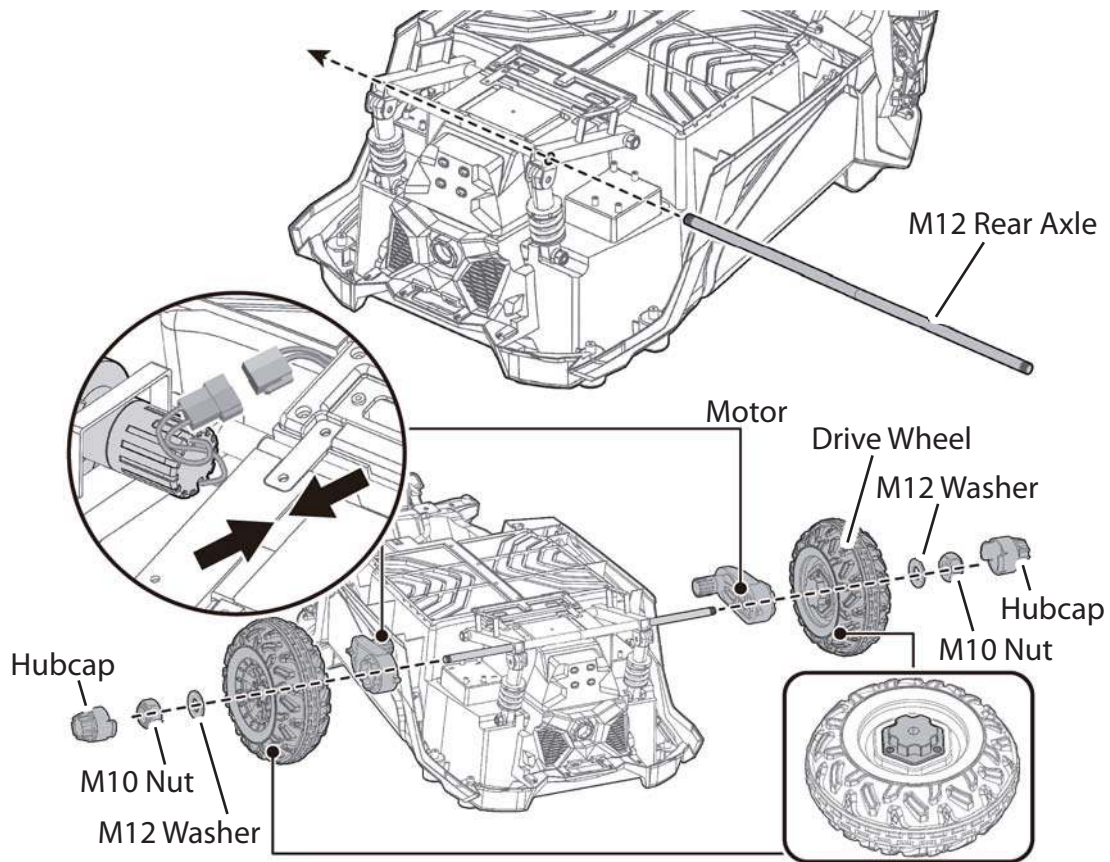

- Insert M12 rear axle into the rear shock rack.
- Assemble motors to both sides of the rear axle. Connect the connectors to that from the vehicle.
- Slide drive wheels into the rear axle and align it to the motors.
- Tighten drive wheels using M12 washers and M10 nuts.
- Attach hubcaps to the wheels.

4

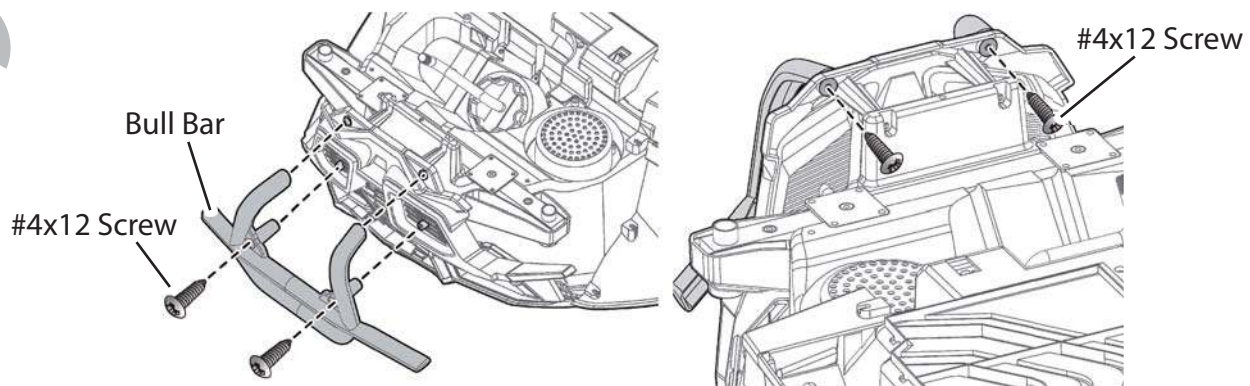

- Assemble bull bar to the front of the vehicle body.
- Secure the bull bar in place with #4x12 screws.

Assembly Instruction

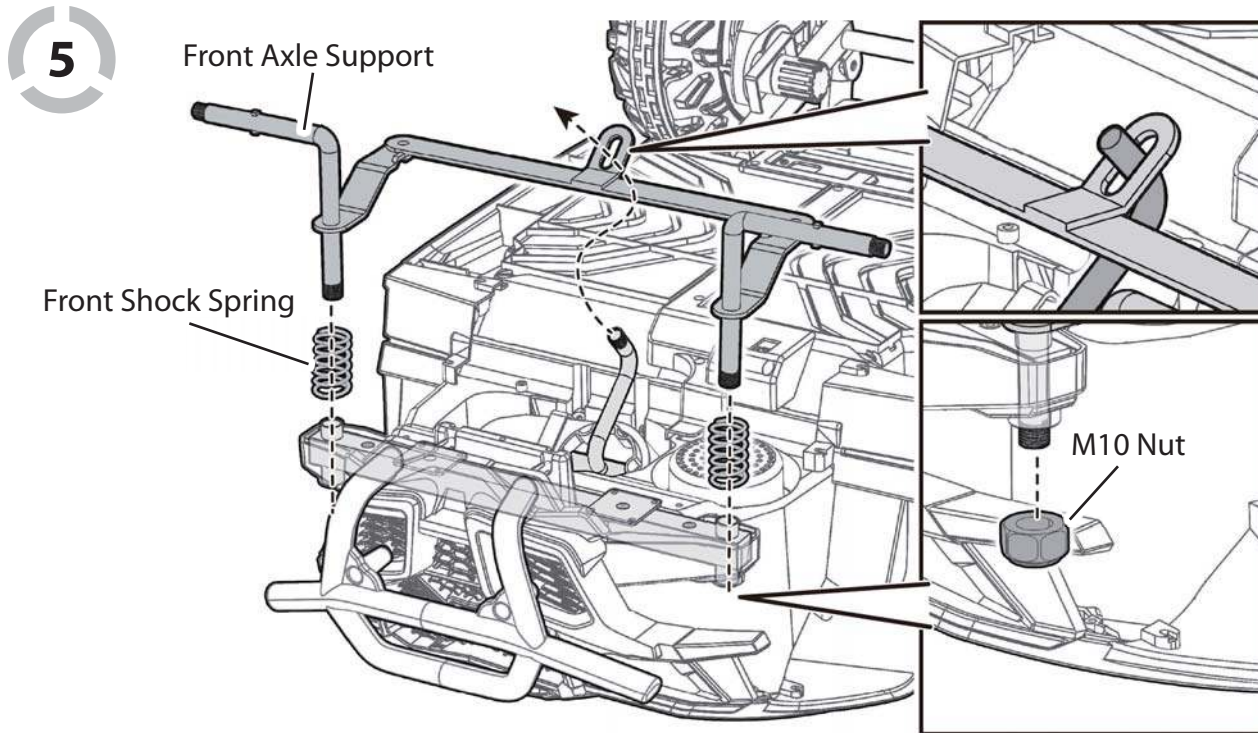

- Assemble front axle support and front shock spring to the vehicle body.
- Ensure the steering column pass through the hole on the steering linkage.
- Secure the front axle support in place with M10 nuts.

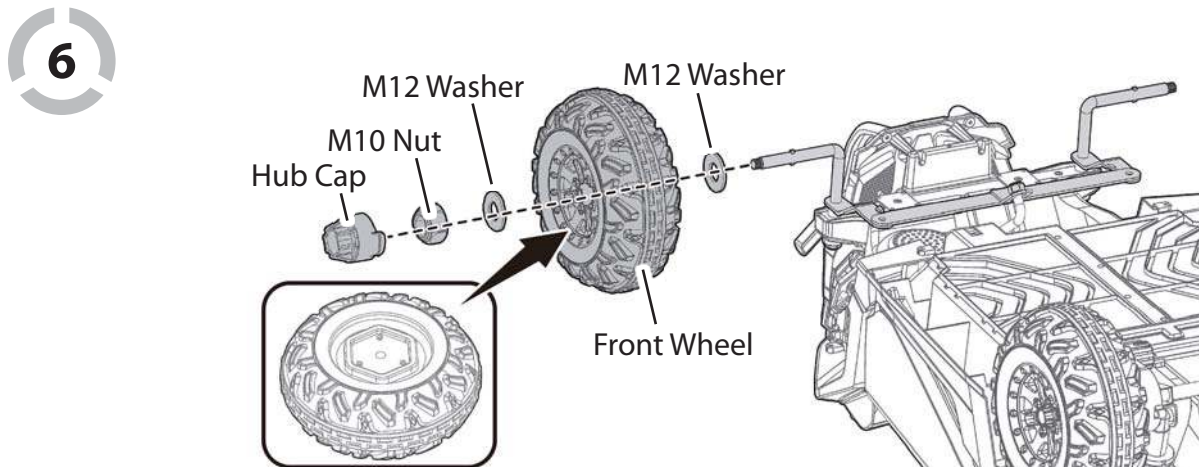

- Slide M12 washer to the front axle.
- Slide the front wheel to the front axle.
- Secure the front wheel in place with another M12 washer and a M10 nut.
- Attach hub cap to the wheel.
- Repeat the same step on the other side of the front axle.



Assembly Instruction

7

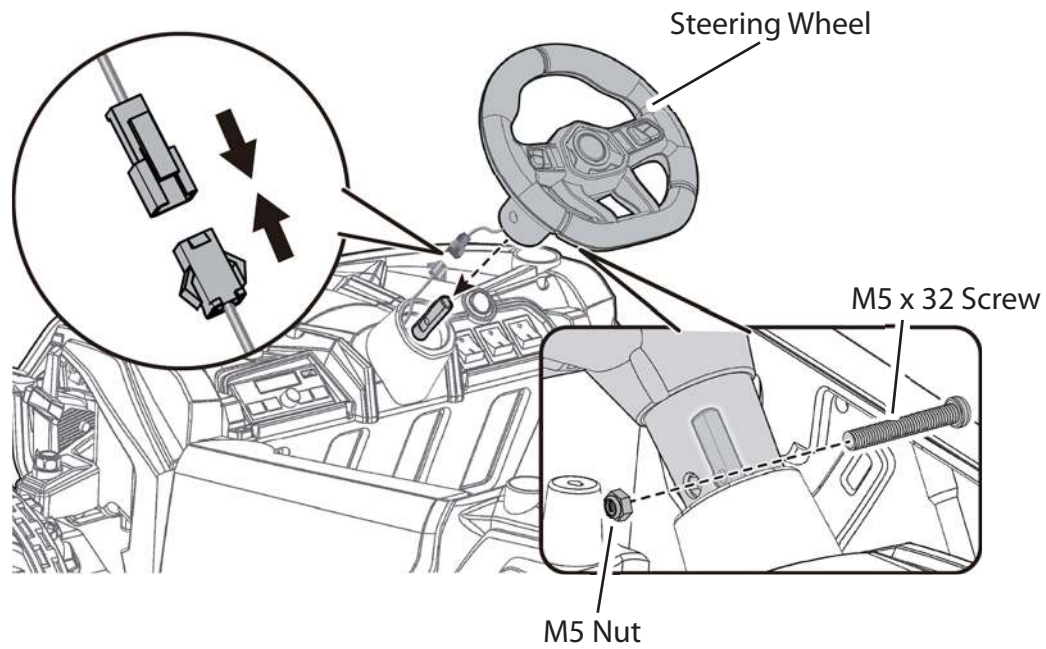

- Connect the connector from the steering wheel to that of the vehicle body.
- Insert the steering wheel to the steering column.
- Secure the steering wheel in place with M5x32 machine screw and M5 nut.

8

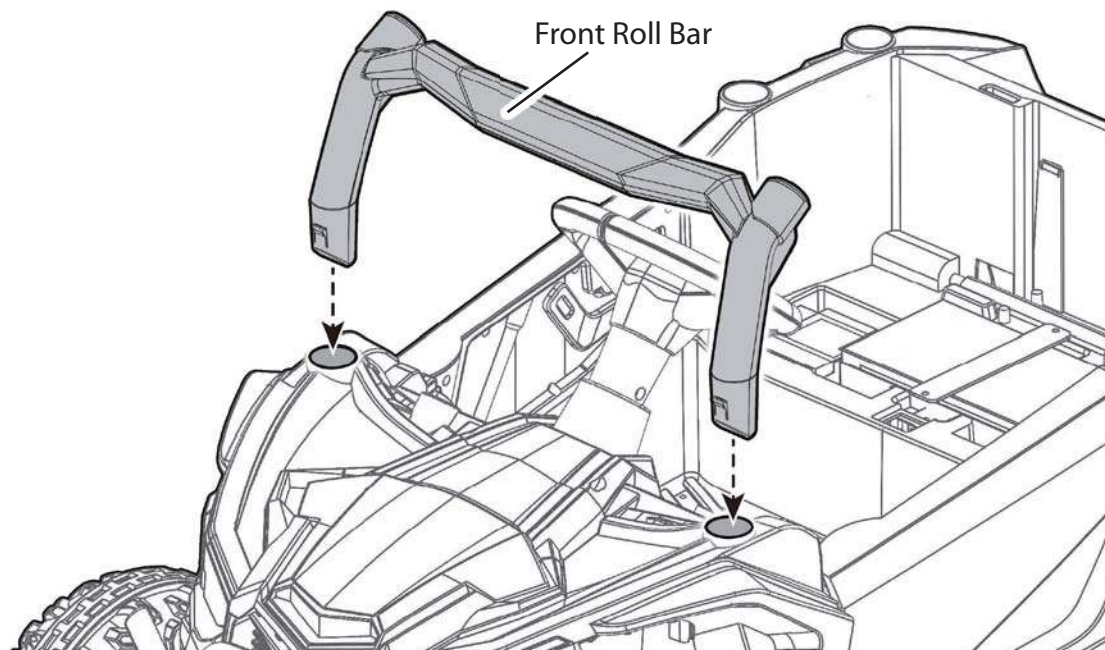

- Attach front roll bar onto the vehicle body.

Assembly Instruction



9

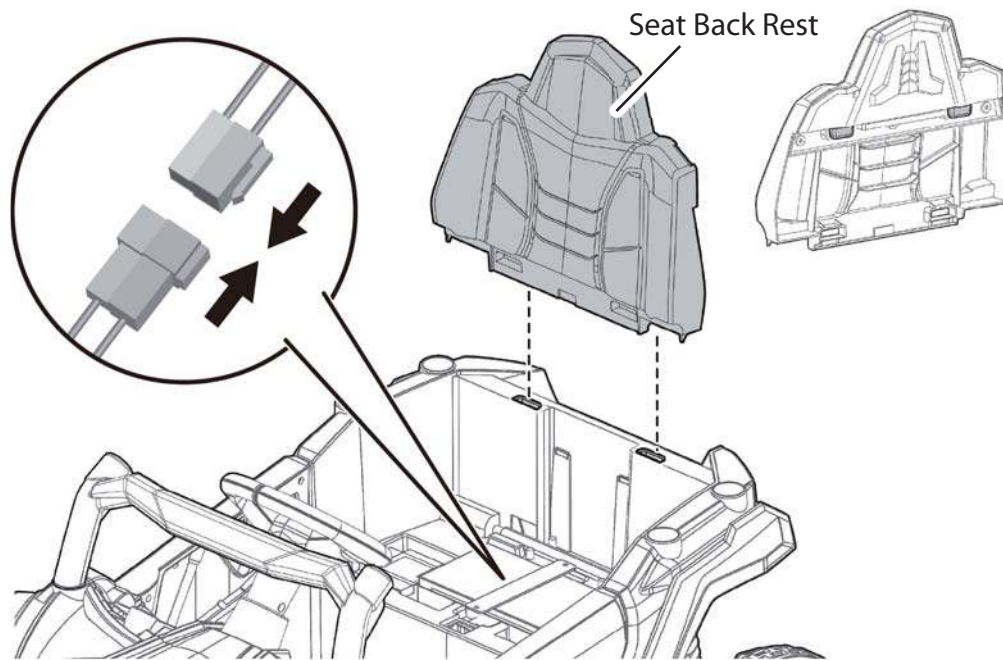

- Connect the battery connectors.
- Align and attach the tabs on the backrest to the vehicle body.

10

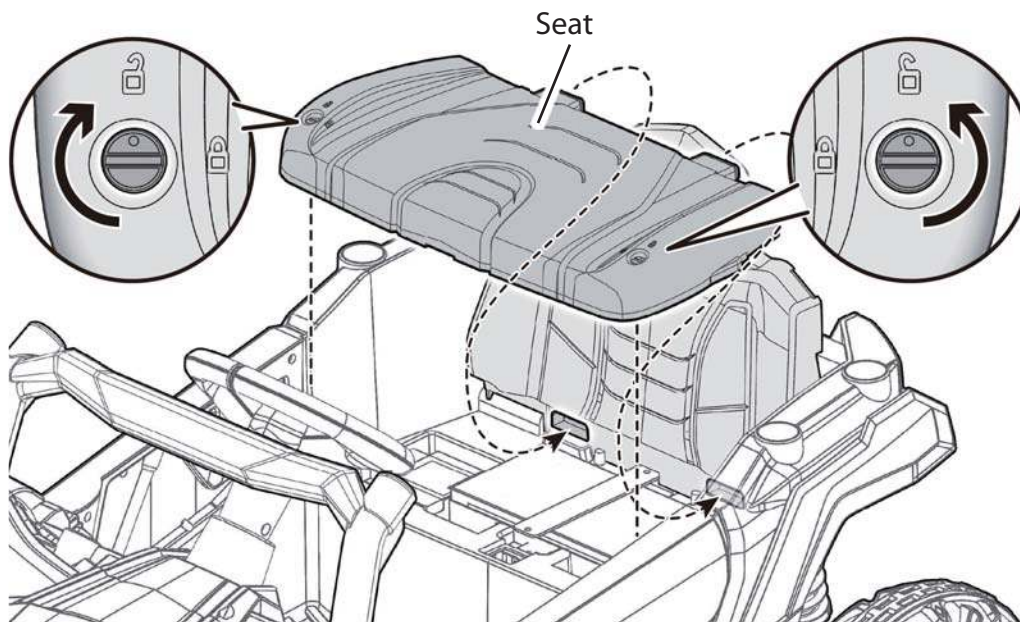

- Assemble the seat to its backrest and lock it in place on the vehicle body.



Assembly Instruction

11

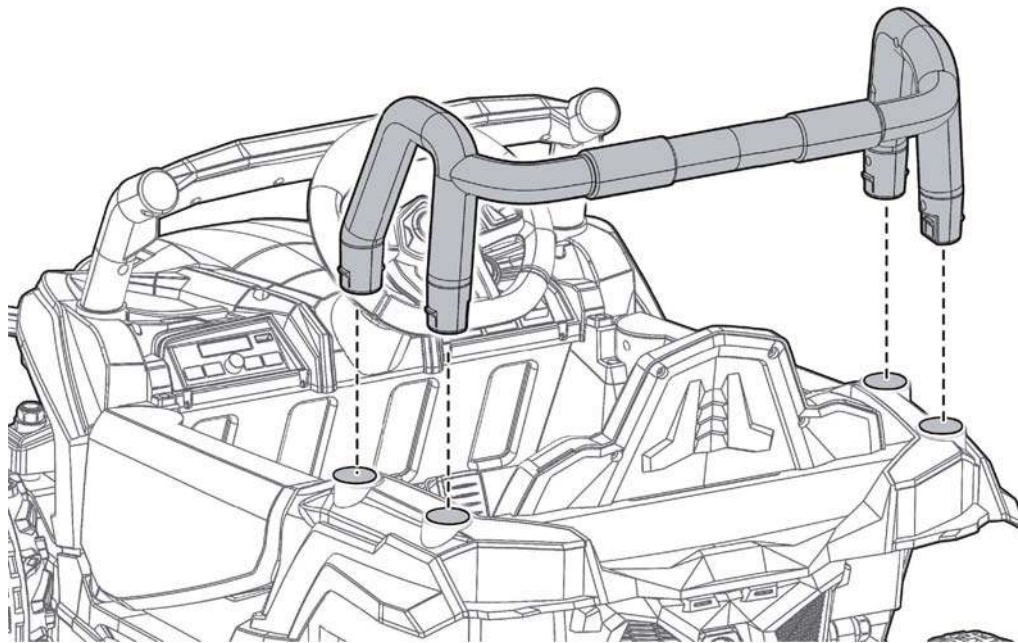
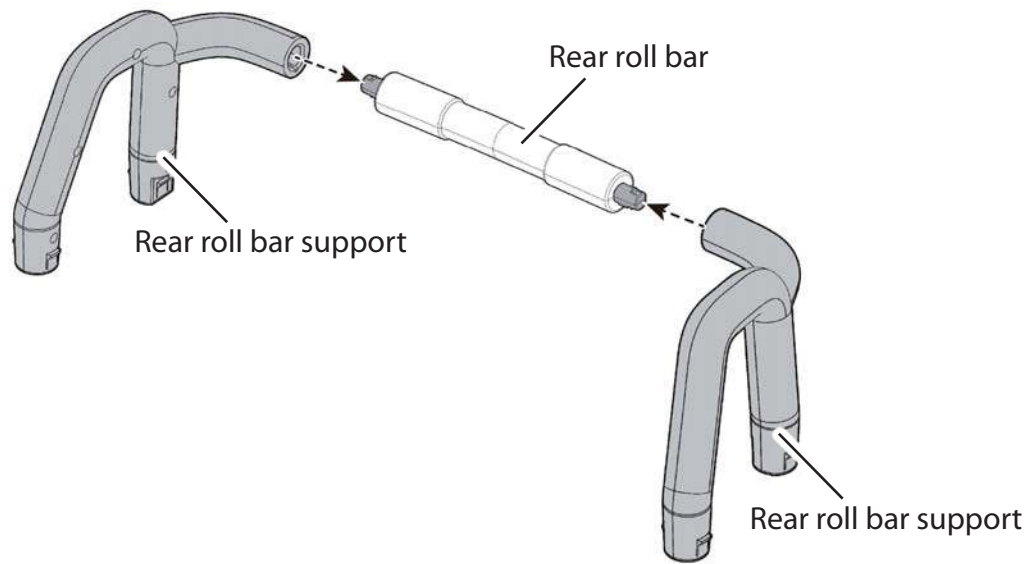

- Assemble the rear roll bar.
- Attach the whole rear roll bar assembly onto the vehicle body.

User's Instruction

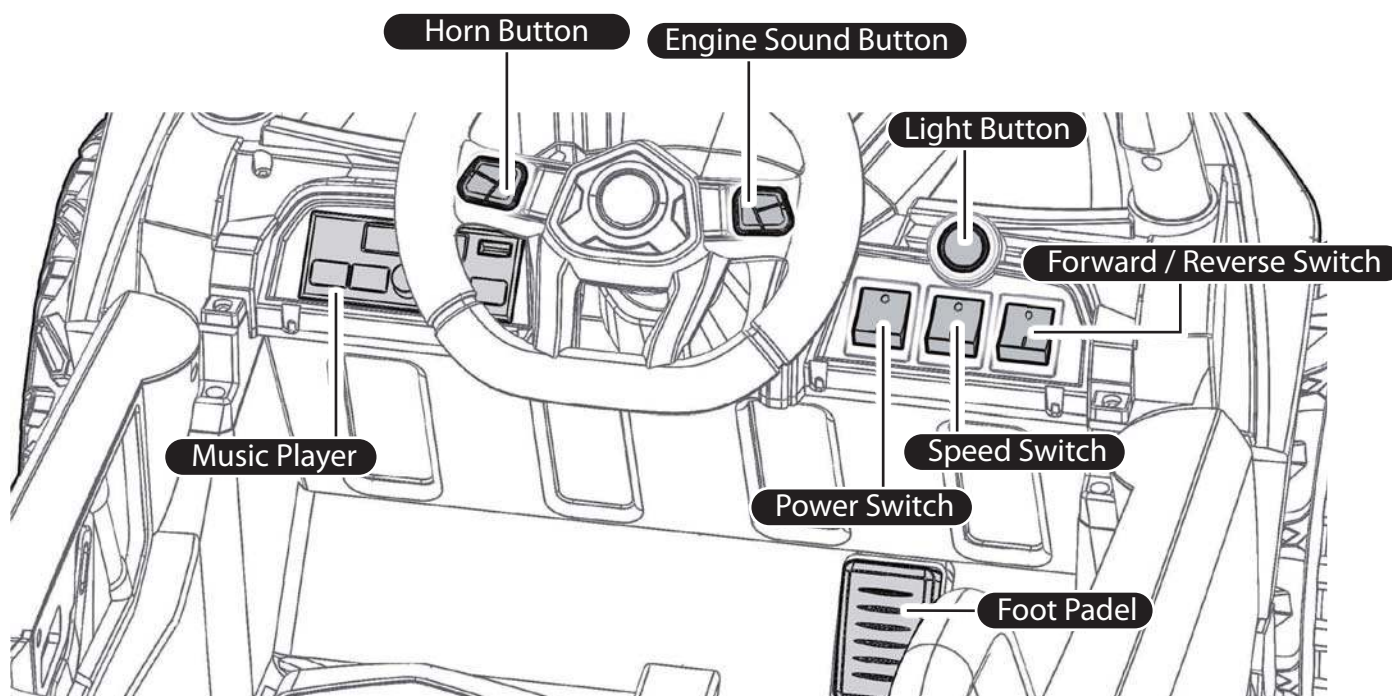

Control the vehicle

Power Switch

Flip the switch to turn ON / OFF the vehicle.

Speed Switch

Flip the switch to select high / low speed mode.

Forward / Reverse Switch

Flip the switch upward for forward driving, downward for reversing.

Foot Padel

Press on the foot padel to drive the vehicle.
Release the pedal to slow down and stop the vehicle.

Light Button

Press the button to turn ON / OFF the light.

Horn / Engine Sound Button

Press the button to play horn / engine sound.
Press the button to the next song when playing music.

⚠ CAUTION

Do not change forward / reverse until the vehicle comes to a complete stop. Sudden change in direction may result in permanent damage to the motor.



User's Instruction

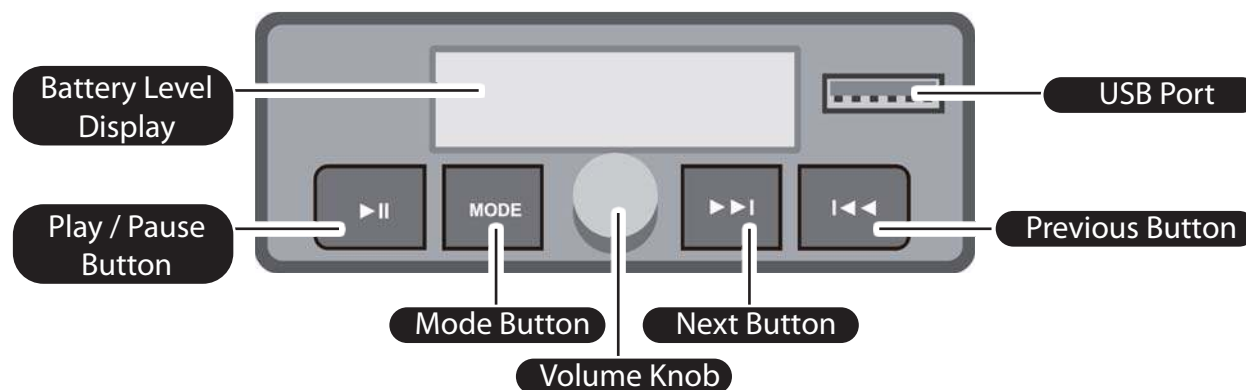

Multimedia player

Battery Level Display

Indicate the vehicle battery voltage level.

Volume Knob

Turn the volume knob clockwise to increase volume, counter-clockwise to decrease volume.

Play / Pause Button

Press the button to play or pause audio.

FM Radio mode: Press and hold the play button to search for radio station.

Mode Button

Press the button to switch between FM radio, USB input and bluetooth connection.

Next Button

Press the button to select next track / next radio station.

Previous Button

Press the button to select previous track / previous radio station.

USB Port

Connect your portable device to play audio through the ride on's speaker.

Only support MP3 files.

Bluetooth Connection

1. Place your audio device near the multimedia player.
2. Press the mode button until you hear a cue voice.,
3. On your audio device, open bluetooth setting and select device named "Kidzone Ride-On"
4. There is a tip tone after successful pairing, select and play your desired music.

User's Instruction



Using the remote control

The remote control should only be used by an adult.

Changing the remote control battery

The remote control requires 2 AAA 1.5v batteries. (not included)

- Remove the cover on the back side of the remote control.
- Replace old batteries with 2 new AAA 1.5v batteries in correct polarity.
- Put the cover back in place.

WARNING

The battery should only be changed by an adult.
Do not mix old and new batteries.
Do not mix alkaline, carbon-zinc, or rechargeable batteries.

Pairing the remote control

The remote control needs pairing for the first time usage or after replacing the battery.

- Press and hold the forward and reverse button for 3 seconds, the indicator will flashes.
 - Turn on the power of the vehicle, the indicator should change to solid light after successful pairing.
- If failed to pair, remove and replace the battery from the remote control and repeat the pairing steps.

Control the Vehicle

- Press the directional buttons to move the vehicle.
- Press the "P" button to enable emergency brake. All running function will be disabled once the button is pressed. Press the "P" button again to enable other functions.
- Press the "S" button to switch between high and low speed

NOTE:

The remote control will goes into power saving mode if not used after 10 seconds.
Remote control input will always be prioritized over foot pedal input.



User Instruction (Charging)

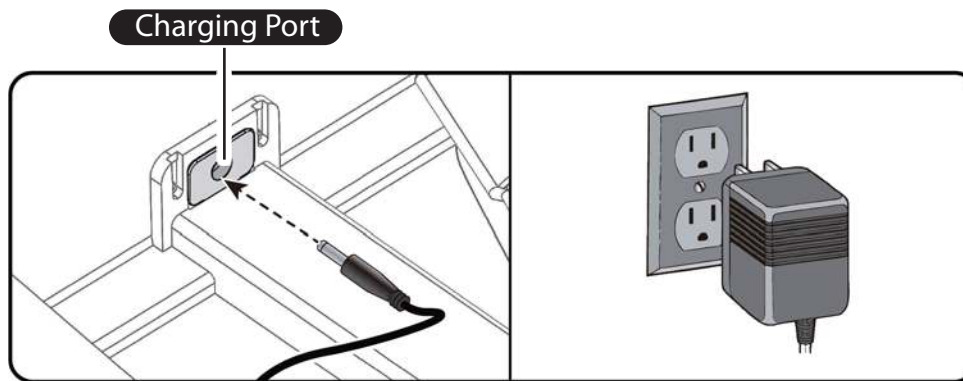

WARNING

The battery should only be charged by an adult.

Charging the battery

1. Connect the charger to the charging port on the vehicle.
 2. Plug the charger into a wall power outlet.
- The vehicle must be OFF when charging.
 - Recharge the battery if the vehicle operates slowly.
 - The charging protection will cut off all functions of the vehicle when charging.

NOTE:

- Damage to the battery may occur if it is completely drained.
- Charge the battery for about 8 - 12 hours.
- Do not charge the battery for more than 20 hours.
- Charge the battery at least once every 3 months even if not operating the vehicle for a long time to maximize the battery life.
- Do not charge or store the battery upside down.
- Keep the charger and battery away from flames, sparks, or any flammables.
- Do not charge the battery outdoor.
- Plug the charger directly into a wall outlet. Do not use an extension cord.

Care and Maintenance



- Check the product regularly and make sure there is no missing or loose parts. Re-tighten any loose parts if necessary.
- Make sure there is no cracked or broken plastic parts.
- Store the product away from heat source when not using, cover it with a tarp and away from wet weather.
- Turn off the product and disconnect the battery if the product is not use for a long period of time.
- Clean the vehicle with a cloth. Use a non-wax furniture polish to restore shine to plastic parts. Do not use abrasive cleaner.
- Do not wash the product with a hose or immerse any parts in water or other liquid.
- Regularly charge the battery to prolong the battery life.
- Do not store the product near heat source, such as stoves and heaters. Plastic parts may melt under high temperature.

Battery Disposal

- The battery will eventually lose the ability to hold a charge. Depending on the amount of use, and varying conditions, the batter should operate for 1 to 3 years.
- Unusable battery contains lead acid (electrolyte) must be desposed or recycle properly and legally. It is illegal in most area to incinerate lead acid batteries or dispose them in landfills. Take the battery to a federal or state approved lead acid battery recycler such as local automotive battery retailer.
- Do not throw the battery away with your regular household waste.



Troubleshooting

Problem	Possible Reason	Solution
Vehicle does not move	Low Battery	Fully charge the battery
	Disconnected / Badly connected battery	Reconnect the battery
	Failed battery / motor	Contact Customer Service
	Tripped thermal fuse	Turn off the vehicle and wait for at least 20 seconds to reset the fuse
Vehicle does not run very long	Low Battery	Fully charge the battery
	Old / Damaged Battery	Replace battery if necessary
Vehicle runs very slow	Low Battery	Fully charge the battery
	Old Battery	Replace battery if necessary
	Vehicle is overloaded	Make sure user's weight is under 66 lb / 30 kg
	Vehicle is being used in harsh environment	Avoid using the vehicle in harsh environment

Troubleshooting



Problem	Possible Reason	Solution
Vehicle needs a push to go forward	Poor wire connection	Check if the battery connectors are firmly connected. Contact Customer service if necessary
	"Dead spot" on motor	Contact customer service
Loud grinding sound or clicking sound from the motor or gear box	Damaged motor or gear box	Contact customer service
Battery does not charge	Disconnected / Badly connected battery	Reconnect the battery
	Disconnected / Badly connected charger	Make sure the charger is firmly plugged into the power source and connected to the charging port
	Charger not working	Contact customer service
Vehicle does not stop	Damaged equipment	Contact customer service
Charger feels warm with charging	Normal	N/A

Limited Term Warranty (One Year from Date of Purchase)

WARRANTY TERMS

KIDZONE warrants that its merchandise are free from manufacturing defects (workmanship and/or material) and will either give credit or replace defective parts for a period of up to one (1) year from the date of purchase in accordance with the conditions set forth below. If a manufacturing defect is found, KIDZONE should be notified promptly of the defect and supplied a copy of the invoice and delivery ticket. Inspection by a KIDZONE employee or representative may be necessary to verify that a manufacturing defect exists, or you may be required to submit samples to KIDZONE along with a digital image of the defects. If replacement is required in accordance with this warranty and the defective material or merchandise has been discontinued or unavailable, KIDZONE reserves the right to select and supply similar merchandise or offer full credit for the merchandise; otherwise the same material or merchandise will be supplied for replacement purposes. This warranty is made solely to the retailer and is not transferable under any circumstances. It is the retailer's responsibility to contact KIDZONE with a claim. We will not handle claims from consumers directly; all requests must go through the retailer who sold the merchandise to the consumer. We advise all retailers to retain invoices for a minimum of one (1) year for warranty purposes. This warranty supersedes and replaces all implied warranties of merchantability and use for particular purpose. No representative, employee, agent or any other person is authorized to assume for KIDZONE any additional liability or responsibility in connection with KIDZONE's merchandise except as described above. Implied warranties or merchantability and fitness of the merchandise are limited to a period of one (1) year from the date of purchase. In no event shall KIDZONE be liable for indirect, consequential or incidental damages of any kind.

ADDITIONAL CONDITIONS

THE FOLLOWING EXAMPLES ARE NOT MANUFACTURER'S DEFECTS:

- Colors may vary slightly from the photo because of photography and printing tolerances.
- Sizes stated in U.S. standard measurements may vary slightly due to product are manufactured using the metric system.
- No returns for buyer's remorse.
- No returns - other than stated above will be accepted.

ADDITIONAL CONDITIONS

WARRANT IS VOID FOR ANY OF THE FOLLOWING CONDITIONS:

1. Improper maintenance or improper use resulting in damage.
2. Any product modifications by dealer, consumer, or other parties not authorized by KIDZONE will void this warranty.
3. Floor samples sold or products designated "AS IS" at the time of purchase are not covered by the warranty
4. Warranty does not cover minor variations or differences between floor samples or printed illustrations and your product.
5. Cost of packaging and shipping to and from KIDZONE is not covered by the warranty unless expressly arranged by KIDZONE.
6. This warranty covers only articles of appliances intended for residential use only, does not cover any industrial, commercial, institutional or Rental use.
7. Dissatisfaction due to buyer's remorse.
8. Normal wear and tear.
9. Damages incurred during transportation.
10. Damages incurred during assembling or maintenance.
11. Damage incurred by accidents or abuse.

FCC Statement

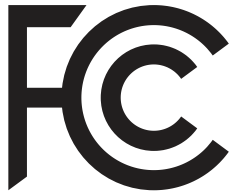

Controller: Remote
Model: JR1602FCC
FCC ID: 2AWOBJR1602
Vehicle: Ride on UTV
Model: 060-ROT-58
FCC ID: 2BBEC-060-ROT-58

Changes or modifications not expressly approved by the party responsible for compliance could void the user's authority to operate the equipment. This equipment has been tested and found to comply with the limits for a Class B digital device, pursuant to Part 15 of the FCC Rules. These limits are designed to provide reasonable protection against harmful interference in a residential installation. This equipment generates uses and can radiate radio frequency energy and, if not installed and used in accordance with the instructions, may cause harmful interference to radio communications. However, there is no guarantee that interference will not occur in a particular installation. If this equipment does cause harmful interference to radio or television reception, which can be determined by turning the equipment off and on, the user is encouraged to try to correct the interference by one or more of the following measures:

- Reorient or relocate the receiving antenna.
- Increase the separation between the equipment and receiver.
- Connect the equipment into an outlet on a circuit different from that to which the receiver is connected.
- Consult the dealer or an experienced radio/TV technician for help.

This device complies with part 15 of the FCC Rules. Operation is subject to the following two conditions:

- (1) This device may not cause harmful interference, and
- (2) this device must accept any interference received, including interference that may cause undesired operation.

The device has been evaluated to meet general RF exposure requirement. The device can be used in portable exposure condition without restriction.

This Product conforms to toy safety standards CPSIA and ASTM-F963.

Distributed By: Align Inc.
Address: City of Industry, CA 91748 United States
Contact: 1-800-946-6151



© All copyright of this document belongs to KIDZONE.
This document may not be printed, translated, reproduced, or distributed in whole or in part without written permission from KIDZONE.



kidzone[®]

www.kidzonetoy.com

