

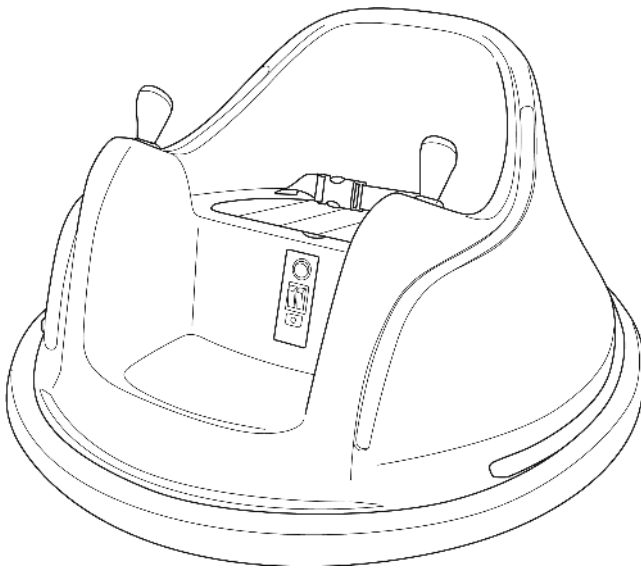

Instruction Manual

RIDE ON BUMPER CAR 360 ROTATION (12V)

Item number: 060-ROT-06V2



Note: Product appearance and colors may vary from the photo.

⚠ ATTENTION



This vehicle is packed with the battery disconnected. Connect the battery before use.

This manual contains important safety, performance and maintenance information. Read the manual before allowing your child to ride your new electric ride-on toy. Keep this manual properly for future reference.

Safety Instruction

When using electrical product, basic safety precaution should always be followed including the following

Read all Instructions before operating this product

⚠ WARNING:

- To Protect against electrical shock, do not immerse cord, charger, transformer, battery, or the product in water or other liquid.
- Only use charging devices, transformer, and battery provided or recommended by the manufacturer.
- For your children's safety, the product should be assembled by adult.
- This toy is not intended for children under 18 months.
- Closely adult supervision is necessary when your child is operating this product.
- Disconnect the battery if not used for a long time.
- Do not use this product as a traffic tool.
- To reduce the risk of injury, adult supervision is required. Never use in roadways, near motor vehicles, on or near steep inclines or steps, swimming pools or other bodies of water; always wear shoes, and never allow more than 1 rider.
- Do not use this product on slippery surface.
- Always keep hands, hair, and clothing away from moving parts.
- Maximum users' weight for this product is 66 lb/ 30 kg.
- Do not change, modify or add any electrical wiring on this product.
- Charge the battery at least once a month even not operating the vehicle to maximize the battery life.
- Avoid using this product in tight environment to prevent damage to the product or injury to the user.
- Do not use this product in the dark. Only operate this product during daytime or well-lit area.
- For your child's safety, please make sure the seat belt is securely fasten when operating this product.
- Personal protective equipment such as helmet is needed when operating this product.

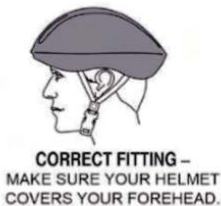

⚠ Avoid continuously hitting into obstacle to prevent overheat or damage to the motor; Drive away or remove obstacle as soon as possible.

⚠ WARNING:

PREVENT FIRE

- Never modify the electrical system. Alterations could cause a fire resulting in serious injury and could also ruin the electrical system.
- Use of the wrong type of battery or charger could cause a fire or explosion resulting in serious injury.
- The battery must be handled by adults only. The battery is heavy and contains sulfuric acid (electrolyte).
- Dropping the battery could result in serious injury.
- Never allow children to charge the battery. Battery charging must be done by adults only.
- Never lift or carry the battery by the wires or connector. This can damage the battery and possibly cause a fire resulting in serious injury. Lift and carry the battery by the case only.
- Examine the battery, charger and their connectors for excessive wear or damage each time you charge the battery. If damage or excessive wear is detected, do not use the charger or the battery until you have replaced the worn or damaged part.

⚠ WARNING:

Manufacturer and seller expressly disclaim any and all liability for personal injury, property damage or loss, whether direct, indirect, or incidental, resulting from the incorrect attachment, improper use, inadequate maintenance, unapproved modification, or neglect of this product.

⚠ WARNING: Stop operating this product whenever it stuck under any circumstances.

⚠ WARNING: Friction Hazards! Do not operate this product on carpets or rugs, it may cause burn or fire if over run or over spin. This product has automatic cut-off function if overcurrent, overloaded, or operated incorrectly, wait for 10 - 15 seconds to reactivate this product automatically.

Product Specification

Motor: 2 x 12V, 380 / 20000rpm

Battery: 12V 4.5 AH

Charger : 12V 500 MA

Speed: 0.7 - 1.3 mph (1.1 - 2.1 km/h)

Suitable Age : 18 - 72 months

Maximum Users'Weight: 66 lb / 30 kg

Dimension : 28.35"x28.35"x16.93" (72x72x43cm)

Battery Charging Time: 8 - 12 hours

First Charging Time:4- 5 hours

Max Charging Time:12 hours

Battery (Temperature Tolerance): 104°F

Parts and Feature

1. Vehicle Body
2. Seat Cover
3. Seat Belt
4. Control Stick
5. Power Switch
6. Light Switch
7. Speed Switch
8. Charging Port
9. Remote Control
10. Lighting

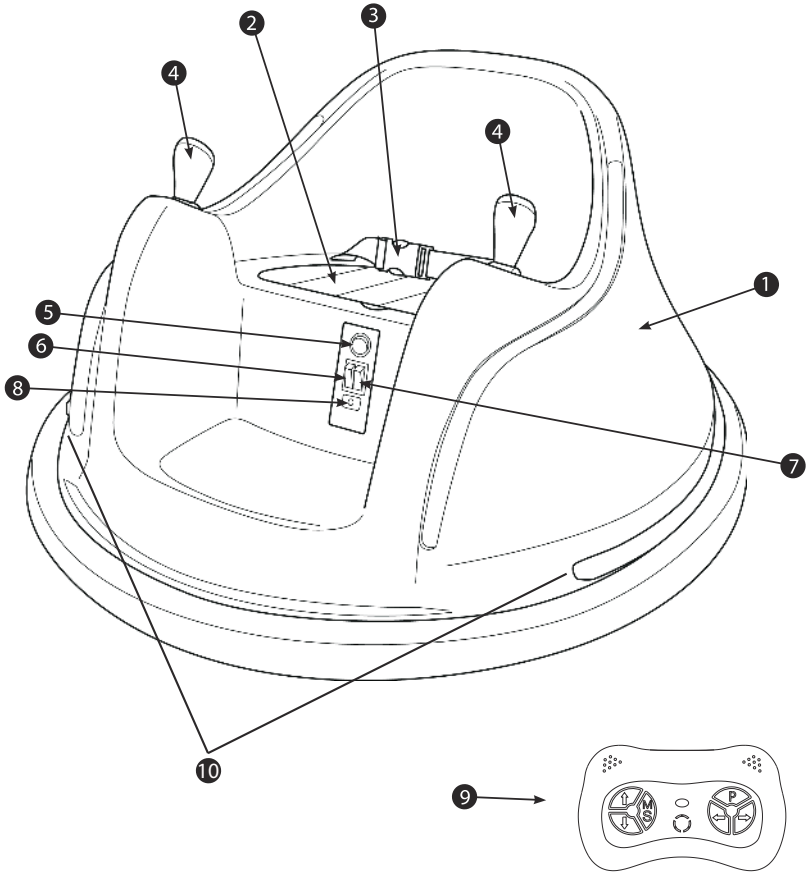

User Instruction

Before activating this vehicle

- Unscrew to detach the seat cover.
- Connect the battery terminals. (Red terminal connect to Red connector, Black terminal connect to Black connector).
- Attach the seat cover and tighten the screws.

– low speed

= high speed

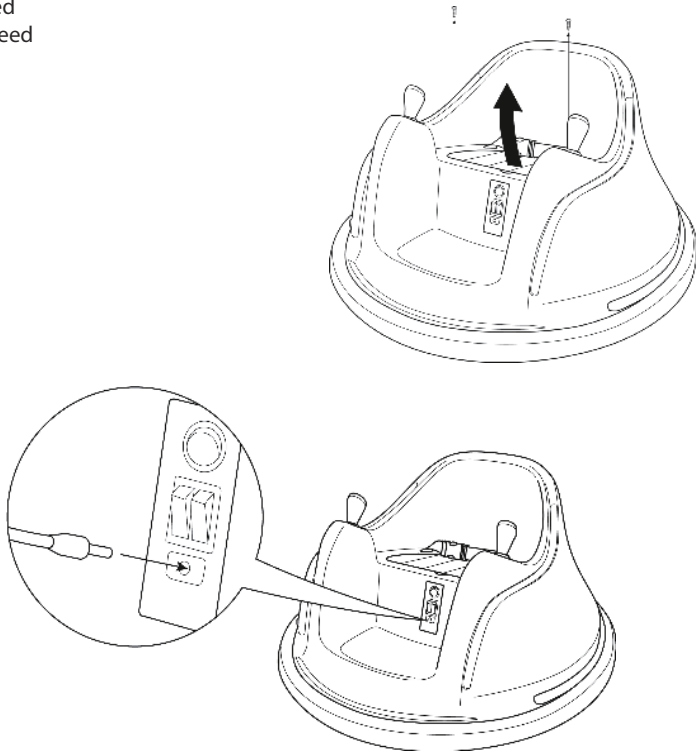

Charging the battery

⚠ WARNING! The battery should only be charged by adult. The battery is not replaceable.

- Plug the charger to the charging port. (the charger indicator turns red when charging, turns green after charging completed).
- Fully charge the battery for 8 - 12 hours.

⚠ Do not charge the battery for more than 20 hours.

⚠ Make sure the battery and charger are not damaged. Do not charge if any sign of wear or damage is found.

Note: charge the battery at least once a month even not operating the vehicle to maximize the battery life.

User Instruction

Operating this vehicle.

To turn on the vehicle, press the power switch "I".

To turn off the vehicle, press the power switch "O".

To select low speed, press "--" speed switch.

To select high speed, press "=" speed switch.

To light on the vehicle, press light symbol switch.

To move the vehicle forward, push both control sticks forward at the same time.

To move the vehicle backward, pull both control sticks backward at the same time.

To left turn the vehicle forward, push the right control stick forward.

To right turn the vehicle forward, push the left control stick forward.

To left turn the vehicle backward, pull the right control stick backward.

To right turn the vehicle backward, pull the left control stick backward.

To left spin the vehicle, pull the left control stick backward and push the right control stick forward at the same time.

To right spin the vehicle, push the left control stick forward and pull the right control stick backward at the same time.

To stop the vehicle, release both control sticks and returns them to the center position.

"S" button for speed selection

Low speed: default and 1 solid red light

Middle speed: press once, 2 solid red lights

High speed: press again, 3 solid red lights

Back to low speed: press again

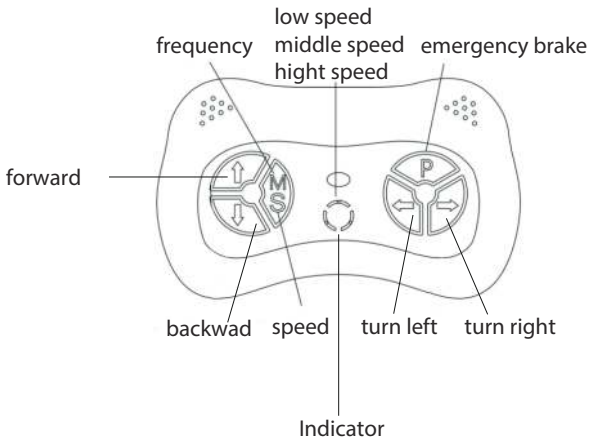

Using the remote control

The remote control should only be used by adult.

The remote control overrides the manual control from the vehicle.

Frequency Matching

To activate this vehicle, match the remote control frequency to the vehicle at the first time or after changing the batteries is required.

- Insert batteries into the remote control.
- Press the "M" button for 2 - 4 seconds, the red indicator flash.
- Turn on the power of the vehicle, the indicator changes to solid red.

If failed to match, remove and replace the batteries from the remote control and repeat the above steps.

NOTE : The remote control goes into sleep mode after 10 seconds of idle time.

Change Battery

Remove the cover on the back of the controller and insert two AAA (LR03) batteries in correct polarity.

Do not mix old and new batteries.

Do not mix alkaline, standard (carbon-zinc), or rechargeable batteries.

Control the vehicle

- For your child's safety, please make sure the seat belt is securely fastened when operating this vehicle.
- To move the vehicle forward, press the up arrow switch.
- To move the vehicle backward, press the down arrow switch.
- To left turn the vehicle forward, press the up arrow switch followed by the left arrow switch.
- To right turn the vehicle forward, press the up arrow switch followed by the right arrow switch.
- To left turn the vehicle backward, press the down arrow switch followed by the left arrow switch.
- To right turn the vehicle backward, press the down arrow switch followed by the right arrow switch.
- To left spin the vehicle, press the left arrow switch.
- To right spin the vehicle, press the right arrow switch.
- To stop the vehicle, release all switches.
- To enable emergency brake, press the "P" switch , all 3 red lights flash and all switches stop working. Press the "P " switch again to activate the vehicle.

Bluetooth connection

To connect your mobile device to the vehicle, turn on the Bluetooth and select "Kidzone Bumper Car". Voice message "Connected Note" followed by "Your device is connected successfully" after pairing. Music can be played from the vehicle speaker according to the user preferences.

To disconnect your mobile device to the vehicle speakers, turn off the Bluetooth.

WARNING

- Closely adult supervision is needed when children are operating the vehicle.

Care and Maintenance

- Check the product regularly and make sure there is no missing or loose parts. Re-tighten any loose parts if necessary.
- Make sure there is no cracked or broken plastic parts.
- Keep away the product from heat and humid area, cover it with trap when not in use.
- Disconnect the battery if the product is not use for a long period of time.
- Clean the vehicle with a cloth. Use a non-wax furniture polish to restore shine to plastic parts. Do not use abrasive cleaner.
- Do not wash the product with a hose or immerse any parts in water or other liquid.
- Occasionally use lightweight oil to lubricate moving parts

Troubleshooting

Problem	Possible Reason	Solution
Vehicle does not move	Low Battery	Fully charge the battery
	Fuse Protection	Power cuts off if overloaded or operated incorrectly. Wait for 10 - 15 seconds to reactivate the vehicle automatically.
	Disconnected / Badly connected battery	Reconnect the battery
	Battery/motor failure	Contact Customer Service
Battery not last long	Low Battery	Fully charge the battery
	Old Battery	Replace battery if necessary
Vehicle runs very slow	Low Battery	Fully charge the battery
	Old Battery	Replace battery if necessary
	Vehicle is overloaded	Make sure users' weight is under 66 lb / 30 kg
	Vehicle is being used in harsh environment	Avoid using the vehicle in harsh environment

Troubleshooting

Problem	Possible Reason	Solution
Vehicle needs a push to go forward	Poor wire connection	Check if the battery connectors are firmly connected. Contact Customer service if necessary
	"Dead spot" on motor	Contact customer service
Loud grinding sound or clicking sound from the motor or gear box	Damaged motor or gear box	Contact customer service
Battery does not charge	Disconnected / Badly connected battery	Reconnect the battery
	Disconnected / Badly connected charger	Make sure the charger is firmly plugged into the power source and connected to the charging port
	Charger not working	Contact customer service
Charger becomes warm during charging	Normal	N/A

Model: TX4

FCC ID: 2AJ2H-WYTX4

This device complies with part 15 of the FCC Rules. Operation is subject to the following two conditions:

- (1) This device may not cause harmful interference, and
- (2) this device must accept any interference received, including interference that may cause undesired operation.

NOTE: This product has been tested and found to comply with the limits for Class B digital device, pursuant to part 15 of the FCC rules. These limits are designed to provide reasonable protection against harmful interference in a residential installation. This equipment generates, uses and can radiate radiofrequency energy and if not installed and used in accordance with the instructions, may cause harmful interference to radio or television reception, which can be determined by turning the equipment off and on, the user is encouraged to try to correct the interference by one or more of the following measures:

- Reorient or relocate the receiving antenna.
- Increase the separation between the equipment and the receiver.
- Connect the equipment into an outlet on a circuit different from that to which the receiver is connected.
- Consult the dealer or an experienced radio/TV technical for help.

Caution: Changes or modifications not expressly approved by the party responsible for compliance could void the user's authority to operate the equipment.

This product conforms to toy safety standards CPSIA and ASTM-F963.

Importer: ONE BIG OUTLET

Importer Address: 19301 E Walnut dr. N. City of Industry CA91748 United States

Importer Tel.: 800 - 946 - 6151

Limited Term Warranty (One Year from Date of Purchase)

WARRANTY TERMS

KIDZONE warrants that its merchandise are free from manufacturing defects (workmanship and/or material) and will either give credit or replace defective parts for a period of up to one (1) year from the date of purchase in accordance with the conditions set forth below. If a manufacturing defect is found, KIDZONE should be notified promptly of the defect and supplied a copy of the invoice and delivery ticket. Inspection by a KIDZONE employee or representative may be necessary to verify that a manufacturing defect exists, or you may be required to submit samples to KIDZONE along with a digital image of the defects. If replacement is required in accordance with this warranty and the defective material or merchandise has been discontinued or unavailable, KIDZONE reserves the right to select and supply similar merchandise or offer full credit for the merchandise; otherwise the same material or merchandise will be supplied for replacement purposes. This warranty is made solely to the retailer and is not transferable under any circumstances. It is the retailer's responsibility to contact KIDZONE with a claim. We will not handle claims from consumers directly; all requests must go through the retailer who sold the merchandise to the consumer. We advise all retailers to retain invoices for a minimum of one (1) year for warranty purposes. This warranty supersedes and replaces all implied warranties of merchantability and use for particular purpose. No representative, employee, agent or any other person is authorized to assume for KIDZONE any additional liability or responsibility in connection with KIDZONE's merchandise except as described above. Implied warranties or merchantability and fitness of the merchandise are limited to a period of one (1) year from the date of purchase. In no event shall KIDZONE be liable for indirect, consequential or incidental damages of any kind.

ADDITIONAL CONDITIONS

THE FOLLOWING EXAMPLES ARE NOT MANUFACTURER'S DEFECTS:

- Colors may vary slightly from the photo because of photography and printing tolerances.
- Sizes stated in U.S. standard measurements may vary slightly due to product are manufactured using the metric system.
- No returns for buyer's remorse.
- No returns - other than stated above will be accepted.

ADDITIONAL CONDITIONS

WARRANT IS VOID FOR ANY OF THE FOLLOWING CONDITIONS:

1. Improper maintenance or improper use resulting in damage.
2. Any product modifications by dealer, consumer, or other parties not authorized by KIDZONE will void this warranty.
3. Floor samples sold or products designated "AS IS" at the time of purchase are not covered by the warranty
4. Warranty does not cover minor variations or differences between floor samples or printed illustrations and your product.
5. Cost of packaging and shipping to and from KIDZONE is not covered by the warranty unless expressly arranged by KIDZONE.
6. This warranty covers only articles of appliances intended for residential use only, does not cover any industrial, commercial, institutional or Rental use.
7. Dissatisfaction due to buyer's remorse.
8. Normal wear and tear.
9. Damages incurred during transportation.
10. Damages incurred during assembling or maintenance.
11. Damage incurred by accidents or abuse.