



For any query or concerns related to the after sales service, you may please contact us on the number or email mentioned below

**Tel: 0484-2922600/2620012**  
**1800 120 555 999**

www.ibellsworld.com

### LIMITATIONS OF WARRANTY

- Damage resulting from accidents, misuse, abuse, alteration, tempering or failure of the purchaser to follow the normal operating procedure outlined in user manual.
- Defect of damage due to spillage of liquids, due to insect or wrong use of electrical supply and voltage.
- Normal wear and tear, corrosion, rusting or stains.
- Scratches and damage to outer surface areas and externally exposed units or parts that are due to normal customer use.
- Claim for damaged /missing parts after seven days from the original date of purchase
- If any part or parts of the unit are replaced with a part or parts not supplied or approved by company or unit has been dismantled or repaired by any person other than authorized technician.
- Product which has serial number removed or tampered
- If the warranty card is being altered, defaced or erased in any manner whatsoever.
- If obtain service, the product must be sent through freight prepaid to iBELL Service Center

### CUSTOMER CARE CENTER

For any query or concerns related to the after sales service, you may please contact us on the number or email mentioned below

**Tel: 0484-2922600/2620012**  
**1800 120 555 999**

E-mail : [service@ibellsworld.com](mailto:service@ibellsworld.com) Web : [www.ibellsworld.com](http://www.ibellsworld.com)



## CARE AND PRECAUTIONS

To ensure that your table top wet grinder performs to its maximum for the years to come, please follow the precautions:

- Always keep the wet grinder clean and dry when not in use.
- Disconnect the electric cord from the switch when not in operation.
- Keep it away from heat sources.
- Lift the appliance holding it only from the base, not the drum or motor cover.
- Do not run the wet grinder when empty for more than a minute.
- Add adequate water while grinding.
- Do not attempt to lift the appliance when in operation.
- Use a damp sponge for cleaning the body, do not pour water on the appliance.
- Do not insert any object through the slits provided.
- After use, clean the drum and roller assembly thoroughly.
- Supervise closely when the appliance is being operated in the presence of children.
- Do not run the grinder if the operating conditions are not normal. In case of any mechanical faults, contact your nearest dealer.

2



**3 ATTACHMENTS**  
KNEADING/SCRAPER/JUICER

**2 LITRE CAPACITY**

**Model: IBL WG 2000L**

**TABLE TOP WET GRINDER**

With **DOUBLE STOPPER**  
FOR BETTER GRINDING EFFICIENCY

## INSTRUCTIONS

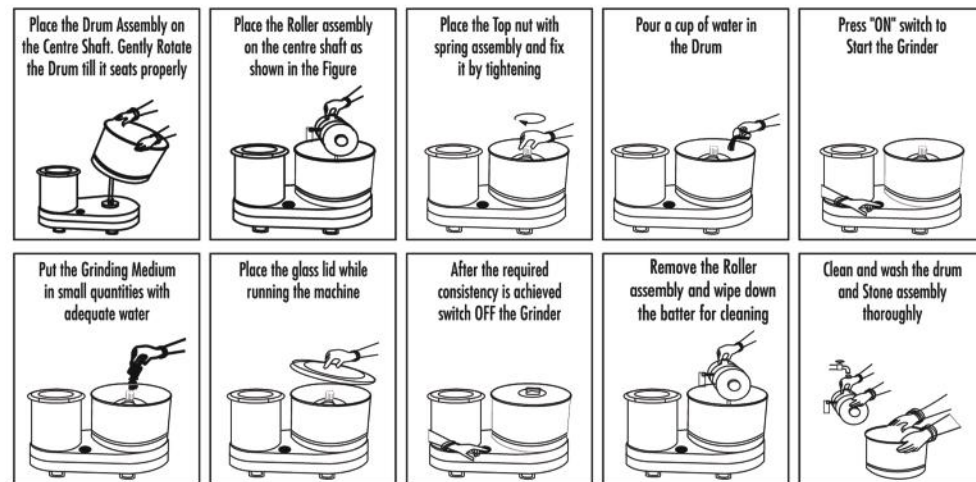

4

## TECHNICAL SPECIFICATIONS

<b>Drum Capacity</b>	: 2 Ltr.(Input 1Kg, Soaked rice output 2 Ltr. batter)
<b>Voltage</b>	: 230V, AC - 50Hz
<b>Drum Material</b>	: Stainless Steel
<b>Drum Speed (with Load)</b>	: 130 RPM

**ATTACHMENTS: Atta Kneader, Coconut Scraper and Citrus Juicer**  
**IN THE BOX: Table Top Wet Grinder, Lid, Attachments and Manual**

	Grinder's Quantity	Quantity	Wetting Time	Water Quantity	Grinding Time
RICE	Maximum Quantity	2 Litres 1 KG	4 Hours	3/4 Ltrs.	20-25 Minutes
	Minimum Quantity	3/4 KG	4 Hours	1/2 Ltrs.	15-20 Minutes
DHAL	Maximum Quantity	200 Grams	4 Hours	3/4 Ltrs.	20-25 Minutes
	Minimum Quantity	100 Grams	4 Hours	1/2 Ltrs.	15-20 Minutes

5

## iBELL WARRANTY CARD

Dear customer  
Thank you for purchasing **iBELL** product. Your **iBELL** product is under warranty in accordance with terms and conditions stated herein.

- ◆ Your units and components contained therein are warranted against defective material and workmanship for a period of **24 months** from the date of purchase.
- ◆ To obtain warranty protection, notice of alleged defect must be given promptly upon discovery and warranty card must be presented along with proof of date of purchase to our service personnel at the time of service.
- ◆ The company decision on identification of the defects due to faulty/defective spare parts or faulty workmanship or misuse/abuse shall be final and you shall agree to abide by such decision.
- ◆ The defective parts/material shall be replaced with a functionally working equivalent part/material and defective part/material will become the property of the company.

**CUSTOMER COPY**

Product : **TABLE TOP WET GRINDER** Model No : **IBL WG 2000L**  
Serial No: ..... Date of Purchase: .....

Buyer Name and Address: .....

Dealer Name and Address: .....

Dealer stamp

6

## ATTACHMENTS

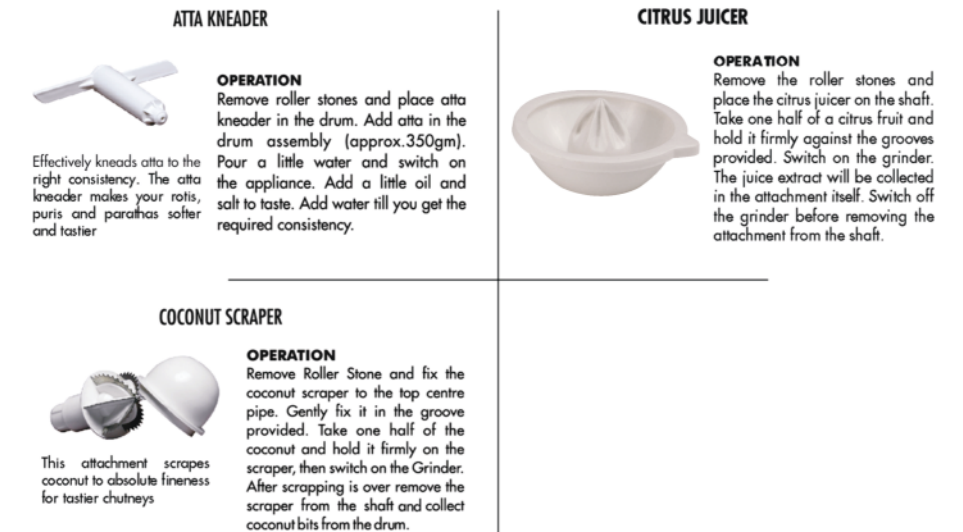

3