

## 2.4GPM Tank-less Gas Water Heater

MODEL (LIPPERT PN)

FWH09A-AM (2021123985) FWH09AFA(2021132338)

FWH09AFA-AM (2021132340) FWH09AFA-AB (2022115112)

---

## TROUBLESHOOTING AND SERVICE MANUAL

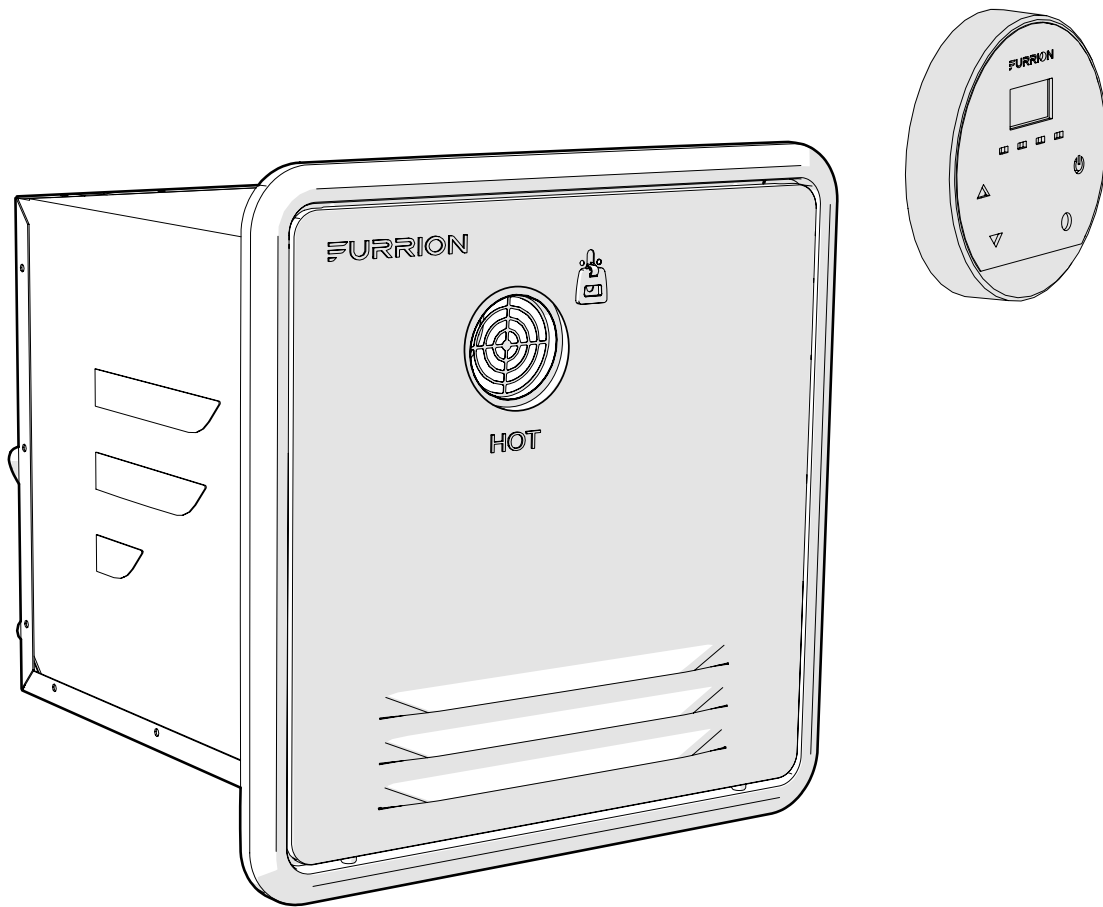

\* Picture shown here is for reference only.

# TABLE OF CONTENTS

<b>Introduction</b> .....	<b>2</b>
<b>Safety</b> .....	<b>2</b>
<b>Important Safety Instructions</b> .....	<b>3</b>
Ensuring a Safe Operating Environment.....	3
<b>Testing</b> .....	<b>4</b>
Gas Leak Testing.....	4
Water Leak Testing.....	4
Functional Test.....	4
<b>Cleaning and Maintenance</b> .....	<b>5</b>
Storage and Transit.....	6
Winterizing Water Heater.....	6
Routine Inspection.....	7
Filter Cleaning.....	8
Pressure Safety Valve Maintenance.....	9
Hard Water and De-calcification.....	9
<b>Replaceable Parts List</b> .....	<b>10</b>
<b>Error Code</b> .....	<b>14</b>
<b>Troubleshooting</b> .....	<b>15</b>
<b>Specification</b> .....	<b>17</b>

## Introduction

This document provides an overview on replaceable parts for Furrion® 2.4GPM Tank-less Water Heater, as well as basic troubleshooting and service information.

**NOTE:** Images used in this document are for reference only when assembling, installing and/or operating this product. Actual appearance of provided and/or purchased parts and assemblies may differ. For more detailed operation, including general safety instructions, warnings and cautions, see Instruction Manual at: <https://support.lci1.com/documents/furrion-tankless-gas-water-heater-user-manual> or scan this QR code:



## Safety

Read and understand all instructions before installing or operating this product. Adhere to all safety labels.

This manual provides general instructions. Many variables can change the circumstances of the instructions, i.e., the degree of difficulty, operation and ability of the individual performing the instructions. This manual cannot begin to plot out instructions for every possibility, but provides the general instructions, as necessary, for effectively interfacing with the device, product or system. Failure to correctly follow the provided instructions may result in death, serious personal injury, severe product and/or property damage, including voiding of the Lippert® limited warranty.

## **WARNING**

The "WARNING" symbol above is a sign that a procedure has a safety risk involved and may cause death or serious personal injury if not performed safely and within the parameters set forth in this manual.

## **WARNING**

Failure to follow instructions provided in this manual may result in death, serious personal injury and/or severe product and property damage, including voiding of the component warranty.

## **CAUTION**

The "CAUTION" symbol above is a sign that a safety risk is involved and may cause personal injury and/or product or property damage if not safely adhered to and within the parameters set forth in this manual.

## **CAUTION**

Always wear eye protection when performing service, maintenance or installation procedures. Other safety equipment to consider would be hearing protection, gloves and possibly a full face shield, depending on the nature of the task.

## Important Safety Instructions

### Ensuring a Safe Operating Environment

## **DANGER**

### **Suffocation or Fire Hazard**

**Exhaust gases are hot and contain carbon monoxide, do not breath or obstruct the exhaust gases. Failure to follow the instruction will lead to serious injury, property damage or death.**

- NEVER use this appliance in enclosed spaces or tents.
- ALWAYS turn the appliance off, and shut off fuel supply while parking the RV in an enclosed space, such as a garage or repair shop.
- NEVER place seating or picnic tables in direct path of the exhaust outlet.
- DO NOT use this water heater without a working carbon monoxide detector installed in the RV. Follow the manufacturer's instruction and guidelines for its installation.
- ALWAYS keep the air inlet and exhaust outlet free of obstructions in order to ensure clean combustion.
- DO NOT place articles on or against the appliance.
- DO NOT lean any objects against the water heater's access door or place any foreign objects within 24" (610mm) of the access door.
- DO NOT use or store flammable materials near the appliance.
- DO NOT spray aerosols in the vicinity of the appliance while it is in operation.
- DO NOT modify the appliance.

## Testing

### Gas Leak Testing

#### **⚠️ WARNING**

##### **Fire and Explosion Hazard**

- Ensure test pressures are below 40in-wc (100mbar).
  - **DO NOT** use matches, candles or other sources of ignition when checking for gas leaks.
  - Use a gas leak detection liquid or equivalent.
  - Make certain to re-test all fittings after making adjustments to loose connections.
- Failure to follow instruction may lead to serious injury, property damage or death.**

1. Verify the power switch on the water heater is in the "OFF" position (Fig.1).

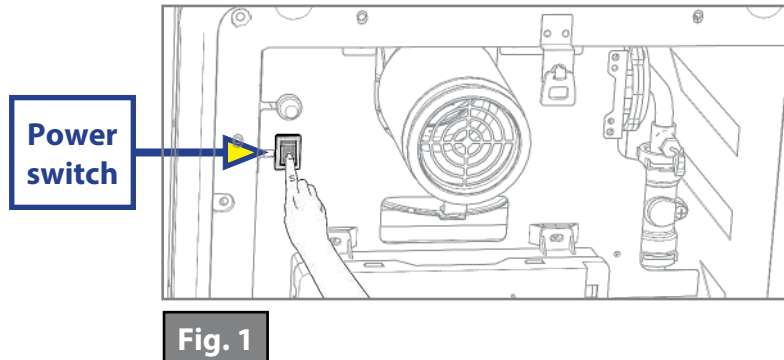

2. Turn on the gas supply or alternative pressure supply.
3. Check the appliance and all gas connections for gas leaks with leak detection liquid (not provided) or an equivalent gas leak detection method. Bubbles indicate a gas leak that must be repaired.
4. Repair gas leaks as needed.
5. Repeat gas leak check after any adjustments to loose connections.

**NOTE:** After leak checking, make sure the gas supply pressure corresponds to the operating pressure of the appliance 11~14in-wc (2 7.4~34.9mbar).

### Water Leak Testing

**IMPORTANT:** DO NOT exceed 116PSI when pressure leak testing the system with compressed air.

1. Verify the power switch on the water heater is in the " OFF" position (Fig.1).
2. Turn on the water supply to the unit.
3. Open water faucets to fill the system with water. Close the faucets when the water is flowing smoothly and all air is removed from the lines.
4. Check all connections for water leaks by eye and touch.
5. Repair leaks as needed.
6. Repeat check for water leaks and take any necessary steps to repair the leaks at all water connections.

### Functional Test

#### **⚠️ WARNING**

##### **Fire and Explosion Hazard**

- Ensure all necessary system leak tests are complete before performing any functional test
- Failure to follow instruction may lead to serious injury, property damage or death.**

1. Verify the power switch on the water heater is in the "OFF" position (Fig. 1).
2. Confirm that there is a "steady" water flow (not pulsating) and no air in the system. If pulsating have the water pump settings adjusted.
3. Make certain all valves that can mix cold and hot water are all shut.

**NOTE:** NOTE: Outside faucets with detachable spigots and shower heads with flow interrupters can bleed hot water into the cold side if the valves are not closed properly. This will hinder the performance of the water heater.

4. Turn the power switch to the "ON" position (Fig.1) and verify the wall controller is illuminated. If the wall controller is not illuminated, press button  (Fig.2) on the wall controller to illuminate. The wall controller display will show the Hot Water temperature setting.

**NOTE:** The default factory setting is 115oF or 46oC.

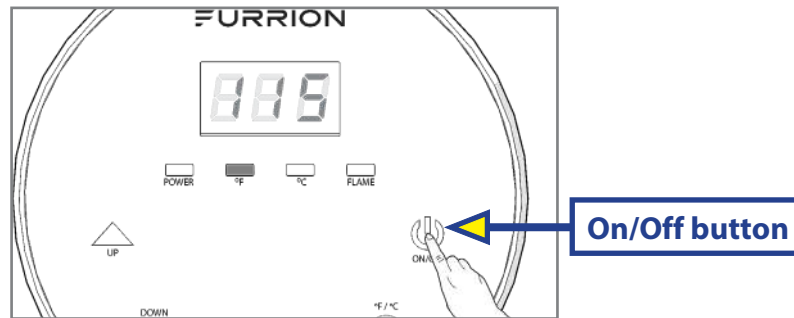

**Fig. 2**

5. Turn on the gas supply.
6. Open a hot water faucet and verify that the unit ignites and supplies hot water at the faucet.
7. The wall controller display will show the current temperature settings.

**NOTE:** If any error codes or performance concerns, refer to the trouble shooting section of this manual.

## Cleaning and Maintenance

### **WARNING**

#### **Burn or Scald Hazard**

- **NEVER perform work while the water heater is operating.**
- **NEVER perform work without turning the Electrical and LP gas supply off.**
- **NEVER perform work when the appliance is hot.**
- **NEVER actuate the pressure relief valve as long as the appliance is still hot.**
- **Never actuate the Drain Plug as long as the appliance is under water pressure and/or is still hot.**

## ⚠ CAUTION

 Always wear protective gear such as gloves, eye-wear and clothing to avoid injuries during installation and servicing of the product.

### Storage and Transit

Anytime the RV is not intended to be used, it is considered to be in storage or transit. To prepare the water heater, follow the below steps:

1. Turn off gas supply.
2. Turn off the main-switch located behind the access door of the water heater unit (Refer to Fig.1).
3. Drain water out of the system and water heater by removing the filter cover and drain plug (Fig.3)

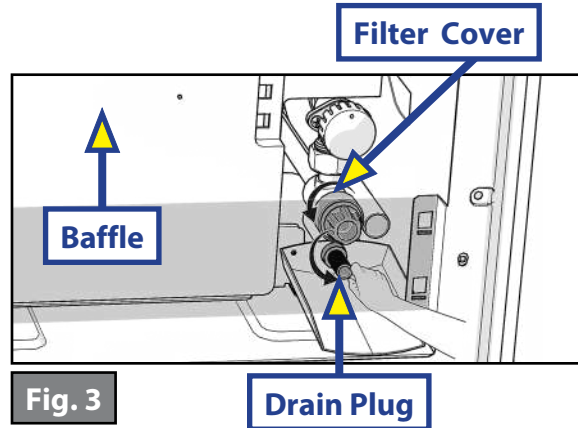

4. If freezing conditions could occur, then winterize according to "Winterizing Water Heater".

### Winterizing Water Heater

## ⚠ CAUTION

**Product damage due to frost condition ❄**

**In frost conditions, ambient temperatures below 39°F (4°C), there is a risk that water in pipes, faucets and appliance could freeze. This can cause considerable damage.**

Follow the instructions provided by the RV coach manufacturer for winterizing your water system. Supplement the following important water heater instructions when completing any winterizing steps:

#### **Compressed Air:**

- DO NOT exceed 50PSI in the water heater when blowing out the system.
- While completing the blow out process for the entire water system, take time to isolate the water heater by closing all drain plugs and faucets and only open the water heater drain plug. This ensures maximum pressure and flow is isolated through the water heater for complete evacuation.

#### **Anti-freeze:**

- Use a non-toxic antifreeze recommended by the RV coach manufacturer.
- Anti-freeze can be used directly in the water heater, plan for an additional 1L to fill the system.

**Optional:** A bypass valve can be installed/used to bypass filling the water heater with antifreeze. The water heater MUST be evacuated with compressed air (see steps above) before bypassing.

#### **Next Season:**

- Thoroughly flush the water heater and system with clean drinking water through the hot and cold side before using. Drain water several times out of the water heater drain plug. Sanitize the water system per the recommendations of your coach manufacturer.

## Routine Inspection

Routine inspection is critical for maintaining proper operation of your appliance. Unless specified, review the following items yearly or before each season:

1. Inspect the gas system and installation every two years, or otherwise specified by your RV coach manufacturer, by a qualified personnel.
2. Inspect for cracks, separation, peeling of seals to the RV wall. Remove and re-seal as necessary (caulking or tape) between the side wall and the door of the water heater and ensure that the unit is solidly mounted to the vehicle.
3. Verify that the air inlet openings (louvers) are completely open and clear of any debris including mud, leaves, twigs, insects, etc... Remove all obstructions to allow full air flow.
4. Before actively using your vehicle, pre-inspect that the air inlet openings (louvers) are completely open and clear of any debris including mud, leaves, twigs, insects, etc... Remove all obstructions to allow full air flow.
5. Before actively using the vehicle, verify that the exhaust tube and screen are completely clear of obstructions including: mud, leaves, twigs, insects, nest, etc. Clean by gently breaking up and using a vacuum to clear it. Use only water and apply gently from a spray bottle, NEVER spray directly with high pressure. Run the appliance to dry any moisture and blow out loose debris. The use of any after-market protective screen is prohibited and will void the warranty.
6. Before actively using the vehicle, open the door and verify that no debris or extraneous combustible materials are present anywhere (especially in the area of the burner and the gas controls). Remove any item present and wipe clean the bottom of the housing.
7. Inspect the interior surface of the housing for any cracks or corroded areas that could allow penetration of gases into or out of the interior of the vehicle. Check especially around the hot water, cold water, gas and electrical connections.

**NOTE:** If damages found, please contact a technician to repair or contact Furrion customer service.

8. Check that all wire connections are firmly in place and there are no signs of chafing or cracks on the insulation. Verify that the spark ignition cable between the Control Board and the igniter is securely in place and not shorted to any metal component.
9. Inspect the pressure safety valve to ensure it has not been leaking (no water residue). See "Pressure Safety Valve Maintenance" for further inspection (Fig.4).

**Pressure Safety Valve Handle (red)**

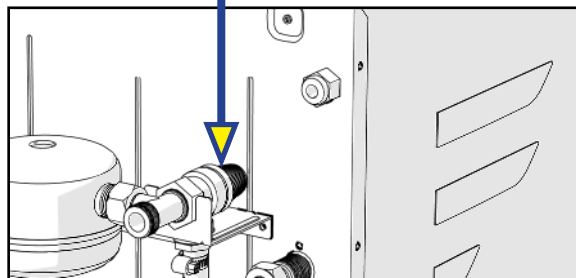

**Fig. 4**

10. Inspect/clean/replace water inlet filter as necessary, see "Filter Cleaning" section.
11. Turn on the power to the water heater and open a hot water faucet to inspect the flame of the burner. The flame should be of the normal bluish appearance that indicates proper combustion. This can be accomplished by removing the water heater door and baffle to observe the flames by looking at the burner under the edge of the heat exchanger (Fig.5).

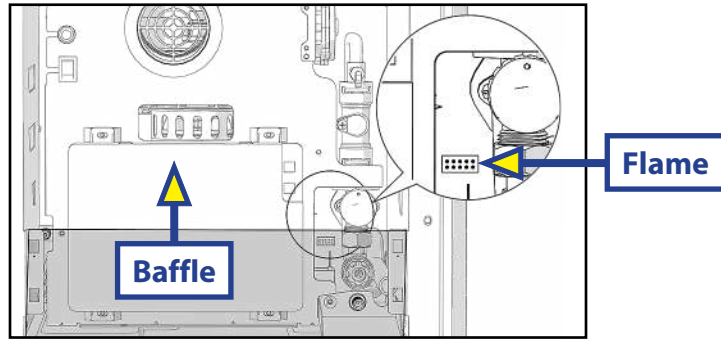

**Fig. 5**

12. A sealing ring is assembled on the chimney (Fig.6). Inspect to make sure the seal does not have any cracks or breaks, and that it is in good condition. Contact Furrion for replacement.

**NOTE:** When installing the seal, make sure the words "INSIDE" are facing inward.

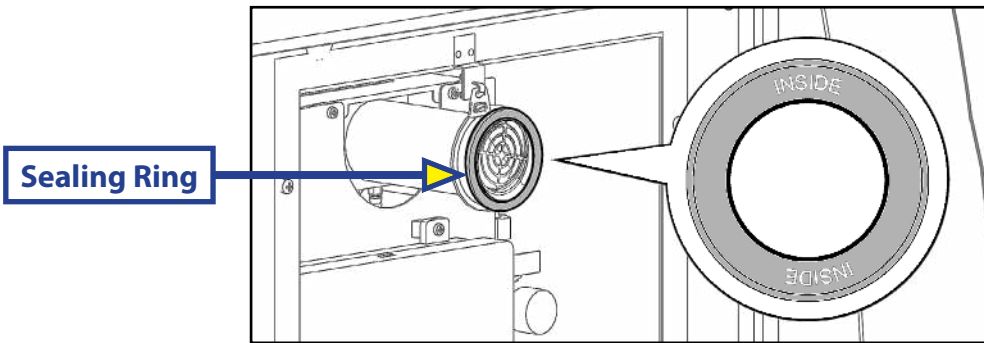
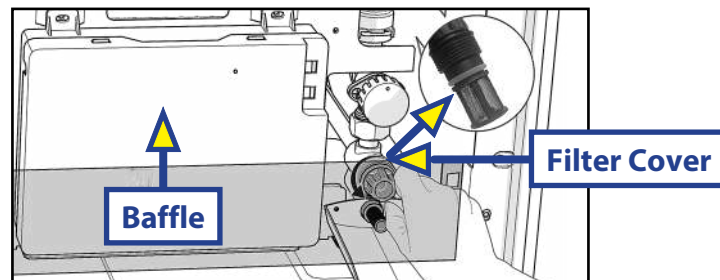

**Fig. 6**

## Filter Cleaning

There is a filter screen on the Water Heater inlet water line connection. The filter screen needs to be cleaned periodically to prevent blockages from forming. Follow below steps below to clean the filter (Fig.7):

1. Step 1 : Open the door of the Water Heater, remove the baffle.
2. Step 2 : Unscrew the filter cover by hand or a proper tool counterclockwise.
3. Clean the screen filter by flushing any debris accumulated.



**Fig. 7**

## Pressure Safety Valve Maintenance

### **⚠ WARNING**

#### **Scald Hazard**

- **Never actuate the pressure relief valve while the appliance is in operation.**
- **Never tamper with the pressure relief valve.**

1. The unit is equipped with a water pressure safety valve. The pressure safety valve needs to operate once each year to ensure this safety device is effective.
2. The pressure relief valve is a safety component and must not be removed for any reason other than replacement.

**NOTE:** The pressure relief valve must be replaced by a certified service technician if defective.

3. Tampering with the pressure relief valve will void the warranty.
4. On the back of the water heater. Rotate the pressure safety valve handle (Red) about 3~5 times counterclockwise (Fig.8).

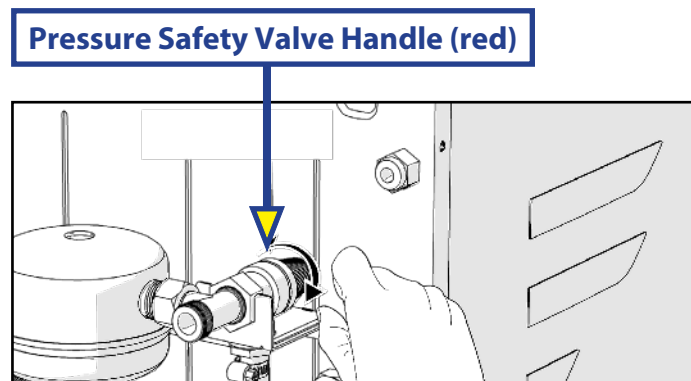

**Fig. 8**

5. Check the drain hose for water (Fig.9). Water in the drain hose indicates the pressure safety valve is working properly.

**NOTE:** Never actuate the drain plug as long as the appliance is still hot.

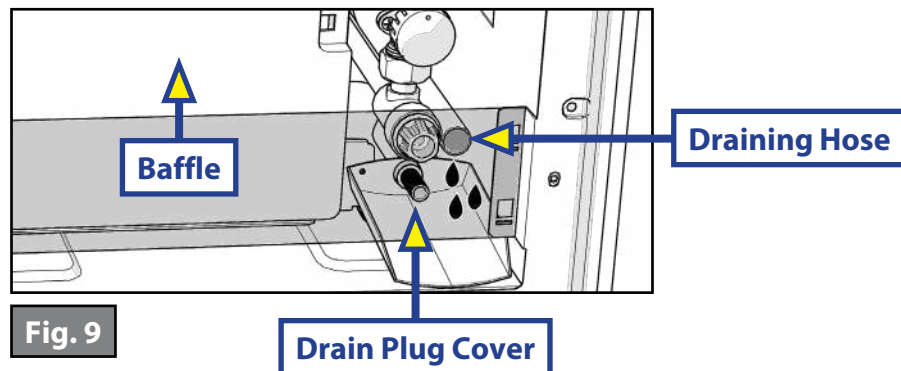
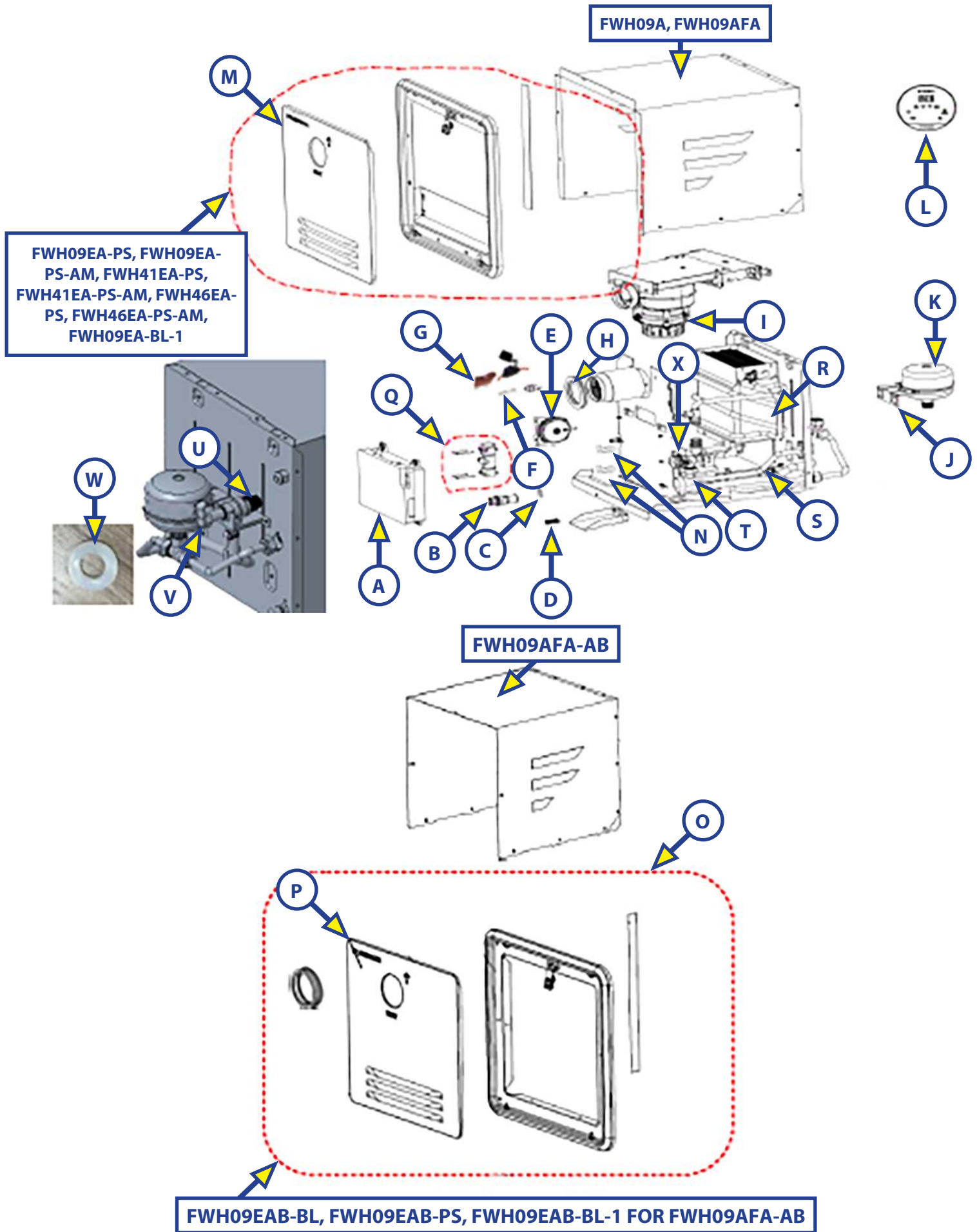

**Fig. 9**

## Hard Water and De-calcification

For prolong usage, when exposed to higher water hardness concentrations, it is advised to provide a proper water treatment device for the incoming water to the coach. Hard water may lead to performance reduction of you appliance overtime. Contact Furrion® for de-calcification instructions.

# Replaceable Parts List



Callout	Part #	Description	Model
A	<a href="#">2022006595</a>	Controller Unit with Freeze Detector	FWH09A, FWH09A-AM, FWH09A16S-PS-AM, FWH09A16S-BL-AM, FWH09AFA, FWH09AFA-AM, FWH09AFA16S-PS-AM, FWH09AFA16S-BL-AM
B	<a href="#">2021124180</a>	Filter Assembly	FWH09A, FWH09A-AM, FWH09A16S-PS-AM, FWH09A16S-BL-AM, FWH09AFA, FWH09AFA-AM, FWH09AFA16S-PS-AM, FWH09AFA16S-BL-AM
C	<a href="#">2021124309</a>	Drainpipe End Plug	FWH09A, FWH09A-AM, FWH09A16S-PS-AM, FWH09A16S-BL-AM, FWH09AFA, FWH09AFA-AM, FWH09AFA16S-PS-AM, FWH09AFA16S-BL-AM
D	2023136654	Water Drain Ramp For Flange-less Water Heater	FWH09AFA-AB
E	<a href="#">2021124391</a>	Exhaust Pressure Switch	FWH09A, FWH09A-AM, FWH09A16S-PS-AM, FWH09A16S-BL-AM, FWH09AFA, FWH09AFA-AM, FWH09AFA16S-PS-AM, FWH09AFA16S-BL-AM
F	<a href="#">2021128843</a>	Fuse 10A / 125V (slow blow) (5 x 20mm)	FWH09A, FWH09A-AM, FWH09A16S-PS-AM, FWH09A16S-BL-AM, FWH09AFA, FWH09AFA-AM, FWH09AFA16S-PS-AM, FWH09AFA16S-BL-AM
G	N/A	Fuse 10A / 32V ATC (blade) fuse (19mm)	FWH09A, FWH09A-AM, FWH09A16S-PS-AM, FWH09A16S-BL-AM, FWH09AFA, FWH09AFA-AM, FWH09AFA16S-PS-AM, FWH09AFA16S-BL-AM
H	2021124241	Flue Duct Seal	FWH09A, FWH09A-AM, FWH09A16S-PS-AM, FWH09A16S-BL-AM, FWH09AFA, FWH09AFA-AM, FWH09AFA16S-PS-AM, FWH09AFA16S-BL-AM
I	<a href="#">2021124394</a>	Flue Fan Assembly	FWH09A, FWH09A-AM, FWH09A16S-PS-AM, FWH09A16S-BL-AM, FWH09AFA, FWH09AFA-AM, FWH09AFA16S-PS-AM, FWH09AFA16S-BL-AM

Callout	Part #	Description	Model
J	2025043717	Vortex Tank Bracket	FWH09A, FWH09A-AM, FWH09A16S-PS-AM, FWH09A16S-BL-AM, FWH09AFA, FWH09AFA-AM, FWH09AFA16S-PS-AM, FWH09AFA16S-BL-AM
K	<a href="#">2021124195</a>	Vortex Tank Assembly	FWH09A, FWH09A-AM, FWH09A16S-PS-AM, FWH09A16S-BL-AM, FWH09AFA, FWH09AFA-AM, FWH09AFA16S-PS-AM, FWH09AFA16S-BL-AM
L	<a href="#">2021124277</a>	Wall Controller for Water Heater	FWH09A, FWH09A-AM, FWH09A16S-PS-AM, FWH09A16S-BL-AM, FWH09AFA, FWH09AFA-AM, FWH09AFA16S-PS-AM, FWH09AFA16S-BL-AM
M	<a href="#">2021124165</a>	Door Panel - White 16-1/8" X 16-1/8" (410mm x 410mm)	FWH46EA-PS.OEM, FWH46EA-PS.AM
	2022300664	Door Panel - Black 16-1/8" X 16-1/8" (410mm x 410mm)	FWH09EA-BL-AM, FWH09A16S-BL-AM, FWH09AFA16S-BL-AM
	2024055383	Door Panel - Black 16-1/8" X 16-1/8" (410mm x 410mm) for Flanged Water Heater with UV Protection	FWH09EA-BL-1
N	<a href="#">2022300665</a>	O-Ring for Water Flow Sensor	FWH09A, FWH09A-AM, FWH09A16S-PS-AM, FWH09A16S-BL-AM, FWH09AFA, FWH09AFA-AM, FWH09AFA16S-PS-AM, FWH09AFA16S-BL-AM
O	2022115113	Door 16 1/8" X 16 1/8" (410mm x 410mm) For 144GPH/2.4GPM Tank-less Water Heater (OEM)/ Black	FWH09AFA-AB
	2021115114	Door 16 1/8" X 16 1/8" (410mm x 410mm) For 144GPH/2.4GPM Tank-less Water Heater (OEM)/ White	FWH09AFA-AB
P	2022453681	Door Panel - 16 1/8" X 16 1/8" (410mm x 410mm) Black for Flange-less Water Heater	FWH09EAB-BL
	2022453682	Door Panel - 16 1/8" X 16 1/8" (410mm x 410mm) White for Flange-less Water Heater	FWH09EAB-PS

Callout	Part #	Description	Model
Q	<a href="#">2021124288</a>	Water Flow Sensor Assembly	FWH09A, FWH09A-AM, FWH09A16S-PS-AM, FWH09A16S-BL-AM, FWH09AFA, FWH09AFA-AM, FWH09AFA16S-PS-AM, FWH09AFA16S-BL-AM
R	2024118466	Heat Exchanger Assembly	FWH09A, FWH09A-AM, FWH09A16S-PS-AM, FWH09A16S-BL-AM, FWH09AFA, FWH09AFA-AM, FWH09AFA16S-PS-AM, FWH09AFA16S-BL-AM
S	2024118229	Water Drain pipe with Gasket Kit	FWH09A, FWH09A-AM, FWH09A16S-PS-AM, FWH09A16S-BL-AM, FWH09AFA, FWH09AFA-AM, FWH09AFA16S-PS-AM, FWH09AFA16S-BL-AM
T	2024118230	Water Inlet Pipe with Gasket Kit	FWH09A, FWH09A-AM, FWH09A16S-PS-AM, FWH09A16S-BL-AM, FWH09AFA, FWH09AFA-AM, FWH09AFA16S-PS-AM, FWH09AFA16S-BL-AM
U	2024118231	Pressure Relief Valve with Gasket Kit	FWH09A, FWH09A-AM, FWH09A16S-PS-AM, FWH09A16S-BL-AM, FWH09AFA, FWH09AFA-AM, FWH09AFA16S-PS-AM, FWH09AFA16S-BL-AM
V	2024118232	Water Tee Fitting for Pressure Relief Valve (one side G1/2 teeth, one side NPT 1/2 teeth)	FWH09A, FWH09A-AM, FWH09A16S-PS-AM, FWH09A16S-BL-AM, FWH09AFA, FWH09AFA-AM, FWH09AFA16S-PS-AM, FWH09AFA16S-BL-AM
W	2024118233	Water Line Gasket for the Copper Pipes	FWH09A, FWH09A-AM, FWH09A16S-PS-AM, FWH09A16S-BL-AM, FWH09AFA, FWH09AFA-AM, FWH09AFA16S-PS-AM, FWH09AFA16S-BL-AM
X	2024020745	Flow Control Knob Assembly	FWH09A, FWH09A-AM, FWH09A16S-PS-AM, FWH09A16S-BL-AM, FWH09AFA, FWH09AFA-AM, FWH09AFA16S-PS-AM, FWH09AFA16S-BL-AM

## Error Code

If the appliance malfunctions, an error code will display on the wall controller. Write down the error code, then try resolving by stopping and restarting the water flow, or resetting the appliance as follows:

- Switch the power switch (Fig. 1) in front of the water heater to the "OFF" position.
- Wait 5 seconds.
- Switch the appliance on again.

Continue to use the appliance normally. If error fault codes continue to display, review the following table for potential causes.

Error Code	Possible Cause	Solution
E0: Water outlet temperature	System Fault.	Contact Furrion.
E1: Flame sense during ignition	Insufficient fuel supply to start operation.	Confirm all gas valves are open, Confirm adequate fuel in tanks.
	Low gas inlet pressure.	Check regulator for operation. Replace if needed.
	System Fault.	Contact Furrion.
E2: Detected fake flame signal	System Fault.	Contact Furrion.
E3: Over temperature mechanical sensor faulty	System Fault.	When E3 error displays, let cold water flow 10~20S then restart the appliance. If E3 still displays, contact Furrion.
E4: Water inlet temperature	System Fault.	Contact Furrion.
E5: Air pressure	Exhaust blockage.	Remove obstruction then restart the appliance.
	High winds blowing on exhaust.	Move or re-orient coach so exhaust is not facing high winds then restart the appliance.
	System Fault.	Contact Furrion.
E6: Temperature surge	Cold water surge in system.	Reduce toilet flushes and amount of cold water faucets opened during operation.
	Cold water mix ratio.	Reduce temperature setting to reduce cold water mix ratio.
		Check for shower head and outdoor faucet valves leaking cold water to hot side.
	Insufficient water supply.	Confirm water tank is full or city water valve fully open.
		Air in water lines. Continue to run all faucets, Hot and Cold, open until air purged.
	Insufficient water flow.	Filter plugged. Review "Cleaning and Maintenance" section of this manual.
Low flow faucets. Check that the minimum flow is .32gpm.		
System Fault.	Contact Furrion.	
E7: Solenoid valve fault	System Fault.	Contact Furrion.

## Troubleshooting

- If you encounter a problem with the appliance as the below table states, first try the suggested solutions. If problems persist, please call the service or the dealer.
- Don't repair the appliance by yourself, Repairs must be performed by a certified service technician.

Problem	Potential cause	Solution
Hot water takes longer to reach temperature	<ol style="list-style-type: none"> <li>1. Cold water mixing into hot water side</li> <li>2. Higher Elevation</li> <li>3. Incoming water temperature is abnormally low incoming water</li> </ol>	<ol style="list-style-type: none"> <li>1. Check all valves, inside and outside, to ensure they are closed, check shower head valve to make sure it is not partially closed.</li> <li>2. This is normal due to lesser oxygen levels - Contact Furrion.</li> <li>3. See "Water Control Valve" for adjustment.</li> </ol>
Low hot water flow at the faucet	Lime scale occurs due to precipitation of "hard " water.	De-calcify your water heater. See "Cleaning and Maintenance" section.
No hot water at the tap	Gas supply is turned off or interrupted.	Check and/or turn on gas supply.
	Gas tank is empty.	Refill/replace the gas tank.
	The appliance is switched off.	Switch on the appliance according to instructions ("Operation" section).
	Fresh water supply is turned off.	Open the fresh water supply.
	Power supply to the appliance is switched off.	Switch on power supply to the appliance.
	Defect in the appliance.	Refer to Error Codes list on page 16.
Hot water temperature too low.	Gas flow to the appliance is too low (gas inlet pressure 11in. wc.)	<ul style="list-style-type: none"> <li>• Consult vehicle documentation to determine if gas supply is capable of providing the necessary volume of gas for the appliance.</li> <li>• Contact a service technician to verify a suitable gas installation.</li> </ul>
	Volume flow of hot water is too high and/or the temperature of cold water reaching the appliance is too low.	<ul style="list-style-type: none"> <li>• Turn down hot water at the tap or in the shower in order to reduce volume flow. Or mix more cold water in faucet.</li> <li>• Potentially retrofit a volume flow throttle into the water system. This must be performed only by a certified service technician.</li> </ul>
	Too much lime scale in the appliance.	De-calcify your water heater. See "Cleaning and Maintenance" section.
	Cold water mixing into Hot water side	Check all valves, inside and outside, to ensure they are closed. Check shower head valve to make sure it is not partially closed.

Problem	Potential cause	Solution
Water escaping at pressure safety valve.	Water pressure in water system too high.	<ul style="list-style-type: none"> <li>• Adjust the water pump pressure to a maximum of 65PSI.</li> <li>• If the water system is connected to a central water supply higher than 65PSI (rural or urban connection), a water pressure reducer must be used.</li> <li>• Install a water pressure regulator at the fresh water supply.</li> </ul>
	Lime or dirt under the pressure relief valve seat.	<ul style="list-style-type: none"> <li>• Allow the appliance to cool then slowly operate the relief valve by rotating its valve handle(knob), Fig.36) to flush the water system and attempt to force dirt or foreign matter out of the pressure relief valve seat.</li> <li>• Replace pressure relief valve. This must be performed only by a certified service technician.</li> </ul>
Water leaking at the water inlet filter.	Lime or dirt under the O-ring seats.	Clean the O-rings and their corresponding sealing surfaces with clean water.
Power status LED is off although an operating mode was selected.	Power supply to the appliance is switched off.	Switch on power supply to the appliance.
	Blown fuse.	Switch the standard 125V/10A fuse. Contact Furrion for service.
Water heater stops working often and water is found on the drainage tray.	Unit is overheating, and pressure relief valve discharged periodically.	Contact Furrion.

## Specification

BTU/HR	60,000 BTU	
Fuel	Propane (LP Gas)	
Inlet Pressure	11" WCI Min to 14" WCI Max	
Manifold Pressure	0.96"-7.6" WCI	
Power Input	12V DC < 3 Amp	
Water Operating Pressure	7.2 PSI-65 PSI	
Orifice (mm)	Ø 1.1	
Altitudes: 0-2000ft (0~610m)	Manifold Pressure (Pa)	1920
	Max Fan Speed	58 r/s
Altitudes: 2000-4500ft (610-1370m)	Manifold Pressure (Pa)	2360
	Max Fan Speed	68 r/s
Product Dimensions (W x H x D) Body Only (Model: FWH09A)	12 <sup>5</sup> / <sub>8</sub> " (320mm) x 12 <sup>5</sup> / <sub>8</sub> " (320mm) x 19 <sup>1</sup> / <sub>8</sub> " (486.5mm)	
Assembly (Body and Door) Dimensions (W x H x D)	Body with Door (FWH09EA-PS)	16 <sup>1</sup> / <sub>8</sub> " x 16 <sup>1</sup> / <sub>8</sub> " x 19 <sup>1</sup> / <sub>16</sub> " (410mm x 410mm x 500.6mm)
	Body with Door (FWH41EA-PS)	16 <sup>1</sup> / <sub>8</sub> " x 18 <sup>1</sup> / <sub>8</sub> " x 19 <sup>1</sup> / <sub>16</sub> " (410mm x 460mm x 500.6mm)
	Body with Door (FWH46EA-PS)	18 <sup>1</sup> / <sub>8</sub> " x 18 <sup>1</sup> / <sub>8</sub> " x 19 <sup>1</sup> / <sub>16</sub> " (460mm x 460mm x 500.6mm)
Shipping Weight	31 lbs.	
Setting Temperature Range	95°F (35°C) ~ 124°F (51°C)	



# FURRION®

Furrion, LLC (Furrion) are wholly owned subsidiaries of Lippert Components, Inc. (Lippert)  
Furrion, LLC (Furrion) sont des filiales en propriété exclusive de Lippert Components, Inc. (Lippert)  
Furrion, LLC: 52567 Independence Ct., Elkhart, IN, 46514

Furrion Innovation Center & Institute of Technology  
Centre d'innovation et institut de technologie Furrion  
22244 Innovation Drive, Elkhart, IN 46514-5514, USA  
Toll free/Numéro gratuit/Línea telefónica gratuita: 1-800-789-3341  
Email/Courriel/Correo electrónico: customerservice@lci1.com

©2007-2025 Furrion, LLC. All rights reserved.  
©2007-2025 Furrion, LLC. Tous droits réservés.

For Patent Info: [www.Lippert.com/patents](http://www.Lippert.com/patents)  
Pour des informations sur les brevets: [www.Lippert.com/patents](http://www.Lippert.com/patents)

[SUPPORT.LCI1.COM/FURRION](http://SUPPORT.LCI1.COM/FURRION)



The contents of this manual are proprietary and copyright protected by Lippert. Lippert prohibits the copying or dissemination of portions of this manual unless prior written consent from an authorized Lippert representative has been provided. Any unauthorized use shall void any applicable warranty. The information contained in this manual is subject to change without notice and at the sole discretion of Lippert. Revised editions are available for free download from [lippert.com](http://lippert.com).

Please recycle all obsolete materials.

Les renseignements contenus dans le présent manuel peuvent seulement être distribués sous forme de document complet, à moins de recevoir l'approbation explicite de Lippert Components pour distribuer des parties individuelles. Tous les renseignements contenus dans le présent manuel peuvent être modifiés sans préavis. Les éditions révisées pourront être téléchargées gratuitement sur le site [lci1.com](http://lci1.com). Ces renseignements sont considérés comme étant factuels jusqu'à ce qu'une version révisée les rende désuets.

Veuillez recycler tout le matériel désuet.

For all concerns or questions, please contact Lippert.  
Communiquer avec Lippert Components si vous avez des questions ou des préoccupations.  
Ph: 432-LIPPERT (432-547-7378) | Web: [lippert.com](http://lippert.com) | Email: [customerservice@lci1.com](mailto:customerservice@lci1.com)