

CRYSTORAMA



Crystorama.com

LIGHTING THE WAY FOR SIXTY YEARS

ASSEMBLY INSTRUCTION MODEL #1112-CH-CL-MWP



All electrical components must be installed by a licensed electrician in accordance with the National Electric Code and the appropriate local electrical codes.

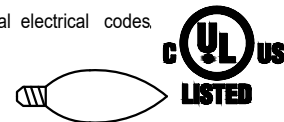

You will need 12- Candelabra Base Bulb
40 Watts recommended 60 Watts Max.
USE LED BULBS FOR EXTENDED USE

The fixture is Damp rated

HOW TO INSTALL:

Place the fixture parts on a soft cloth-covered platform before installation of fixture.

- To install the 8" & 14" arms, slightly loosen each screw on the metal plate. Pull a female plug through a hole in the upper metal plate. Connect the male plug at the end of the arms with the female plug that was just pulled. Push the end of the arm with the metal tab through the hole until stopped by the metal tab (this should also push the wires and plugs back inside the metal plate). Twist the metal tab counter-clock wise until both inserts lock onto the loose screws. Tighten the screw securing the arm in place. Repeat for all arms.
- Place the bottom bowl, 2 metal washers, bottom bobèche, metal washer in that order, over the distributor box. Secure with the finial.
- Attach the mounting bar onto the outlet box.
- Decide the desired hanging height and adjust the chain to the correct length.
- Raise the fixture up and do the wire connection. Attach the canopy over the mounting bar and secure with collar ring.
- Dress the crystals as illustrated.

⚠ WARNING: This product can expose you to Lead, which is known to the State of California to cause cancer and/or birth defects or reproductive harm. For more information go to www.p65warnings.ca.gov

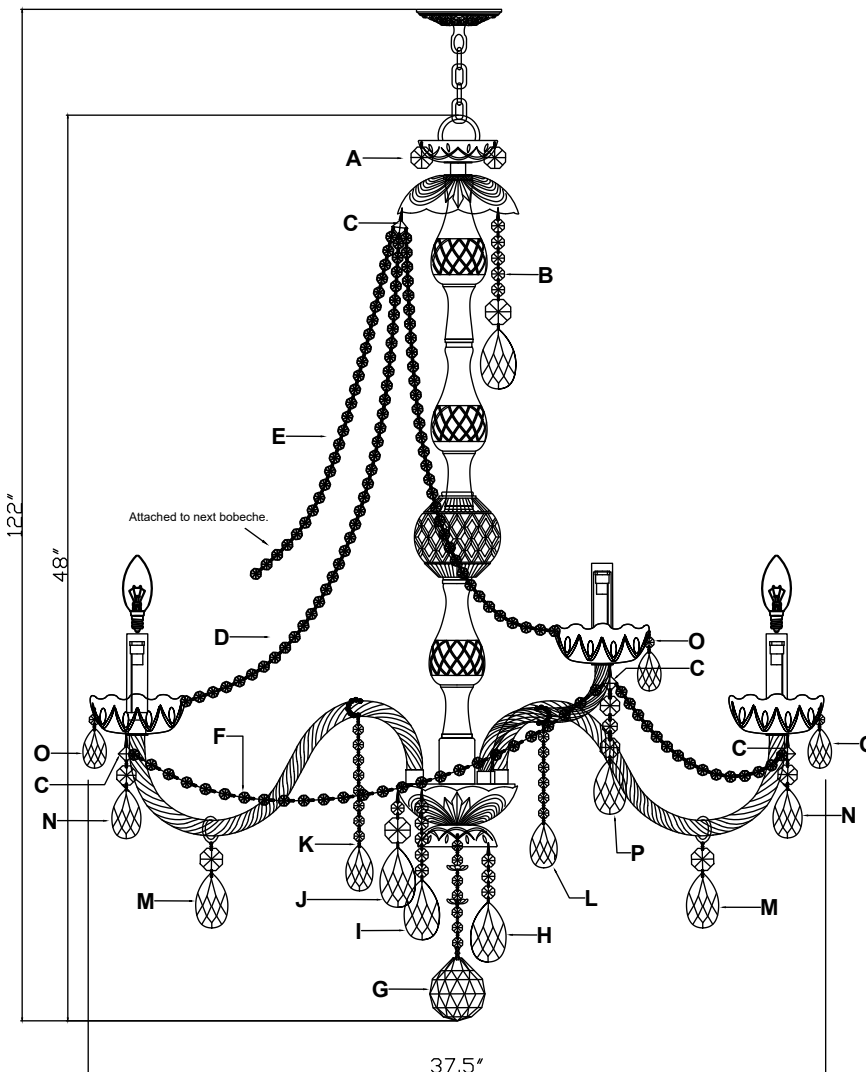

Crystal Sets

- A. 4 Sets. (1)24mm
- B. 6 Sets. (5)14mm + (1)30mm + AS9-3"
- C. 18 Sets. (1)Square
- D. 6 Sets. (32)14mm
- E. 12 Sets. (23)14mm
- F. 12 Sets. (20)14mm
- G. 1 Piece. (7)14mm + (2)Rosette + (1)60mm ball
- H. 4 Sets. (3)14mm + AS9-3"
- I. 4 Sets. (5)14mm + AS9-3"
- J. 4 Sets. (1)14mm + (1)28mm + AS9-3"
- K. 6 Sets. (1)Ring of beads + (6)14mm + AS9-3"
- L. 6 Sets. (1)Ring of beads + (8)14mm + (1)30mm + AS9-4"
- M. 6 Sets. (1)Ring of beads + (1)30mm + AS9-4"
- N. 6 Sets. (1)28mm + AS9-3.5"
- O. 60 Sets. (1)14mm + AS9-2"
- P. 6 Sets. (2)28mm + (1)24mm + AS9-4"

CRYSTORAMA



LIGHTING THE WAY FOR SIXTY YEARS

ASSEMBLY INSTRUCTION MODEL #1112-CH-CL-MWP

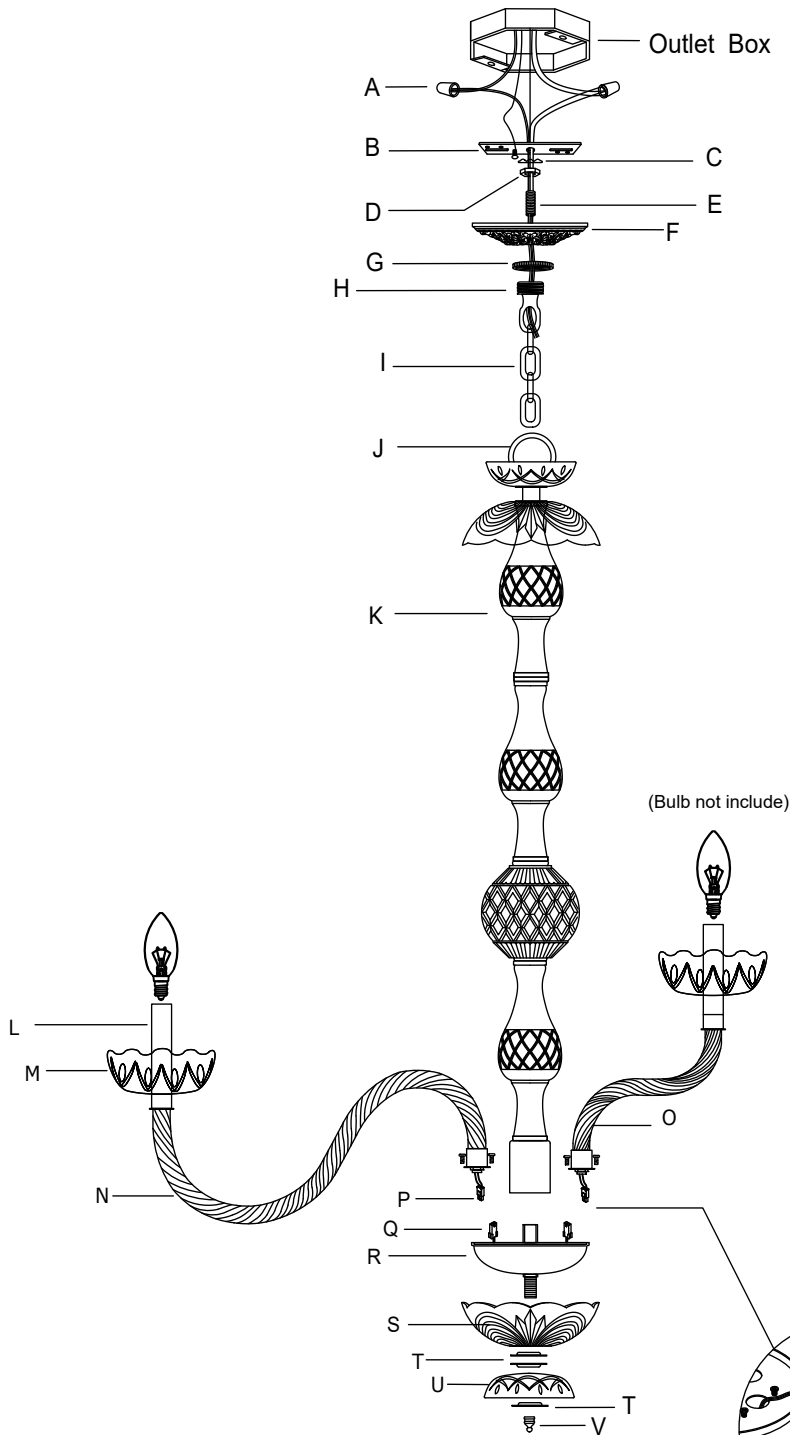

(Bulb not include)

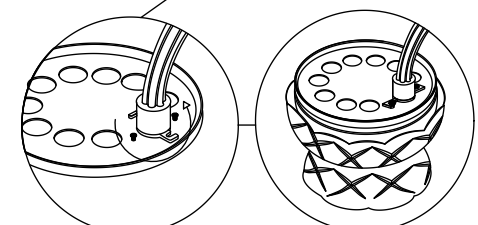
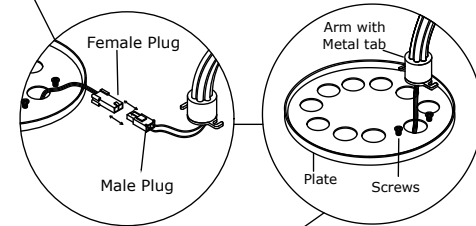

Part Number

Part Numbers

- A. (2)-Wire Connector
- B. (1)-Mounting Bar
- C. (1)-Lock Washer
- D. (1)-Hex Nut
- E. (1)-Nipple
- F. (1)-Canopy (W5"xH1")-XSN1110CHCAN5IN
- G. (1)-Collar Ring
- H. (1)-Collar Loop
- I. (1)-Chain (5mmx72")-XSN1112CHCHA5MM
- J. (1)-Center Column Kit Loop
- K. (1)-Center Column Kit
 - Top Bobeche ; Ø4",4pin,24mm center hole. -XSN1110CHBOB4IN
 - Top Bowl ; Ø6" ; 12pin,13mm center hole. -XSN1112TODISH6IN
 - Glass Vase x2pcs ; H8"
 - Glass ball ; Ø5"
 - Glass Vase ; H8"
 - Metal Cover ; H1.5"
- L. (12)-PVC candle sleeve ; Ø7/8",H4 1/8". -XSN1110CDL4IN
- M. (12)-Bobeche ; Ø5" ; 5 pin, 24mm center hole. -XSN1110CHBOB5IN
- N. (6)-14" Arms with holder-XSN500CHARM14IN
- O. (6)-8" Arms with holder-XSN529CHARM8IN
- P. (12)-Male Plug
- Q. (12)-Female Plug
- R. (1)-Distributor Box with Female Plug ; Ø5 1/2"
- S. (1)-Bottom Bowl ; Ø6",8 pin,13mm center hole. -XSN1110CHBODISH6IN
- T. (3)-Metal washer
- U. (1)-Bottom Bobeche; Ø4",4 pin,24mm center hole. -XSN1110CHBOB4PN
- V. (1)-Finial-XSN1110CHF1N