

# Cisco Business 142ACM Mesh Extender



Thank you for choosing the Cisco Business 142ACM Mesh Extender.  
The mesh extender can be used to expand coverage of your existing Cisco Business Wireless Network.  
This Quick Start Guide will get you up and running in no time.

## What's in the Box

- Cisco Business 142ACM Mesh Extender
- Quick Start Guide
- Technical Support Contact List
- Pointer Card China RoHS
- Compliance Information (for EU SKU only)

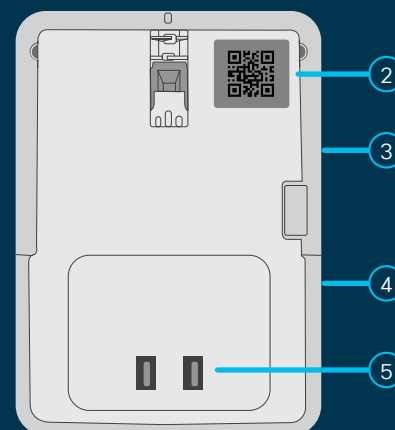
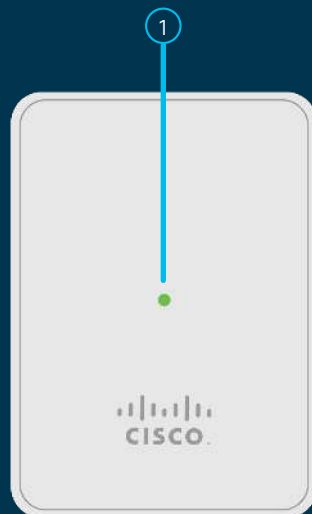

## Product Features

- ① Status LED
- ② QR Code
- ③ Mode Button (on side)
- ④ Kensington Lock (on side)
- ⑤ AC Plug (will vary by country)

**START  
HERE**

## First, You'll Need...

- An active Internet connection
- An operational/configured CBW Primary AP (140AC/145AC/240AC) with Mesh enabled.
- A router (to act as your DHCP server)
- A QR code reader (if not using the Cisco Business Mobile app). Free QR code readers are available for Android and Apple products.



Printed in China PRC



## Get Connected

- 1 Plug the mesh extender into a power outlet and the mesh extender will begin initial boot up. During this process the LED will cycle through red, amber and green. This is normal.

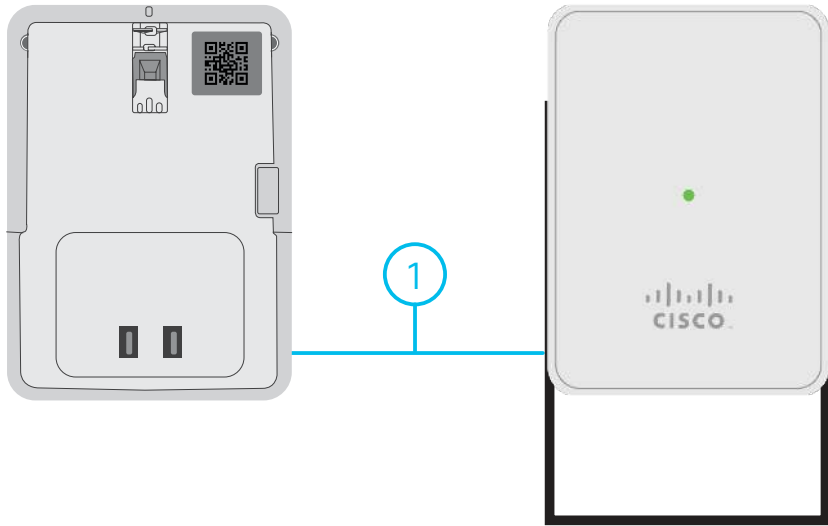

- 2 If you have downloaded the app, open it and follow the installation instructions. If you don't have the app, proceed to "**Get Configured**" and follow the instructions.  
If you are not using the app, obtain the MAC address by scanning the QR code on the back of the mesh extender. Once you have the MAC address proceed to "**Get Configured**".

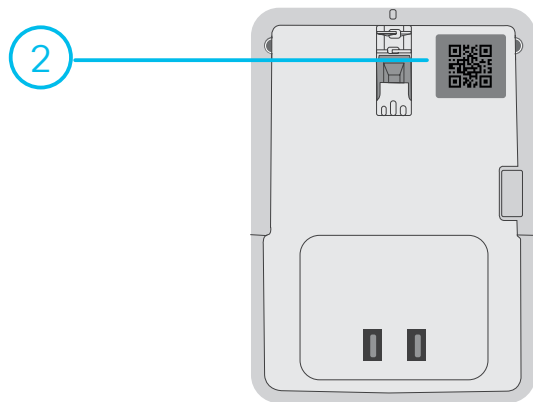

## Get Configured

### Download the Cisco Business Mobile app



No computer is needed for setup, just use the app on your mobile phone or tablet.

Scan the QR code here to download the app or go to [cisco.com/go/cbapp](https://cisco.com/go/cbapp) and follow the installation instructions.



### Alternative: Web UI (Internet Browser) Setup

If you do not wish to use the Cisco Business Mobile app you can use the Web UI for setup. These instructions can be found online in the Web UI Setup Document.

To download the instructions see the "**Get Support**" section below.

### Mounting and Grounding

Cisco Business mesh extenders can be mounted in several configurations.

Mounting instructions are located in the Administration Guide, see the "**Get Support**" section below.

## Get Support



For Cisco support and additional product documentation, including the Web UI Setup document and the Administration Guide view:

<https://cisco.com/go/cbw142acm>