



# REVOLUTION™ *PET* PRO



USER GUIDE

Models 1986, 2007G, 2007H, 2007Q



More of a video person? Look for this icon and go online for an instructional how-to video at

[www.BISSELL.com](http://www.BISSELL.com)

# IMPORTANT SAFETY INSTRUCTIONS

## READ ALL INSTRUCTIONS BEFORE USING YOUR DEEP CLEANER.

When using an electrical appliance, basic precautions should be observed, including the following:

### **WARNING**

#### TO REDUCE THE RISK OF FIRE, ELECTRIC SHOCK OR INJURY:

- » Connect to a properly grounded outlet only. See grounding instructions. Do not modify the 3-prong grounded plug.
- » Do not leave appliance when it is plugged in. Unplug from outlet when not in use and before servicing.
- » Do not expose to rain. Store indoors.
- » Do not allow to be used as a toy. Close attention is necessary when used by or near children.
- » Do not use for any purpose other than described in this user guide. Use only manufacturer's recommended attachments.
- » Do not use with damaged cord or plug. If appliance is not working as it should, or has been dropped, damaged, left outdoors, or dropped into water, have it repaired at an authorized service center.
- » Do not pull or carry by cord, use cord as a handle, close a door on cord, or pull cord around sharp edges or corners.
- » Do not run appliance over cord. Keep cord away from heated surfaces.
- » Do not unplug by pulling on cord. To unplug, grasp the plug, not the cord.
- » Do not handle plug or appliance with wet hands.
- » Do not put any object into openings. Do not use with any opening blocked; keep openings free of dust, lint, hair, and anything that may reduce air flow.
- » Keep hair, loose clothing, fingers, and all parts of body away from openings and moving parts of the appliance and its accessories.
- » Turn OFF all controls before plugging or unplugging appliance.
- » Use extra care when cleaning on stairs.
- » Do not use to pick up flammable or combustible materials (lighter fluid, gasoline, kerosene, etc.) or use in areas where they may be present.
- » Do not use appliance in an enclosed space filled with vapors given off by oil-based paint, paint thinner, some moth-proofing substances, flammable dust, or other explosive or toxic vapors.
- » Do not use to pick up toxic material (chlorine bleach, ammonia, drain cleaner, etc.).
- » Do not pick up anything that is burning or smoking, such as cigarettes, matches or hot ashes.
- » Do not pick up hard or sharp objects such as glass, nails, screws, coins, etc.
- » Do not use without filters in place.
- » Use only BISSELL® cleaning formulas intended for use with this appliance to prevent internal component damage. See the "Cleaning Formulas" section of this guide.
- » Do not immerse. Use only on surfaces moistened by the cleaning process.
- » Keep appliance on a level surface.
- » Do not carry the appliance while in use.
- » Always install float before any wet pick-up operation.
- » Unplug before connecting TurboBrush® Tool.
- » Plastic film can be dangerous. To avoid danger of suffocation, keep away from children.
- » Liquid must not be directed towards equipment containing electrical components.
- » Use only the type and amount of liquids specified under the operations section of this guide.

## SAVE THESE INSTRUCTIONS FOR FUTURE USE

This model is for household use only. Commercial use of this unit voids the manufacturer's warranty.

### **WARNING**

Improper connection of the equipment-grounding conductor can result in a risk of electrical shock. Check with a qualified electrician or service person if you aren't sure if the outlet is properly grounded. **DO NOT MODIFY THE PLUG.** If it will not fit the outlet, have a proper outlet installed by a qualified electrician. This appliance is designed for use on a nominal 120-volt circuit, and has a grounding attachment plug that looks like the plug in the illustration. Make certain that the appliance is connected to an outlet having the same configuration as the plug. No plug adapter should be used with this appliance.

#### **GROUNDING INSTRUCTIONS**

This appliance must be connected to a grounded wiring system. If it should malfunction or break down, grounding provides a safe path of least resistance for electrical current, reducing the risk of electrical shock. The cord for this appliance has an equipment-grounding conductor and a grounding plug. It must only be plugged into an outlet that is properly installed and grounded in accordance with all local codes and ordinances.

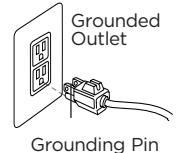

## IMPORTANT INFORMATION

- » If your appliance has a motorized Brush Roll, do not leave machine running in the same spot without the handle fully upright.

# Thanks for buying a BISSELL® carpet cleaner!

We love to clean and we're excited to share one of our innovative products with you. We want your carpet cleaner to work like new for the years to come, so this guide has tips on how to use, maintain and, if there's a problem, troubleshoot.

Your carpet cleaner needs a little assembly before getting to work, so flip to the "Assembly" section and let's get started!

## What's in the Box?

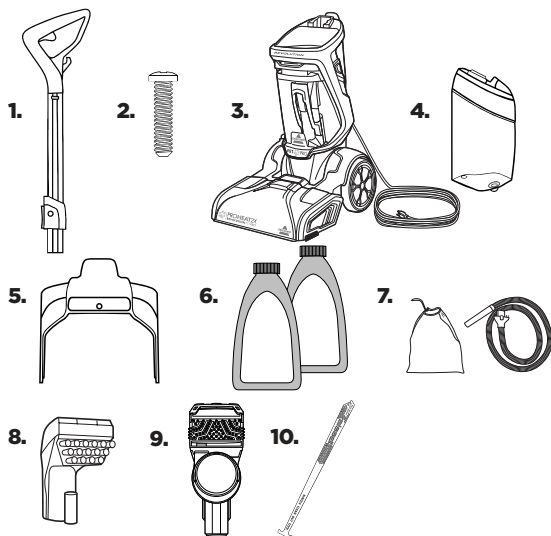

1. Upper Handle
2. 1 Screw attached to Upper Handle
3. Base with Dirty Water Tank
4. Clean Water Tank
5. Carry Handle
6. BISSELL Trial-Size Formulas
7. Accessory Bag & Hose
8. Tough Stain Tool
9. 2-in-1 Pet Upholstery Tool
10. Nozzle Clean Out Tool

**NOTE:** Standard accessories may vary by model. To identify what should be included with your purchase, please refer to the "Carton Contents" list located on the carton top flap.

Safety Instructions.....	2
Product View.....	4
Assembly.....	5
Cleaning Formulas.....	6
Operations.....	7-12
Maintenance.....	13-17

Troubleshooting.....	18
Warranty.....	19
Service.....	19
Product Registration.....	20
Parts & Supplies.....	20

# Product View

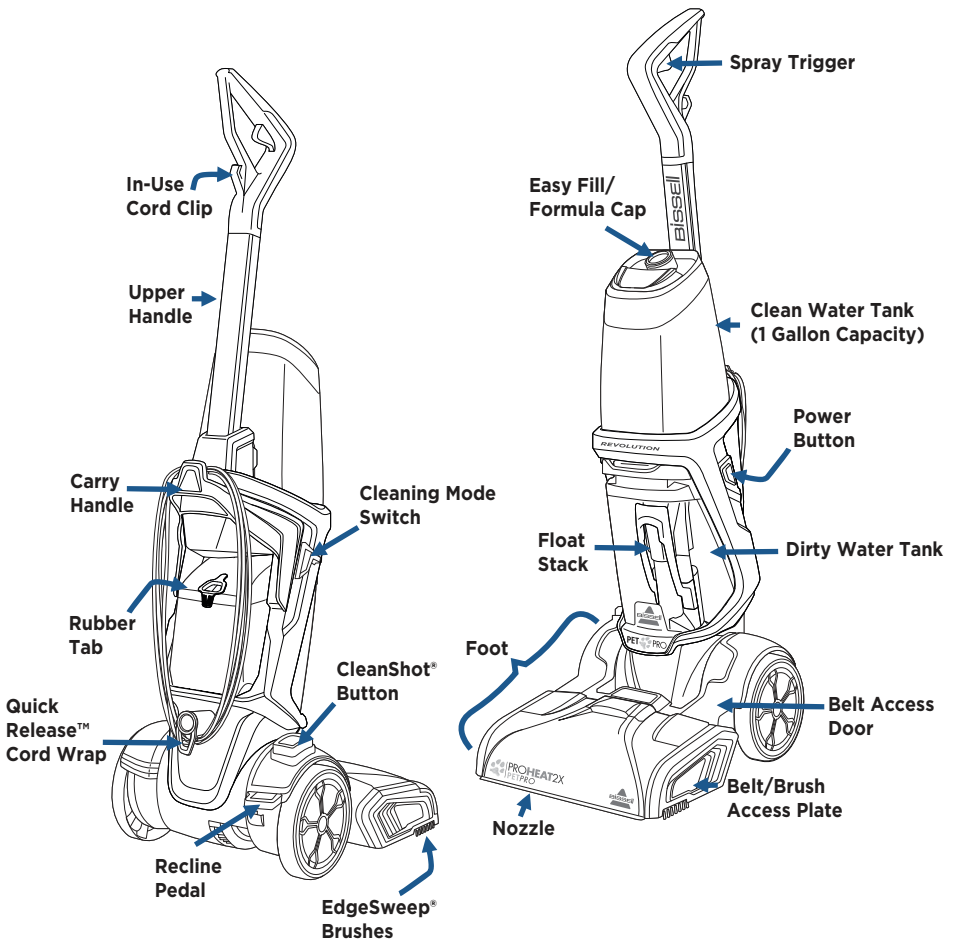

## Tips Before Carpet Cleaning

- If cleaning an entire room, consider moving your furniture to another area.
- Use a dry vacuum cleaner over area before using your carpet cleaner.
- Pretreat stains with BISSELL® Pretreat to improve performance on coffee stains and ground-in dirt.

# Assembly

## **WARNING**

Do not plug in your deep cleaner until you are familiar with all instructions and operating procedures.

A Phillips-head screwdriver is required for assembly in Step 3.  

1

First, insert the (aluminum) Upper Handle at the top of the base until you hear a “click”. Do NOT put the clean tank on the machine until Step 5.

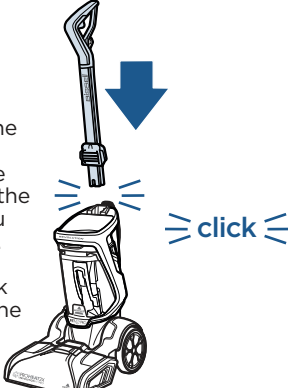

2

Next, align the Carry Handle with the slots on either side of the base (behind the Power Button and Cleaning Mode Switch). The Carry Handle will “click” into place.

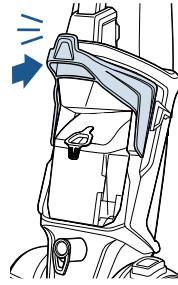

3

Use a Phillips-head screwdriver to secure the screw (found taped to Upper Handle) into the Carry Handle.

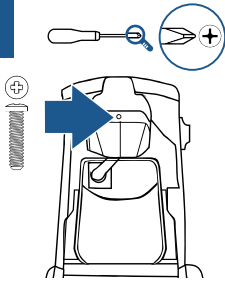

4

Wrap the cord around the Carry Handle and Quick Release™ Cord Wrap hook.

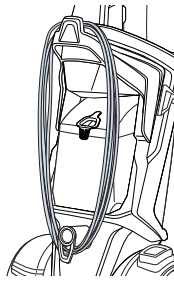

5

Side View

At the bottom of the Upper Handle, align the Clean Water Tank with the grooves and slide the tank into place.

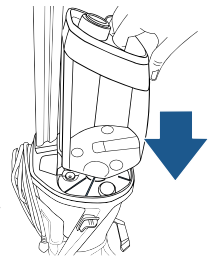

# Cleaning Formula

## ⚠️ WARNING

- » To reduce the risk of fire and electric shock due to internal component damage, use only BISSELL® cleaning formula intended for use with this machine.
- » To reduce the risk of fire and electric shock when cleaning a hard floor, the BISSELL Hard Floor Tool must be used and is only to be used with BISSELL Hard Floor Solutions formula intended for use with this appliance. Visit BISSELL.com to purchase.

Keep plenty of BISSELL® cleaning formulas on hand so you can clean whenever it fits your schedule.

**NOTE:** Always use genuine BISSELL cleaning formulas for portable carpet and upholstery cleaners in your machine.

				
<b>Clean + Refresh</b> Powerful cleaning and odor elimination with Febreze freshness	<b>PET Stain &amp; Odor</b> Removes tough pet stains  <i>Includes StainProtect™ to protect against future stains</i>	<b>PRO MAX Clean + Protect</b> Our most powerful formula for tough, ground-in dirt & stains  <i>Includes StainProtect to protect against future stains</i>	<b>PET PRO OXY Urine Eliminator</b> Our best formula for pet urine stains & odors  <i>Includes StainProtect to protect against future stains</i>	<b>Pet Stain &amp; Odor + Antibacterial</b> Cleans and controls odor causing bacteria  <i>Use with easy fill SYSTEM™</i>

Certain trademarks used under license from The Procter & Gamble Company or its affiliates.

## Pretreat

Pretreat spots and stains to improve carpet cleaning performance.

		
<b>PET Stain Pretreat</b> Permanently removes tough pet stains & odors with Enzyme Action	<b>PET PRO OXY Stain Destroyer</b> Permanently removes tough pet stains & odors with OXY	<b>PET Pretreat + Sanitize</b> Penetrates to sanitize and loosen tough stains

## Boost

Add Boost carpet cleaning formula enhancers to any formula to increase its effectiveness.

		
<b>OXY Boost</b> Removes old, set-in stains permanently	<b>PRO MAX Boost</b> Add to formula for 2X deep cleaning power	<b>PET OXY Boost</b> Removes pet stains and odors permanently

# Filling Your Clean Water Tank

1

The Clean Water Tank is at the top of the machine.

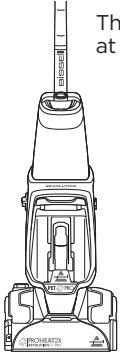

**Clean Water Tank  
(1 Gallon)**



**Dirty Water Tank**

2

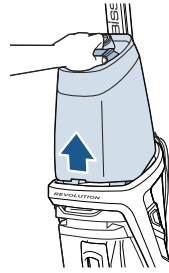

Lift the tank straight up to remove from the machine.

3



**With Formula:**

Unscrew the cap from the tank. Add hot tap water to the water fill line. Next, reference the chart below for formula amounts to add to the tank. Twist cap back into place.

4

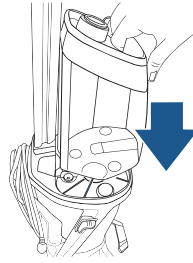

At the bottom of the Upper Handle, align the tank with the grooves and slide the tank into place.

**FORMULA FILLING INSTRUCTIONS**

**DEEP CLEAN & MAX CLEAN MODE**

**EXPRESS CLEAN MODE**

BISSELL® Formulas

- Fill water to the **Water Fill Line** next to the **DEEP/MAX CLEAN** mode on the Clean Water Tank.
- Fill tank with 2.5 oz of formula.
- For extra cleaning power, fill the formula until it reaches the "Maximum Formula" line (5 oz). **Note:** When using BISSELL PRO MAX Clean + Protect Formula, only add 2.5 oz to the tank.

- Fill water to the **Water Fill Line** next to the **EXPRESS CLEAN** mode on the Clean Tank.
- Fill tank with 1.25 oz of formula.

BISSELL Boost Formula Enhancers (Optional)

Add 2 oz of BISSELL Boost formula to the tank for enhanced cleaning results.

Add 1 oz of BISSELL Boost formula to the tank for enhanced cleaning results.

**NOTE:** Fill with hot (140°F/60°C MAX) tap water and add the appropriate BISSELL formula. **DO NOT USE BOILING WATER. DO NOT HEAT WATER OR TANK IN MICROWAVE.** Do not substitute BISSELL Formula cleaning formula with other household cleaning products.

# Filling Your Clean Water Tank:

For Future Use if selecting Antibacterial Formula with EasyFill

1

The Clean Water Tank is at the top of the machine.



Clean Water Tank  
(1 Gallon)

Dirty Water Tank

2

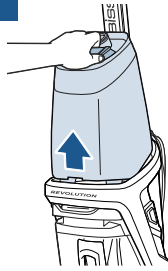

Lift the tank straight up to remove from the machine.

3

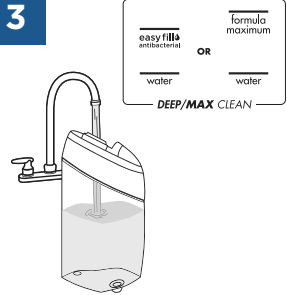

Unscrew the cap from the tank. Add hot tap water to the water fill line.

4

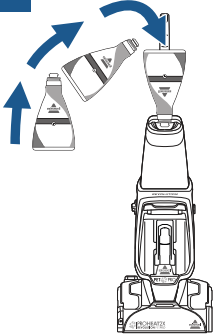

After filling the tank with hot tap water, twist the yellow cap back onto the tank.

Firmly insert the full-size formula bottle into the cap on the tank and squeeze until formula reaches the EasyFill line.

**With Trial Size Antibacterial Formula:** Pour into the clean tank up to the EasyFill line. Twist cap back on to tank.

5

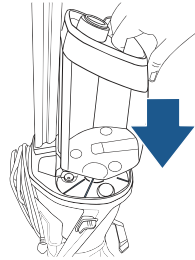

At the bottom of the Upper Handle, align the tank with the grooves and slide the tank into place.

## A few notes about filling the Clean Water Tank:

- Fill with hot (140°F/60°C MAX) tap water and add the appropriate BISSELL® formula. **DO NOT USE BOILING WATER. DO NOT HEAT WATER OR TANK IN MICROWAVE.**
- When using BISSELL Antibacterial formula: Only fill your Clean Water Tank with the recommended amount of water and formula to achieve antibacterial benefits.

**NOTICE:** BISSELL Antibacterial formula is only for BISSELL machines with EasyFill System.

**NOTICE:** Do not overwet carpet. Be careful not to run over loose objects or edges of area rugs. Stalling the brush may result in premature belt failure.

# Cleaning Your Carpet

1

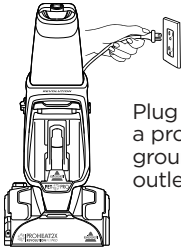

Plug into a properly grounded outlet.

2

## Select cleaning mode:

**Max Clean** - Provides a heavy cleaning for your dirtiest carpets. After cleaning, it's estimated the carpets will need 8 hours to dry.

**Deep Clean** - Delivers a deep clean to your carpet.

**Express Clean** - Provides a lighter clean with about a 30-minute dry time. *Recommended Cleaning Pace: 12 inches per second.*

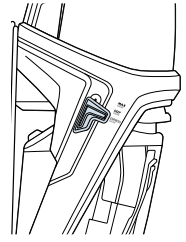

3

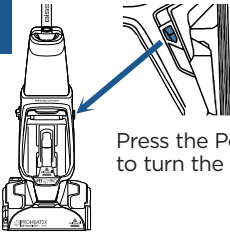

Press the Power Button to turn the machine ON.

4

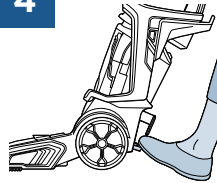

To recline your machine for use, press the Recline Pedal with your foot.

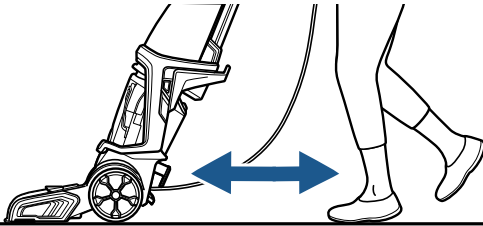

**NOTICE:** To prevent damage to Berber carpets, avoid repeated strokes in the same area.

## Express Clean Mode:

1. Press the Spray Trigger to apply solution while making **2 wet passes** - 1 forward and 1 back.

2. Release the trigger.

3. Make **2 dry passes** - 1 forward, 1 back to suck up the dirty solution. **(Do not hold down the trigger for this step.)**

*Recommended Cleaning Pace: 12 inches per second*

## Max Clean & Deep Clean Modes:

1. Press the Spray Trigger to apply solution while making **2 slow wet passes** - 1 forward and 1 back.

2. Release the trigger.

3. Make **2 slow dry passes** - 1 forward and 1 back to suck up the dirty solution. **(Do not hold down the trigger for this step.)**

## Antibacterial Cleaning (Deep Clean Mode Only)

1. Press the Spray Trigger to apply solution while making **3 slow wet passes** - 1 forward, 1 back, and 1 forward again.

2. Release the trigger.

3. Make **1 slow dry pass** back, to suck up the dirty solution. **(Do not hold down the trigger for this step.)**

- Max Clean Mode is intended for your dirtiest carpeted areas. Please note that your carpets will need an estimated 8 hours to dry. To expedite the drying process, place a fan in the room or near the carpet.
- In Express Clean Mode, the Dirty Water Tank will not get as full as when cleaning with Deep or Max Clean Mode.
- It is common to refill the Clean Water Tank and empty the Dirty Water Tank multiple times throughout your cleaning process. Room size and the speed at which you clean are both factors that affect how often the tank may need to be refilled and/or emptied.

# Cleaning with Hose & Tool

1

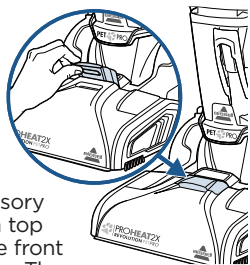

Lift the Accessory Hose Door on top of Foot on the front of the machine. The door flips toward the machine to open.

- Keep hair, loose clothing, fingers, and all parts of body away from openings and moving parts. Brush Roll continues to rotate when in the upright position.
- Brush Roll continues to turn while product is turned ON and handle is in upright position. To avoid damage to carpet, rugs, furniture, and flooring, avoid tipping cleaner or setting it on furniture, fringed area rugs, or carpeted stairs during tool use.
- The Brush Roll remains on while cleaning with the hose and tool. Do not allow cleaner to sit in one location for an extended period of time, as damage to floor can result.

2 Insert the hose and snap into place. Be sure the red-colored hose release clip is facing out, away from machine.

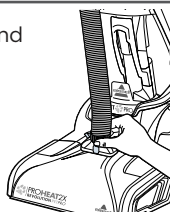

4

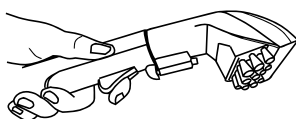

Press the Spray Trigger to spray the soiled area, then slowly move tool back and forth over the area.

Release the trigger to suck up the dirty solution. Work in small sections until the area is clean.

When finished cleaning, turn the machine ON to suction up warm clean water to rinse the inside of the hose and tool. Detach the hose and tool and close the Accessory Hose Door. Let the hose and tool air dry before storing.

3

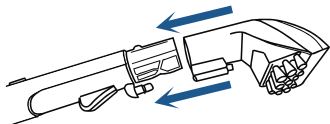

Attach the tool to the end of the hose. (Tools may vary by model.) Press the Power Button to turn machine ON.

**NOTE:** If using the **Deep Reach Tool** or **Pet Stain Tool** be sure the needles of the tool are pressed down into the carpet so the spray gets into the carpet fibers.

# Cleaning with CleanShot®

1



Press the CleanShot Button with your foot. The window of the button will be green and show an "I" symbol when it is on.

2

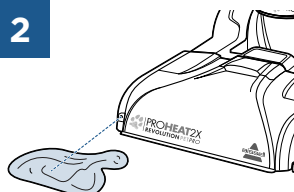

Spray will continue until you turn it off. To turn CleanShot off, press the button with your foot. The window of the button will be red and show an "O" symbol when it is off.

Completely cover the stain with CleanShot spray. Allow the stain to soak. To extract, maneuver the Foot of the machine over the stain to scrub and remove. Continue to clean over the area multiple times for extra scrubbing and suction.

# Using the 2-in-1 Pet Upholstery Tool

Make sure your Clean Water Tank has water & formula to use the tool in wet mode.

1

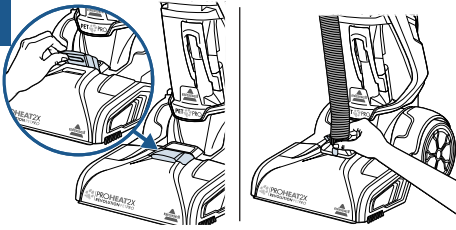

Follow hose plug-in instructions from steps 1 & 2 on page 10.

2

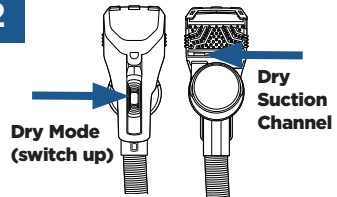

Attach the tool and select dry mode to first pick up dry debris and pet hair. The suction will be at the lower part of the tool, near the dry cup.

**DRY MODE NOTE:** Use a “raking” motion to clean. Start with the tool farthest away and rake in small increments as you bring the tool toward you. The rubber nubs will help attract hair to the suction channel.

3 Empty the cup when it fills with hair and debris.

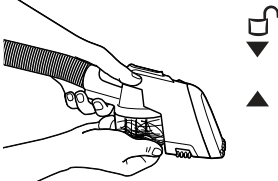

Turn OFF the machine. Hold the cup and twist counter-clockwise line up the arrow with the unlock symbol and remove.

4



Take off the cup to empty hair and debris.

5



Remove hair that may wrap around the filter.

6

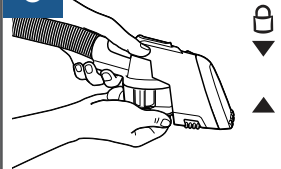

To reattach the cup, line up the cup to the tool indents, and rotate clockwise. The arrow will line up with the locked icon when secured.

7

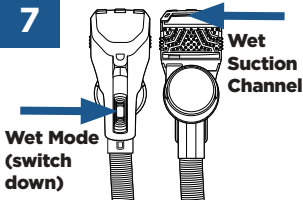

To deep clean, move the switch to wet mode. Press the trigger to spray your water and formula; use the top of the Nozzle to extract stains and odors.

8

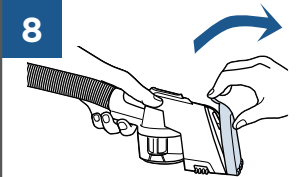

To remove any hair or trapped debris from the Nozzle, first turn OFF the machine. Pull the Nozzle tab away from the tool to remove and rinse under running water.

9

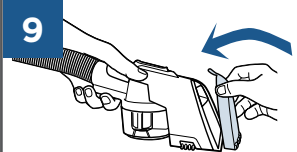

Replace on the tool by lining up the Nozzle edge and snap into place. Before storing, make sure all hair is removed from the dry cup and Nozzle has been rinsed under running water.

**WET MODE NOTE:** Start from the area farthest away. Hold the trigger down, and pull the tool toward you. Keep the tool in contact with the surface as you pull. You will see extraction through the Nozzle.

# Cleaning Area Rugs

**IMPORTANT:** Please check manufacturer's tag before cleaning area rugs for any specialized cleaning instructions. We do not recommend deep cleaning delicate, silk, wool, antique, or area rugs without a manufacturer's tag.

## **Regularly clean your high-traffic area rugs in Express Clean Mode:**

- Check the manufacturer's tag.
- Select Express Clean Mode.
- When cleaning area rugs, place the rug on a sealed surface to test for colorfastness in an inconspicuous area. Your cleaner should not be used on unsealed surfaces.
- **Important:** Keep the Foot of the deep cleaner perpendicular to the rug's edge with each cleaning pass to prevent damage.
- Recommended Cleaning Pace: 12 inches per second

# Emptying the Dirty Water Tank

## **WARNING**

To reduce the risk of fire, electric shock or injury, turn power OFF and disconnect plug from electrical outlet before performing maintenance or troubleshooting.

1

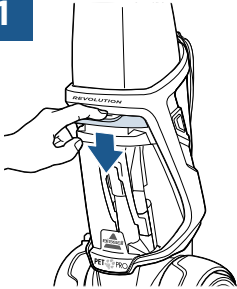

To release Dirty Water Tank, press down on the colored tank handle.

2

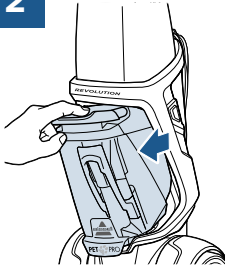

Tilt the tank slightly toward you.

3

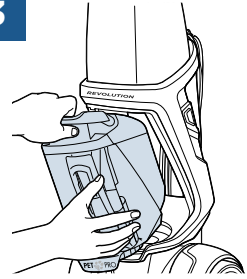

Grab the handle and tank with both hands and pull the tank up and away to remove.

4



### **For quick empty:**

Pull the Rubber Tab and tilt to pour. (Located at the corner of the top of the tank.)

When closing the Rubber Tab, make sure all edges are sealed tight.

5

Clean the red filter below the tank by wiping off any remaining dirt or debris.

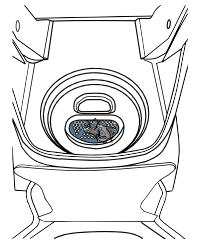

### **For final clean and**

**rinse:** Unscrew the ring at the bottom of tank.

Gently remove the float stack, rinse, and clean.

Once clean, return Float Stack into the tank by lining up the arrows so they point at each other. This is the only way the float stack will fit into the tank.

With the arrows aligned, the Float Stack should lock into place.

Return the ring and twist to lock. Water may leak if the ring is not fully tightened.

6

### **To return the tank:**

Angle the tank and insert bottom first. Then tilt the tank toward the machine and push the top in until it clicks into place.

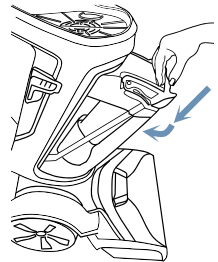

### **Did You Know?**

The Float Stack is what prevents your dirty tank from overflowing.

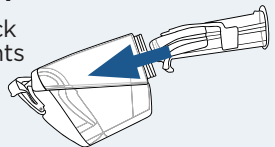

# Cleaning Machine After Use

## WARNING

To reduce the risk of electric shock, turn power OFF and disconnect plug from electrical outlet before performing maintenance or troubleshooting checks.



First, fill the Clean Water Tank with warm tap water and then empty it all to rinse. Then fill again with warm tap water and return the tank to the machine. Twist cap back on tightly.

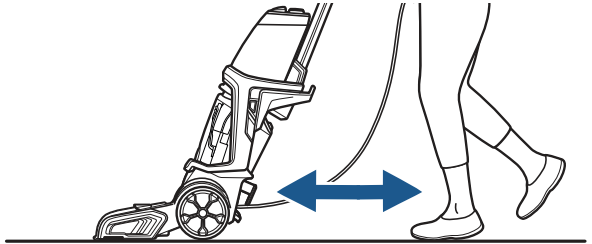

**To flush and rinse the machine:** Turn the machine ON and press the trigger for 15 seconds while making back and forth passes on a section of carpet.

Finally, release the trigger and extract the water. See [page 15](#) to clean the Dirty Water Tank from the water that was just extracted.

# Storing Your Machine

When finished using the product, wrap cord around cord wrap for storage. Store your machine in a protected, dry area.

# Cleaning the Brush Roll & Nozzle

## WARNING

To reduce the risk of electric shock, turn power OFF and disconnect plug from electrical outlet before performing maintenance or troubleshooting checks.

**NOTE:** Be sure to clean the Brush Rolls and Nozzle before storing your machine. Follow these steps if your Nozzle becomes clogged with hair or debris.

1

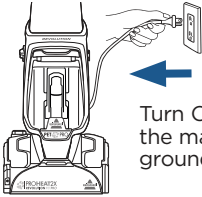

Turn OFF and unplug the machine from the grounded outlet.

2

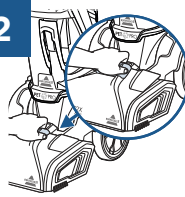

Remove the Nozzle from the Foot: scoop and grip the Accessory Hose Door. Pull up to remove the Nozzle.

3

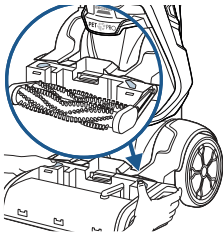

Next, remove the next layer, the Brush Roll cover, to reveal the Brush Rolls. Press on the two release buttons and lift straight up.

4



At this point, the Nozzle and Brush Roll cover can be rinsed under running water and the Nozzle Clean Out Tool can be inserted to unclog hair or debris.

5

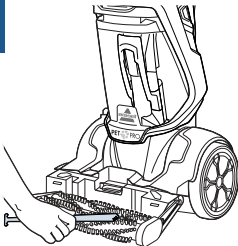

Use the comb to brush out the debris or hair from the Brush Rolls.

6

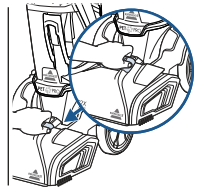
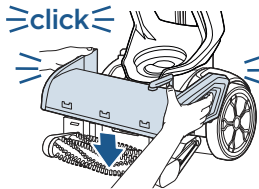

When finished, return the Brush Roll cover by pushing it straight down. You will hear a “click” from each push button when the cover is pushed down into place. Line up the Nozzle from the edge near the floor and rotate to snap back into place.

**NOTICE:** To reduce the risk of a leaking condition, do not store unit where freezing may occur. Damage to internal components may result.

# Replacing the Belts & Brush Rolls

## ⚠️ WARNING

To reduce the risk of electric shock, turn power OFF and disconnect plug from electrical outlet before performing maintenance or troubleshooting checks.

**What you will need: 1 Phillips-head screwdriver & 1 flathead screwdriver**

1

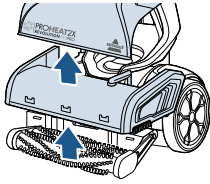

While the machine is upright, unplug the machine and remove both tanks. Remove the Nozzle and Brush Roll cover (see steps in Brush Roll & Nozzle Care). Press the Recline Pedal and lay the machine on its back.

2

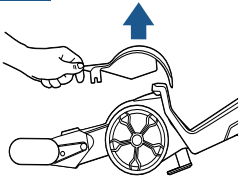

Use a flathead screwdriver and press it into the slot at the back **and then front** of the Belt Access Door. Lift to remove the door.

3

Turn the machine on its side and use a Phillips-head screwdriver to remove the screw just underneath the wheel. Slide the wheel down to remove.

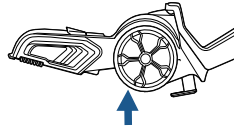

4

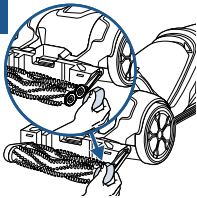

Lay the machine back down on its back. Use a Phillips-head screwdriver to remove the screw on the Brush Roll end cap.

5

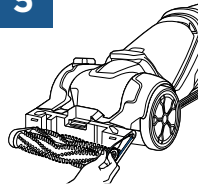

If the gear belt is broken, gently remove it. If you are replacing your Brush Rolls, gently remove the belt.

6

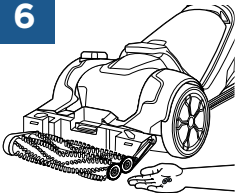

There are washers at the ends of the Brush Rolls, be careful that these do not fall off or get lost.

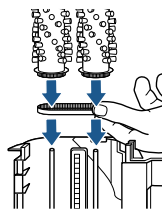

Align Brush Rolls with belt at other end. To ensure alignment, hold the end of one Brush Roll and twist. The other Brush Roll rotates with it. **Check that washers are in place.** Reassemble the belt and end cap, securing with screws you removed.

**NOTE:** To replace Brush Rolls, remove them from the metal posts and replace. Make sure the metal post goes completely through the end of the Brush Roll. The bristles should be aligned in a 'V' pattern as pictured.

# Replacing the Belts & Brush Rolls (cont.)

7

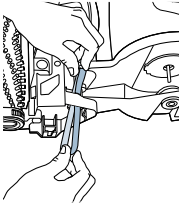

If the flat belt is broken, gently remove the belt. If it needs replacing for any reason, the gear belt should already be removed before removing the flat belt. Rotate the machine back to its side. Feed the new flat belt through the opening so that it wraps around the red pulley.

8

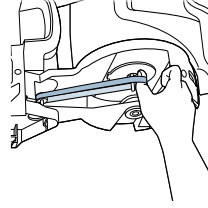

Keep it wrapped on the red pulley and adjust the machine so it is laying on its back again. Use your thumb to stretch the flat belt back to wrap around the metal axle.

9

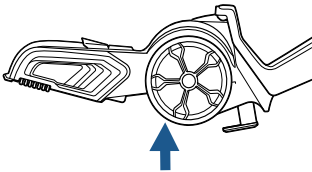

## Resecure the Wheel and Belt Access Door:

Slide the wheel up back into the slot and secure with the screw that was removed.

10

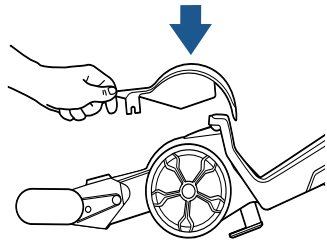

Snap the Belt Access Door back down into place.

**NOTE:** See **Step 6 on page 15** for how to put the Brush Roll Cover and Nozzle back in place.

**NOTE:** Other maintenance or service not included in this user guide should be performed by an authorized service representative.

# Troubleshooting

## **WARNING**

To reduce the risk of electric shock, turn power OFF and disconnect plug from electrical outlet before performing maintenance or troubleshooting checks.

Problem	Possible causes	Remedies
<b>Reduced or No Spray Through Foot of Machine</b>	Clean Water Tank may be empty.	Refill tank.
	Clean Water Tank may not be seated completely.	Turn power OFF. Remove and reseat tank.
<b>No Spray Through Hose &amp; Tool</b>	The hose to your machine is not primed or may have lost prime.	<ol style="list-style-type: none"> <li>1. With the machine OFF and unplugged, remove Nozzle from the Foot. Place a ballpoint pen in the black cylinder next to the screw. When water bubbles up, remove the pen. Reassemble the Nozzle and hose.</li> <li>2. Hold end of hose below water level in tank to prime.</li> <li>3. With the Clean Water Tank full of water, the machine OFF and reclined, press the CleanShot button ON and wait for the CleanShot to drain for a few seconds; This will re-prime the machine.</li> </ol>
	Clean Water Tank may be empty.	Refill the Clean Water Tank.
	Clean Water Tank may not be seated properly.	Turn power OFF. Remove and reseat the tank.
<b>No Spray Through CleanShot®</b>	Clean Water Tank may be empty.	Refill the tank.
	Clean Water Tank may not be seated properly.	Turn power OFF. Remove and reseat the tank.
	The machine is not reclined.	Press the Recline Pedal and bring handle down to recline the machine.
	Pump may have lost prime.	With the machine OFF and unplugged, remove the Nozzle from the Foot. Place a ballpoint pen in the black cylinder next to the screw. When water bubbles up, remove the pen. Reassemble the nozzle before cleaning again.
<b>CleanShot Continues Spray When Machine is OFF</b>	CleanShot button is not in the off position.	Press the CleanShot button to turn it off. The button window will show the color red and a "O" symbol when it is in the off position.
<b>Loss of Suction Power</b>	Dirty Water Tank may not be seated properly.	Pick up tank and reseat so it fits in the unit 
	Dirty Water Tank has picked up max amount of dirty water and reached full line.	Empty tank.
	Rubber Tab on Dirty Water Tank is not sealed tight.	Check the Rubber Tab on the Dirty Water Tank and press firmly on all edges to secure it tightly (see step 4 on page 13 for detail).
	Accessory Hose Door may not be closed tightly in place.	Check the Accessory Hose Door and make sure it is closed tightly – it should be locked into place.
	Nozzle may be clogged from pet hair or debris.	Use the Nozzle Clean Out Tool and follow steps on page 15 for "Cleaning the Brush Rolls and Nozzle".
	Brush Roll cover not fully snapped into place.	Remove the Nozzle and Brush Roll cover. Follow step 6 from page 15 and make sure you hear both buttons click into place.
<b>No Power</b>	Cleaning Mode Switch mistaken for Power Button.	Press the red Power Button on the left side of the machine to turn the machine ON.
	Outlet may not be active.	Try plugging in a different device that uses a grounded outlet to test for power from the outlet.
<b>Leaking Tank</b>	Tank may have been over-filled.	<ol style="list-style-type: none"> <li>1. Make sure your tank has the water and formula that you've prepared.</li> <li>2. With the cap twisted ON tightly, hold your tank at an angle, over a sink or drain, so any extra water can pour out of the space.</li> <li>3. Wipe the tank dry with a cloth.</li> </ol>
	Water may be caught in space between the tank and the tank's handle.	

# Warranty

This warranty gives you specific legal rights, and you may also have other rights which may vary from state to state. If you need additional instruction regarding this warranty or have questions regarding what it may cover, please contact BISSELL Consumer Care by E-mail or telephone as described below.

It may be necessary to obtain some of your personal information, such as a mailing address, to fulfill terms of this warranty. Any personal data will be handled pursuant to BISSELL's Privacy Policy, which can be found online at [www.BISSELL.com/privacy-policy](http://www.BISSELL.com/privacy-policy).

## Limited Five-Year Warranty

Subject to the **\*Exceptions and Exclusions from the Terms of the Limited Warranty**, upon receipt of the product BISSELL will repair or replace (with new, refurbished, lightly used, or remanufactured components or products), at BISSELL's option, free of charge from the date of purchase by the original purchaser, for five years, any defective or malfunctioning part.

See information below on "If your BISSELL product should require service".

This warranty applies to product used for personal, and not commercial or rental, service. This warranty does not apply to fans or routine maintenance components

such as filters, belts or brushes. Damage or malfunction caused by negligence, abuse, neglect, unauthorized repair, or any other use not in accordance with the user guide is not covered. This warranty will only be valid if the product is used in the same country in which it was sold.

BISSELL is not liable for incidental or consequential damages of any nature associated with the use of this product. BISSELL's liability will not exceed the purchase price of the product.

**Some states do not allow the exclusion or limitation of incidental or consequential damages, so the above limitation or exclusion may not apply to you.**

## \*Exceptions and Exclusions from the Terms of the Limited Warranty

This warranty is exclusive and in lieu of any other warranties, either oral or written. Any implied warranties, which may arise by operation of law, including the implied warranties of merchantability and fitness for a particular purpose, are limited to the five-year duration from the date of purchase as described above.

Some states do not allow limitations on how long an implied warranty lasts, so the above limitation may not apply to you.

**NOTE:** Please keep your original sales receipt. It provides proof of date of purchase in the event of a warranty claim.

# Service

## Please do not return this product to the store.

Other maintenance or service not included in the manual should be performed by an authorized service representative.

## If your BISSELL® product should require service:

Contact BISSELL Consumer Care to locate a BISSELL Authorized Service Center in your area. If you need information about repairs or replacement parts, or if you have questions about your warranty, contact BISSELL Consumer Care.

### Website:

[www.BISSELL.com/service-centers](http://www.BISSELL.com/service-centers)

### E-mail:

[www.BISSELL.com/email-us](mailto:www.BISSELL.com/email-us)

### Call:

BISSELL Consumer Care  
1-800-237-7691

## Register your product today!

Registering is quick, easy and offers you benefits over the lifetime of your product. You'll receive:

### **BISSELL® Rewards Points**

Automatically earn points for discounts and free shipping on future purchases.

### **Faster Service**

Supplying your information now saves you time should you need to contact us with questions regarding your product.

### **Product Support Reminders and Alerts**

We'll contact you with any important product maintenance reminders and alerts.

### **Special Promotions**

Optional: Register your email to receive notice of offers, contests, cleaning tips, and more!

**Visit [BISSELL.com/registration](http://BISSELL.com/registration)!**

## Parts & Supplies

**For Parts and Supplies, go to [www.BISSELL.com](http://www.BISSELL.com)** and enter your model number in the search field.

## We're Waggin' Our Tails!

BISSELL® proudly supports BISSELL Pet Foundation® and its mission to help save homeless pets. When you buy a BISSELL product, you help save pets, too. We're proud to design products that help make pet messes, odors and pet homelessness disappear.

Visit **[BISSELLsavespets.com](http://BISSELLsavespets.com)** to learn more.



Love your **BISSELL®** product?

Don't keep it a secret.  
Let us, and millions of others, know what you think!  
Leave your star-rating on [BISSELL.com](http://BISSELL.com)

**[www.BISSELL.com](http://www.BISSELL.com)**