

# BEAUTURAL Electric Spin Scrubber



Please read this manual carefully before using and keep it for future reference.

Customer Service US: ushelp@1byonebros.com  
CA: cahelp@1byonebros.com

## Safety Instructions

- To ensure safety and maintain the high quality of the product, we recommend that you read and follow the instructions carefully.
1. This appliance is only for household use, not for commercial or industrial use.
  2. Do not submerge the handle in water or other liquid.
  3. Please close the cover after charging to avoid water entering to cause the short circuit.
  4. Please check whether there are any missing parts after receiving the product.
  5. When changing accessories, please make sure to turn off the machine first.
  6. Please make sure that the scrubber is well-assembled before use.
  7. Keep the hair, cloth or other parts of your body away from the brush head to avoid convolving.
  8. It is recommended to rest the machine after working for 30 minutes.
  9. Always store the unit indoors.
  10. Do not store or use the appliance close to high temperatures.
  11. Do not incinerate the battery. It may explode in a fire.
  12. To protect against the risk of electric shock, do not put the battery charger in water or other liquid. Do not charge the battery if it is wet or shows signs of corrosion. Do not place or store the appliance where it can fall or be pulled into a tub or sink.
  13. This product is not a toy. Close supervision is required when any appliance is used by or near children. Store it out of reach of children.
  14. This appliance can be used by children aged from 8 years and above and persons with reduced physical, sensory or mental capabilities or lack of experience and knowledge if they have been given supervision or instruction concerning use of the appliance in a safe way and understand the hazards involved. Children shall not play with the appliance. Cleaning and user maintenance shall not be made by children without supervision.
  15. If the charge cord is damaged, it must be replaced by the manufacturer or its service agent or similarly qualified person in order to avoid a hazard.
  16. Do not abuse the cord. Do not carry the charger by the cord or yank the cord to disconnect.
  17. Please keep the power cord plug and hands dry when charging to avoid the risk of electric shock.
  18. Do not operate the appliance with a damaged cord or plug, or after the appliance malfunctions or is dropped or damaged in any manner.
  19. Do not disassemble, repair or modify internal parts by yourself, please contact customer support if you have quality problems.

1

## Product Description

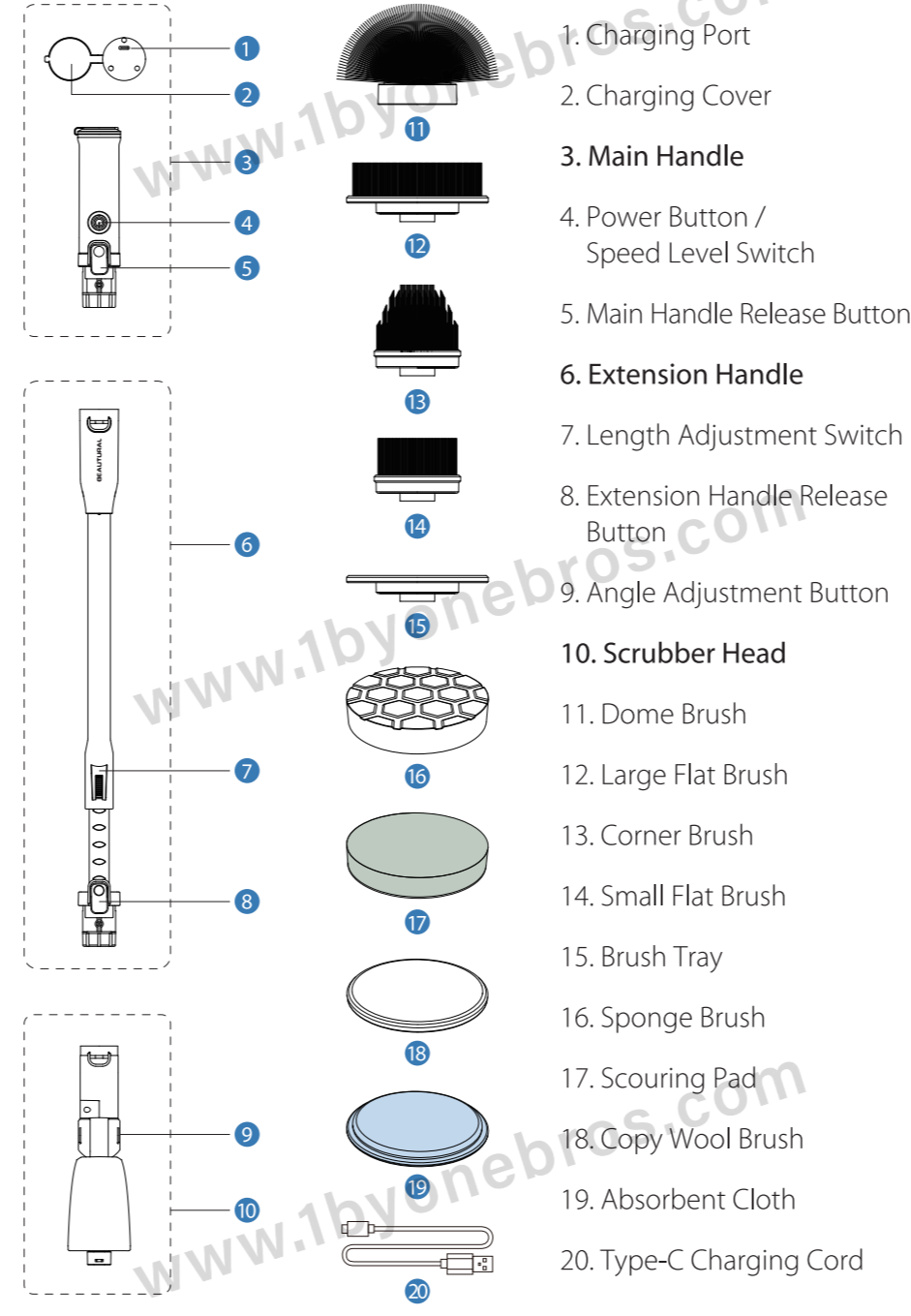

2

## Installation Instructions

**Caution:** Please ensure that the unit is turned off when not in use or when assembling any components. Make sure all parts are well-installed before use.

- **Assembly without the Extension Handle**  
Connect the main handle to the scrubber head until you hear a "click".

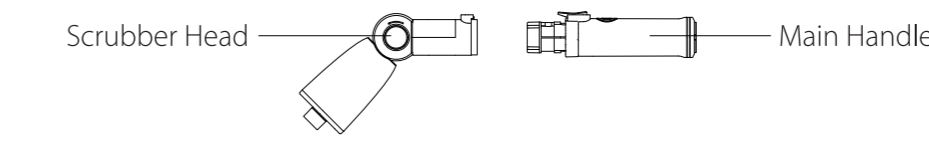

- **Assembly with the Extension Handle**  
Connect the extension handle to the scrubber head until you hear a "click". Next, connect the main handle to the extension handle.

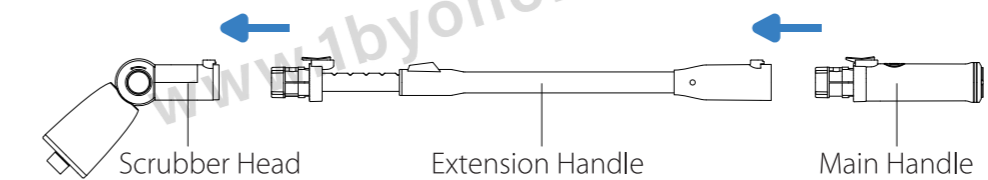

- **How to Disassemble the Handle**  
To remove the main handle and the extension handle, simply press the release button and pull the handle out.

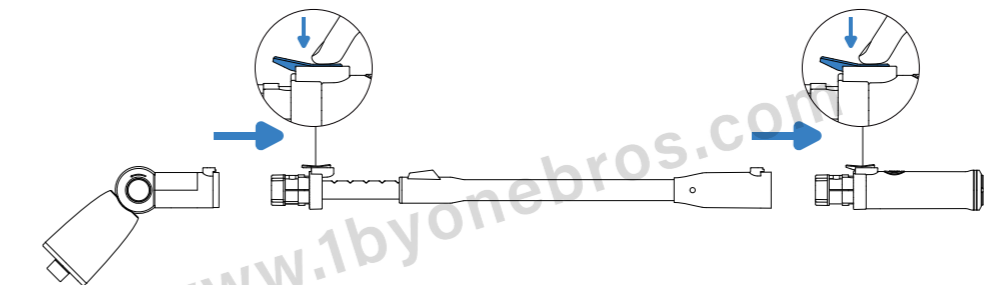

3

- **Brush Head Assembly**
  1. To install the brush head, hold the scrubber head with one hand, align the snaps at the joints, and press the selected brush firmly into place. To remove it, hold the base of the brush head and pull outward.
  2. When using the detachable brush, press the side with the Velcro towards the tray.

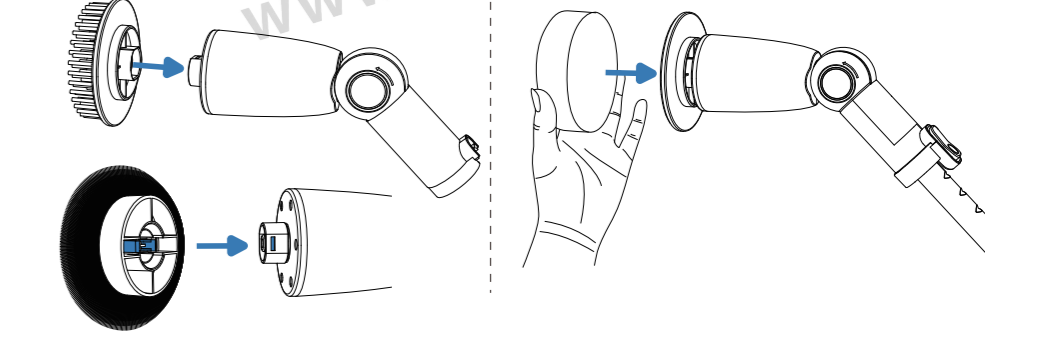

- **How to Adjust the Angle of the Scrubber Head**  
The scrubber head can be adjusted to 3 different angles at your convenience. Press and hold the buttons on both sides simultaneously, then rotate the head to the desired position.

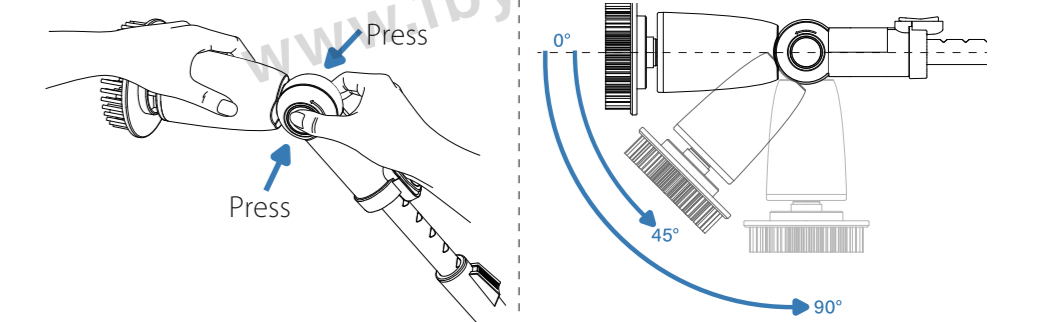

- **How to Adjust the Extension Handle Length**  
Push the switch with one hand and pull the extension rod out to different positions of the grooves.

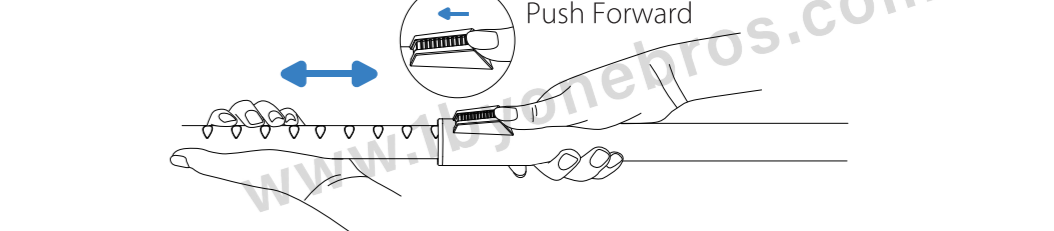

4

## Charging Instructions

1. Open the charging cover and insert the type-C charging cable. Next, connect to an adapter and plug in an indoor power outlet. Close the charging cover when charging is finished.

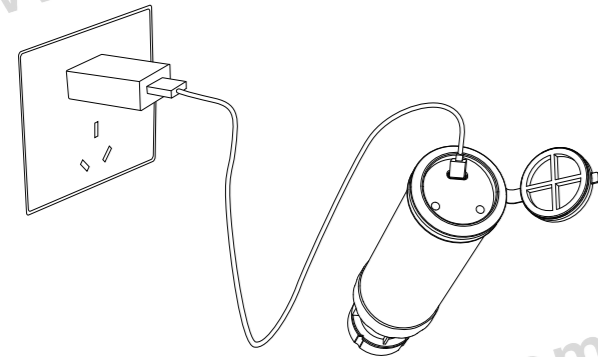

- Notes:**
1. Please fully charge the product before the first use. Keep your hands and machine surface dry when charging.
  2. In order to extend the battery life, please avoid consecutive charging exceeding 12 hours.
  3. The adapter is not included with this product. Charge only with UL/GS or equivalent safety-approved adapters with the specification of 5V/2A. Using a 5V/1A adapter will increase the charging time.

## Button Instructions

1. Press and hold the power button for 1 second to turn on or turn off the scrubber.
2. After the unit is turned on, press the power button to switch between the high-level and low-level speeds.

Power Indicator	
Charging	Green Light Flashing
Fully Charged	Steady Green Light
Low Battery	Red Light Flashing Fast
Low-Level Speed	Steady Green Light
High-Level Speed	Steady Blue Light

5

## Suggestions for Use of Accessories

This product comes with 8 replaceable multi-functional brush heads. Choose the appropriate brush attachment according to the cleaning task.

1. **Dome Brush**  
Suitable for cleaning curved areas like bathtubs, toilets, and sinks.
2. **Large Flat Brush**  
Suitable for cleaning large, flat surfaces, like floors, carpets, walls, and other dirty cleaning.
3. **Corner Brush**  
Suitable for cleaning corners, article corners, tile gaps, wheel hubs and other tight places.
4. **Small Flat Brush**  
Suitable for cleaning smaller flat areas such as showers, countertops, stove tops, and sinks.
5. **Sponge Brush**  
Suitable for cleaning more delicate surfaces and removal of subtle stains, oil stains and water stains, such as the surface of tea tables, glass, and car surfaces.
6. **Scouring Pad**  
Suitable for the surface of heavy oil pollution cleaning, such as gas cookers, kitchen ventilators, kitchenware and other kitchen utensils, need to be used with no corrosive cleaner.
7. **Copy Wool Brush**  
Suitable for cleaning and polishing paint, leather and other easily damaged surfaces, such as car seats, sofas, furniture and other precious goods.
8. **Absorbent Cloth**  
Suitable for cleaning windows and wood floors. Typically used for wiping and absorbing after scrubbing.

6

## Cleaning Tips

1. For a better cleaning effect, it is recommended to use the brush with detergent (such as Mold & Mildew Remover, Water Strain Remover, Oven Cleaner, Bleach Cleaner, and All Purpose Cleaner).
2. For removing stubborn stains, please soak stains in water and detergent for a while, and then use the scrubber to clean.
3. Small scratches may occur when cleaning the surface of stainless steel, polished resin, artificial marble, wood, etc., always test on a small, inconspicuous area before using it on a larger area.
4. Use rubber gloves and keep proper eye protection to avoid contact from splashing of soaps or detergents on skin or eyes while the brush head is spinning and when brushes are removed or attached.
5. Keep the hair, cloth or other parts of your body away from the brush head to avoid convolving.

## Product Cleaning and Storage

**Handle Part:** Gently wipe the handle of the scrubber with a wrung soft cloth.

**Brush Head:** Disassemble the brush head and immerse it in the water to clean. Clean it with neutral detergent if it is difficult to clean.

**Suggestion for Storage:** Store the scrubber in a ventilated and shaded place. Avoid placing it in a wet place or being exposed to strong sunlight.

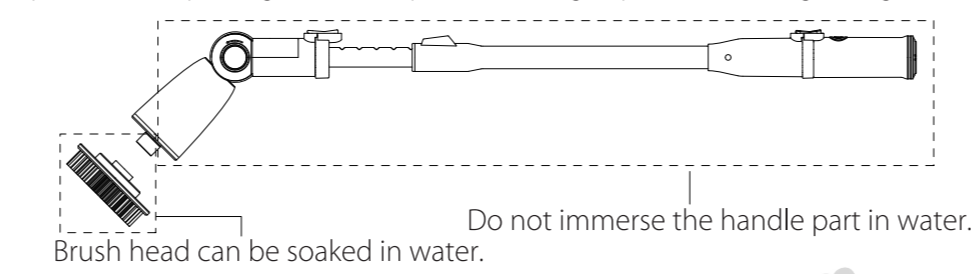

- Notes:**
1. Avoid submerging the motor or any electrical components in water. If the scrubber accidentally submerged in water or water gets into the "Charging Port", shake out the liquid and air dry the machine for 24 hours at least.
  2. Do not use metal such as steel wire or abrasive cleaner or corrosive liquid (e.g. gasoline or acetone) to clean brush heads and fuselage surfaces.
  3. Be sure to check that the charging port is sealed when cleaning.
  4. Dry the surface in time after cleaning to ensure the product is dry.

7

## Troubleshooting

**The product does not turn on, it stops working or stops spinning. Please check if:**

- 1) The battery has run out of power. Please recharge and check if the indicator light is on.
- 2) The scrubber head or extension handle is not installed in place. Please make sure all parts are tightly connected. Disassemble the extension handle, and connect the scrubber head to the main handle, check if the brush head rotates.
- 3) The motor head is clogged. After turning the product off, remove the brush head, check and clean the motor head.
- 4) Too much pressure was applied on the brush head while using. The principle of the product is to make the brush rotate and scrub. Do not apply too much force, just soak the stain and then use the scrubber with proper force.
- 5) Water got inside the product/The internal circuit is abnormal/The power switch is broken. Please contact the customer service.

**The indicator does not light while charging / It won't charge to full normally. Please check if:**

- 1) The charging connection is loose. Please make sure the power cord and the adapter are firmly inserted.
- 2) The charging outlet has no power or the adapter is broken.
- 3) The charging module is broken. Please contact the customer service.

**Slow spin speed. Please check if:**

- 1) Too much pressure is applied or the floor is rough. The friction increases, and the spin speed will moderately slow down. Use the scrubber with proper force.
- 2) The motor head is clogged. After turning the product off, remove the brush head, check and clean the motor head.
- 3) The motor is abnormal. Please contact the customer service.

**The product can not be turned off. Please check if:**

- 1) The internal circuit is abnormal/The power switch is broken. Please contact the customer service.

8

The working time is short(not as long as the description). Please check if:

- 1) The product is not fully charged. Please fully charge the product before use.
- 2) Too much pressure was applied on the brush head while using. The greater the pressing force, the higher the friction, and the more the battery power consumption. It is recommended to moderately reduce the pressing force.
- 3) The floor is rough. Rough floors also increase friction, which will moderately reduce the working time. Use the product to scrub a smooth surface (like tile, or bathtub) and check if the working time recovers.
- 4) The machine stops running due to the clogged motor head. After turning the product off, remove the brush head, check and clean the motor head.

## Specifications

Model: 1-JU61NA01, HK036  
Rated Voltage: 7.4V  
Input: 5V=2A  
Battery Capacity: 2000mAh  
Charging Time: Approx. 3 hours  
Note: Design and specifications are subject to change without notice.

The appliance's packaging is made from environmentally friendly material and can be disposed of at your local recycling plant.

## Brand Owner

1byone Products Inc.  
1230 E Belmont Street,  
Ontario, CA, USA 91761  
Customer Service: +1 909-391-3888  
www.1byonebros.com  
Made in China

## Customer Service

UNITED STATES	Phone: +1 909-391-3888 (Mon-Fri 9:00am - 5:00pm PST) Email: ushelp@1byonebros.com
CANADA	Email: cahelp@1byonebros.com

9