

# BEAUTURAL

## Professional Manicure & Pedicure Kit



1byone Products Inc.  
1230 E Belmont Street, Ontario, CA, USA 91761  
Customer Service: +1 909-391-3888  
www.1byonebros.com

Made in China

Instruction Manual

## Introduction

Thank you for purchasing Beautural Professional Manicure & Pedicure Kit. This instruction manual contains important information about safety, usage, and disposal. Use the product as described and keep this manual for future reference. If you sell this kit or pass it on, also give this manual to the new owner.

## Warning

- The Professional Manicure & Pedicure Kit is intended for household and commercial use.
- This kit can be used by children aged from 8 years and above and persons with reduced physical, sensory or mental capabilities or lack of experience and knowledge if they have been given supervision or instruction concerning use of the kit in a safe way and understand the hazards involved. Children shall not play with the kit. Cleaning and user maintenance shall not be made by children without supervision.
- Do not use this kit if it shows signs of damage or does not function properly. In these cases, contact Customer Services.

## Safety Instructions

- A considerable amount of heat may be generated on the skin during use.
- When using the manicure & pedicure device, carefully check its results during the treatment process. This is particularly advisable in the case of users suffering from diabetes, as they are less sensitive to pain and are liable to become injured. Always use with extreme care. If in doubt, ask your physician.
- This manicure & pedicure kit must be used only for the purpose for which it has been developed, and in the manner described in the instructions for use. Any improper use can be dangerous.
- Switch off the manicure & pedicure device immediately in the event of defects or malfunctions.

- Only qualified technicians can perform repairs on electrical devices. Improper repairs may subject users to considerable danger.
- Use the manicure & pedicure device only with the accessories provided.
- Never leave the manicure & pedicure device unattended when it is in operation.
- Keep the manicure & pedicure kit away from sources of heat.
- Do not use the manicure & pedicure device under a cover, blanket, pillow, etc.
- Do not use the manicure & pedicure device longer than 15 minutes at a time. After use, let the manicure & pedicure device rest for 15 minutes before restarting it again to allow the motor to cool. This will prolong the manicure & pedicure device's lifespan.
- Do not use the manicure & pedicure device when bathing or showering. Do not store or keep the device in places from where it can fall into a bath or wash basin.
- Never immerse the manicure & pedicure device in water or other liquids.
- If the manicure & pedicure device drops into water, unplug it from power immediately.
- Ensure your hands are dry before handling the manicure & pedicure device.
- Do not continue to use the power adapter if it has been damaged.
- For reasons of hygiene, the manicure & pedicure kit should only be used on one individual only.

## Product Description

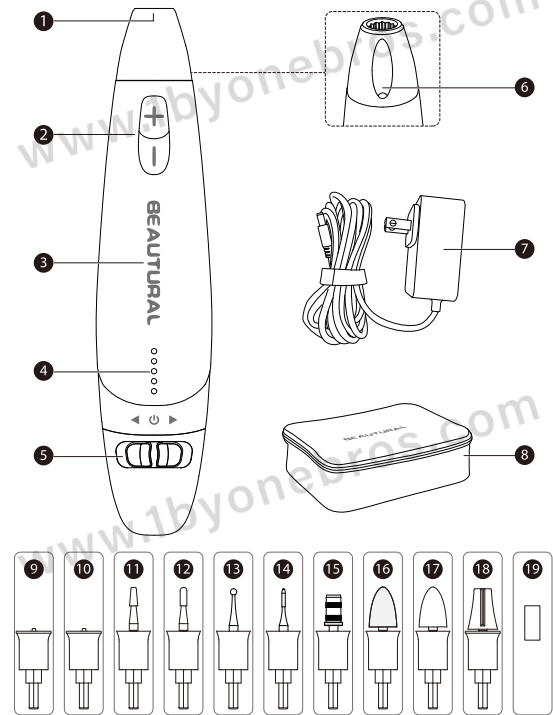

- |                            |                                |
|----------------------------|--------------------------------|
| 1. Attachment Port         | 11. Flame Milling Cutter       |
| 2. Speed Buttons "+/-"     | 12. Cylindrical Milling Cutter |
| 3. Handle                  | 13. Round Sapphire Grinder     |
| 4. Speed Indication Lights | 14. Needle-Shaped Grinder      |
| 5. On/Off/Direction Switch | 15. Mandrel                    |
| 6. LED Light               | 16. Sapphire Cone              |
| 7. Power Adapter           | 17. Felt Cone                  |
| 8. Carrying Bag            | 18. Hardened Skin Remover      |
| 9. Sapphire Disk (fine)    | 19. Sanding Band               |
| 10. Sapphire Disk (coarse) |                                |

## Included Items

- 1 x Manicure & Pedicure Device    1 x Power Adapter  
10 x Attachments                      1 x Carrying Bag  
20 x Sanding Bands                  1 x Instruction Manual

Before using the Professional Manicure & Pedicure Kit for the first time, check the package contents to ensure all parts are free of visible damage.

## Operating Instructions

1. This manicure & pedicure kit is intended only for the treatment of hands (manicure) and feet (pedicure).
2. Make sure the manicure & pedicure device is switched off before plugging into power and fitting attachments.
3. Select an attachment and push it into the top of the manicure & pedicure device. A clicking sound will be heard when the attachment has been correctly engaged. To remove, pull the attachment straight out of the device.
4. Push the switch from "⏻"(Off) to "◀" (Left, anti-clockwise rotation) or "▶" (Right, clockwise rotation) to turn the device on. The LED will light up white.
5. The two buttons marked with plus (+) and minus (-) allow the speed of rotation to be selected (15 speed levels optional). It is recommended to start the manicure & pedicure device at low speed and increase it as required. The device will start with the lowest speed setting (setting 1) the first time it is turned on after being plugged into power.
6. Do not exert heavy pressure and always guide the attachments carefully over skin and nail surfaces.
7. Move the manicure & pedicure device under light pressure in circular movements slowly over the body parts being treated.

### NOTES:

- The attachments will have a reduced effect if the skin is softened or moist. For this reason, it is not recommended to take a bath or shower immediately before using the manicure & pedicure device.
- In order to retain the skin's natural protection, do not remove too much skin from calluses. Removing too much skin may also cause calluses to grow back much harder.
- Always ensure the attachment heads can rotate freely. If they become jammed or are blocked from rotating, the device will become very hot and suffer damage.
- After every use, apply moisturizing cream to the skin parts treated.

### Important:

- Always continue checking the results of the manicure or pedicure while in progress. This is particularly important for diabetics as their hands and feet may be less sensitive.

## Attachments and Instructions

### 1. Sapphire Disk (fine)

A fine-grained sapphire disk for filing and treatment of thinner nails such as fingernails.

- Only the inner sapphire disk rotates, while the outer support is stationary, enabling precise filing of the nails without the risk of burning the surrounding skin due to the fast rotation of the disk.

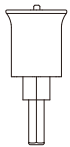

## 2. Sapphire Disk (coarse)

A coarse-grained sapphire disk for filing and treatment of thicker nails such as toenails.

- As with the fine-grained disk, only the inner sapphire disk rotates, enabling precise filing of the nails without the risk of burning the surrounding skin. Always work from the outside of the nail to the tip.

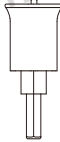

## 3. Round Sapphire Grinder

Removes corns.

- When removing a layer of skin from the corn, you will quickly penetrate deeper into the skin and could injure the periosteum.

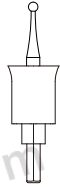

## 4. Needle-Shaped Grinder

Removes dead skin.

- This is a precision tool, so proceed cautiously when using this attachment. This attachment frees ingrown nails and cuts away parts of dead nails. Use only at low speed.

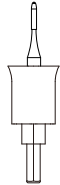

## 5. Mandrel

Holds sanding bands.

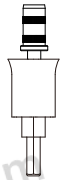

## 6. Sanding Band

Removes dry skin and foot calluses and treats nails.

- Sanding bands can be removed and discarded after a single use. Twenty single use sanding bands are included. To maintain natural skin protection, do not completely remove calluses.



## 7. Flame Milling Cutter

For removing ingrowing nails.

- Guide the flame milling cutter carefully onto the treatment area and cut away the affected nail part.



## 8. Cylindrical Milling Cutter

For grinding and smoothing thickly-grown toenail surfaces.

- Apply the milling cutter horizontally to the nail surface and remove the unwanted layer of the nail using slow circular movements. Apply light pressure.



## 9. Hardened Skin Remover

For removing large-scale and thick hardened skin or calluses on the soles and heels of the feet.

- Guide the hardened skin remover attachment over the parts of the sole and heel to be treated. Exert gentle pressure. Note that it is not recommended to remove too much skin from calluses as this may cause them to grow back much harder.



## 10. Sapphire Cone

For removing thick or large calluses on the soles and heels. This attachment is intended for large areas.

- Guide the sapphire cone over the parts of the sole and heel to be treated. Use a circular motion while applying gentle pressure. Apply moisturizing cream after every treatment. Note that it is not recommended to remove too much skin from calluses as this may cause them to grow back much harder.



## 11. Felt Cone

For both smoothing and polishing nail edges after filing and for cleaning nail surfaces after grinding.

- Polish with the felt cone using a circular motion.
- Never polish in a single place without continuous movement across the nail's surface as friction will cause a large amount of heat to develop.



## Speed Indication Lights

The manicure & pedicure device has 15 speed settings with 5 indication lights. Change rotation speed by pressing the +/- buttons.

Setting 1 - 1700RPM (1 lighted LED)

Setting 2 - 1900RPM

Setting 3 - 2100RPM

Setting 4 - 2300RPM (2 lighted LEDs)

Setting 5 - 2500RPM

Setting 6 - 2700RPM

Setting 7 - 2900RPM (3 lighted LEDs)

Setting 8 - 3100RPM

Setting 9 - 3300RPM

Setting 10 - 3500RPM (4 lighted LEDs)

Setting 11 - 3700RPM

Setting 12 - 3900RPM

Setting 13 - 4100RPM (5 lighted LEDs)

Setting 14 - 4400RPM

Setting 15 - 4700RPM

## Memory Function

When powering off the manicure & pedicure device using the On/Off switch, the last-used speed setting will be active when the device is next turned on. The last-used speed setting will be erased from memory if the device is unplugged from power and the device will use speed setting 1 (the lowest setting) when plugged back in and turned on.

## Maintenance and Care

- Before cleaning the manicure & pedicure device, always unplug it from power.
- Clean the attachments with a slightly moistened cloth. You can also moisten the cloth with mild soap to remove more stubborn dirt and grime.
- If necessary to improve hygiene, the attachments can be cleaned with a cloth or brush moistened with alcohol. Carefully dry the attachments afterwards.
- Do not drop the manicure & pedicure device.
- Make sure no water ever enters the manicure & pedicure device.
- Do not use chemical detergents or scouring agents for cleaning.
- Never immerse the manicure & pedicure kit in water or other liquids.

## Specifications

Model: 1-MR05US02

Supply Input: 100-240V~; 50/60Hz 0.5A

Supply Output: 30V  $\equiv$  0.25A; 7.5W

Rotation Speed: 1700~4700rpm ( $\pm$ 15%)



This product's packaging is made from environmentally friendly material and can be disposed of at your local recycling plant.

## Customer Service/Kundenservice

### Service Clients/Atención al cliente/Assistenza Clienti

<b>UNITED STATES</b>	Phone: +1 909-391-3888 (Mon-Fri 9:00am - 5:00pm PST) Email: ushelp@1byonebros.com
<b>CANADA</b>	Email: cahelp@1byonebros.com
<b>UNITED KINGDOM</b>	Phone: +44 158 241 2681 (Mon-Fri 9:00am - 6:00pm UTC) Email: ukhelp@1byonebros.com
<b>GERMANY/France ITALY/Spain</b>	Email: euhelp@1byonebros.com

### BRAND OWNER

1byone Products Inc.

1230 E Belmont Street, Ontario, CA, USA 91761

Customer Service: +1 909-391-3888

www.1byonebros.com